

Quad - White Bluff

VLR - 7/1/70  
NRHP - 9/15/70

02-35

Form 10-300  
(July 1969)

UNITED STATES DEPARTMENT OF THE INTERIOR  
NATIONAL PARK SERVICE

### NATIONAL REGISTER OF HISTORIC PLACES INVENTORY - NOMINATION FORM

(Type all entries - complete applicable sections)

STATE: Virginia	
COUNTY: Albemarle	
FOR NPS USE ONLY	
ENTRY NUMBER	DATE

**1. NAME**

COMMON:  
Farmington

AND/OR HISTORIC:  
Farmington

**2. LOCATION**

STREET AND NUMBER:  
.7 mi. N of Rt. 250, .9 mi. W of intersection with Rt. 250-29 Bypass.

CITY OR TOWN:  
(Charlottesville vic.)

STATE Virginia	CODE 45	COUNTY: Albemarle	CODE 003
-------------------	------------	----------------------	-------------

**3. CLASSIFICATION**

CATEGORY (Check One)	OWNERSHIP	STATUS	ACCESSIBLE TO THE PUBLIC
<input type="checkbox"/> District <input type="checkbox"/> Site <input type="checkbox"/> Object <input checked="" type="checkbox"/> Building <input type="checkbox"/> Structure	<input type="checkbox"/> Public <input checked="" type="checkbox"/> Private <input type="checkbox"/> Both	Public Acquisition: <input type="checkbox"/> In Process <input type="checkbox"/> Being Considered <input checked="" type="checkbox"/> Occupied <input type="checkbox"/> Unoccupied <input type="checkbox"/> Preservation work in progress	Yes: <input checked="" type="checkbox"/> Restricted <input type="checkbox"/> Unrestricted <input type="checkbox"/> No

PRESENT USE (Check One or More as Appropriate)

<input type="checkbox"/> Agricultural	<input type="checkbox"/> Government	<input type="checkbox"/> Park	<input type="checkbox"/> Transportation	<input type="checkbox"/> Comments
<input type="checkbox"/> Commercial	<input type="checkbox"/> Industrial	<input type="checkbox"/> Private Residence	<input checked="" type="checkbox"/> Other (Specify) Country Club	
<input type="checkbox"/> Educational	<input type="checkbox"/> Military	<input type="checkbox"/> Religious		
<input type="checkbox"/> Entertainment	<input type="checkbox"/> Museum	<input type="checkbox"/> Scientific		

**4. OWNER OF PROPERTY**

OWNER'S NAME:  
Farmington Incorporated

STREET AND NUMBER:  
Farmington Country Club

CITY OR TOWN:  
Charlottesville

STATE: Virginia	CODE 45
--------------------	------------

**5. LOCATION OF LEGAL DESCRIPTION**

COURTHOUSE, REGISTRY OF DEEDS, ETC.:  
Albemarle County Court House, Clerk's Office

STREET AND NUMBER:

CITY OR TOWN:  
Charlottesville

STATE Virginia	CODE 45
-------------------	------------

**6. REPRESENTATION IN EXISTING SURVEYS**

TITLE OF SURVEY:  
Historic American Buildings Survey

DATE OF SURVEY: 1938       Federal     State     County     Local

DEPOSITORY FOR SURVEY RECORDS:  
Library of Congress

STREET AND NUMBER:

CITY OR TOWN:  
Washington

STATE: District of Columbia	CODE 08
--------------------------------	------------

SEE INSTRUCTIONS

STATE: Virginia
COUNTY: Albemarle
ENTRY NUMBER
DATE

FOR NPS USE ONLY

## DESCRIPTION

CONDITION	(Check One)					
	<input type="checkbox"/> Excellent	<input checked="" type="checkbox"/> Good	<input type="checkbox"/> Fair	<input type="checkbox"/> Deteriorated	<input type="checkbox"/> Ruins	<input type="checkbox"/> Unexposed
	(Check One)			(Check One)		
	<input checked="" type="checkbox"/> Altered	<input type="checkbox"/> Unaltered	<input type="checkbox"/> Moved	<input checked="" type="checkbox"/> Original Site		

DESCRIBE THE PRESENT AND ORIGINAL (If known) PHYSICAL APPEARANCE

Although obscured by later additions, the earliest or pre-Revolutionary section of Farmington is still discernable. As originally built it was a simple two-story, three-bay brick house with a full stone basement. The house had a side hall plan with the hall across the east end. The fireplaces for the two rooms on the west were served by two interior end chimneys. The partition between the two first floor rooms has been removed, but the original stairway in the southeast corner of the hall survives. It is difficult to determine what other original woodwork remains in the early section as it has been redecorated several times.

On the exterior, only the north wall remains unobscured by later additions. The west wall is covered by the modern clubhouse additions, while the Jefferson addition is attached to the east wall. From the earliest times the south door led onto a long gallery which connected the service wing to the house. Much of the service wing was substantially rebuilt as a result of tornado damage suffered in the late 1950's.

Jefferson's octagonal addition on the east features a two-story tetrastyle pedimented Tuscan portico across all but the octagonal ends of the addition's facade. There are several discrepancies between Jefferson's drawing for Farmington and the existing work. Jefferson drew no stone lintels over the triple-hung windows, nor did he indicate keystones around the circular windows. Also, Jefferson showed the full entablature extending around the octagonal ends, whereas on the building only the modillion cornice does. His proposed broad steps with podiums are substituted by much narrower steps.

On the interior, Jefferson planned the addition to be divided into two rooms of unequal size. In 1818 Judith Cabell Rives, niece of Mrs. George Divers, paid a visit to Farmington and described the interior of the addition in its original form. "The two large rooms he Divers added in front to gratify the architectural fancy of his friend, Mr. Jefferson, who had planned them. They were octagonal in form, extending in height through two stories of the other part of the house; with immense windows and doors and deep cornices of carved wood, in which hieroglyphical figures of griffins and other mysterious devices largely predominated."

In 1852-54, the Jefferson section was greatly altered by the insertion of an extra floor level, and by the addition of a central hall. Following the conversion of Farmington into a country club in 1929, the floor was removed and the entire interior of the addition was made into one large two-story room. Since that time many extra rooms have been added to the west end of the house. These additions include a public dining room, reception room, ballroom and gallery as well as guest rooms above. The additions are architecturally sympathetic and are only obvious from the north. The rural setting of the house has been preserved through the retention of open spaces around it, and from the house fine views of the countryside and mountains are still obtainable.

SEE INSTRUCTIONS

## SIGNIFICANCE

PERIOD (Check One or More as Appropriate)

- Pre-Columbian       16th Century       18th Century       20th Century  
 15th Century       17th Century       19th Century

SPECIFIC DATE(S) (If Applicable and Known)

AREAS OF SIGNIFICANCE (Check One or More as Appropriate)

- |  |                                       |   |  |
|--|---------------------------------------|---|--|
| <input type="checkbox"/> Aboriginal              | <input type="checkbox"/> Education    | <input type="checkbox"/> Political      | <input type="checkbox"/> Urban Planning  |
| <input type="checkbox"/> Prehistoric             | <input type="checkbox"/> Engineering  | <input type="checkbox"/> Religion/Phi-  | <input type="checkbox"/> Other (Specify) |
| <input type="checkbox"/> Historic                | <input type="checkbox"/> Industry     | losophy                                 | _____                                    |
| <input type="checkbox"/> Agriculture             | <input type="checkbox"/> Invention    | <input type="checkbox"/> Science        | _____                                    |
| <input checked="" type="checkbox"/> Architecture | <input type="checkbox"/> Landscape    | <input type="checkbox"/> Sculpture      | _____                                    |
| <input type="checkbox"/> Art                     | <input type="checkbox"/> Architecture | <input type="checkbox"/> Social/Human-  | _____                                    |
| <input type="checkbox"/> Commerce                | <input type="checkbox"/> Literature   | itarian                                 | _____                                    |
| <input type="checkbox"/> Communications          | <input type="checkbox"/> Military     | <input type="checkbox"/> Theater        | _____                                    |
| <input type="checkbox"/> Conservation            | <input type="checkbox"/> Music        | <input type="checkbox"/> Transportation | _____                                    |

STATEMENT OF SIGNIFICANCE

The Farmington property was originally included in a 1753-acre tract for which Michael Holland of Hanover County received Letters of Patent in 1744 from George II. In 1758 the land was acquired by Francis Jerdone who erected the simple two-story brick farmhouse which serves as the nucleus of the present clubhouse. The construction date of Jerdone's house is uncertain, but it is thought that it is prior to 1780. In 1785, Jerdone sold the property to George Divers, son-in-law of Dr. Thomas Walker of Castle Hill. In 1802 Divers asked his friend Thomas Jefferson to design an addition to the original farmhouse. Jefferson's proposals included not only a large octagonal addition but alterations to the existing house as well. His original drawings survive in the Massachusetts Historical Society and include the elevation of the addition, a plan, and a drawing identified by Fiske Kimball as a rejected study. From the description of Farmington in Judith Cabell Rives' autobiography, it is apparent that the addition was executed basically as planned, but it is uncertain to what extent the original house was altered.

According to Kimball, Farmington was built at the point in Jefferson's architectural career when he had resolved most of the practical and functional problems of his domestic style and was becoming more preoccupied with formal design. In the Farmington addition Jefferson was "pursuing his attempts to canvass the possible combinations of the octagon with the rectangle, a pursuit which furnished the motives for so many of his later designs, and of his unidentified studies."

After Divers' death in 1830, Farmington passed to his nephew, Issac White. Subsequent to White's sale of the property ten years later, Farmington passed through several owners until 1927, when the last private owner, Mrs. Maggie L. Wood, sold the house and 305 acres to Farmington Incorporated. It was then that the property was converted into a country club and that the house received the first of several additions.

Although extensively enlarged, the building retains its octagonal front addition, designed by Jefferson, and therefore an important survival of Jefferson's architectural talent. Since becoming a country club, Farmington has enjoyed a position of being one of the most prestigious clubs of its type in Virginia if not on the Eastern Seaboard.

SEE INSTRUCTIONS

MAJOR BIBLIOGRAPHICAL REFERENCES

Frary, I. T., Thomas Jefferson, Architect and Builder. Richmond: Garrett and Massie, 1950. 3rd ed.  
 Goyert, Philip, Jr., Farmington, unpublished manuscript in University of Virginia architectural school library.  
 Kimball, Fiske, Thomas Jefferson, Architect. New York: Da Capo Press, 1968.  
 Rawlings, Mary, Ante-Bellum Albemarle, 1935.

10. GEOGRAPHICAL DATA

LATITUDE AND LONGITUDE COORDINATES DEFINING A RECTANGLE LOCATING THE PROPERTY			O R	LATITUDE AND LONGITUDE COORDINATES DEFINING THE CENTER POINT OF A PROPERTY OF LESS THAN TEN ACRES		
CORNER	LATITUDE	LONGITUDE		LATITUDE	LONGITUDE	
NW	Degrees Minutes Seconds 38 ° 03 ' 48 "	Degrees Minutes Seconds 78 ° 32 ' 40 "		Degrees Minutes Seconds ° ' "	Degrees Minutes Seconds ° ' "	
NE	38 ° 03 ' 48 "	78 ° 32 ' 25 "				
SE	38 ° 03 ' 41 "	78 ° 32 ' 25 "				
SW	38 ° 03 ' 41 "	78 ° 32 ' 40 "				

APPROXIMATE ACREAGE OF NOMINATED PROPERTY: 10 acres

LIST ALL STATES AND COUNTIES FOR PROPERTIES OVERLAPPING STATE OR COUNTY BOUNDARIES

STATE:	CODE	COUNTY	CODE

11. FORM PREPARED BY

NAME AND TITLE:  
Staff, Virginia Historic Landmarks Commission, James W. Moody, Jr., Director  
 ORGANIZATION: Virginia Historic Landmarks Commission DATE: May 13, 1970  
 STREET AND NUMBER:  
Room 1116, Ninth Street State Office Building  
 CITY OR TOWN: Richmond STATE: Virginia CODE: 45

12. STATE LIAISON OFFICER CERTIFICATION

NATIONAL REGISTER VERIFICATION

As the designated State Liaison Officer for the National Historic Preservation Act of 1966 (Public Law 89-665), I hereby nominate this property for inclusion in the National Register and certify that it has been evaluated according to the criteria and procedures set forth by the National Park Service. The recommended level of significance of this nomination is:

National  State  Local

Name \_\_\_\_\_

Dr. Edward P. Alexander, Chairman  
 Title Virginia Historic Landmarks Commission

Date \_\_\_\_\_

I hereby certify that this property is included in the National Register.

\_\_\_\_\_  
 Chief, Office of Archeology and Historic Preservation

Date \_\_\_\_\_

ATTEST: \_\_\_\_\_

\_\_\_\_\_  
 Keeper of The National Register

Date \_\_\_\_\_

SEE INSTRUCTIONS

183

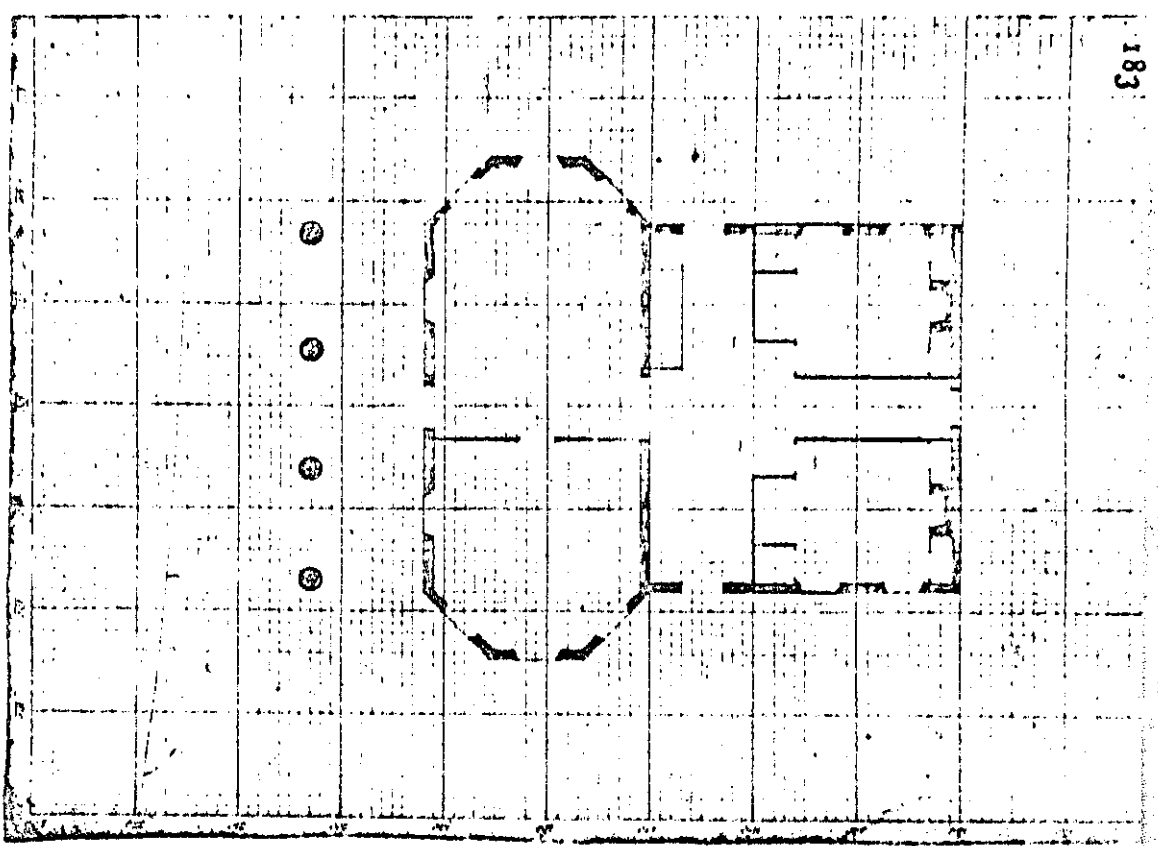

Thomas Jefferson's plan for the addition to Farmington

182

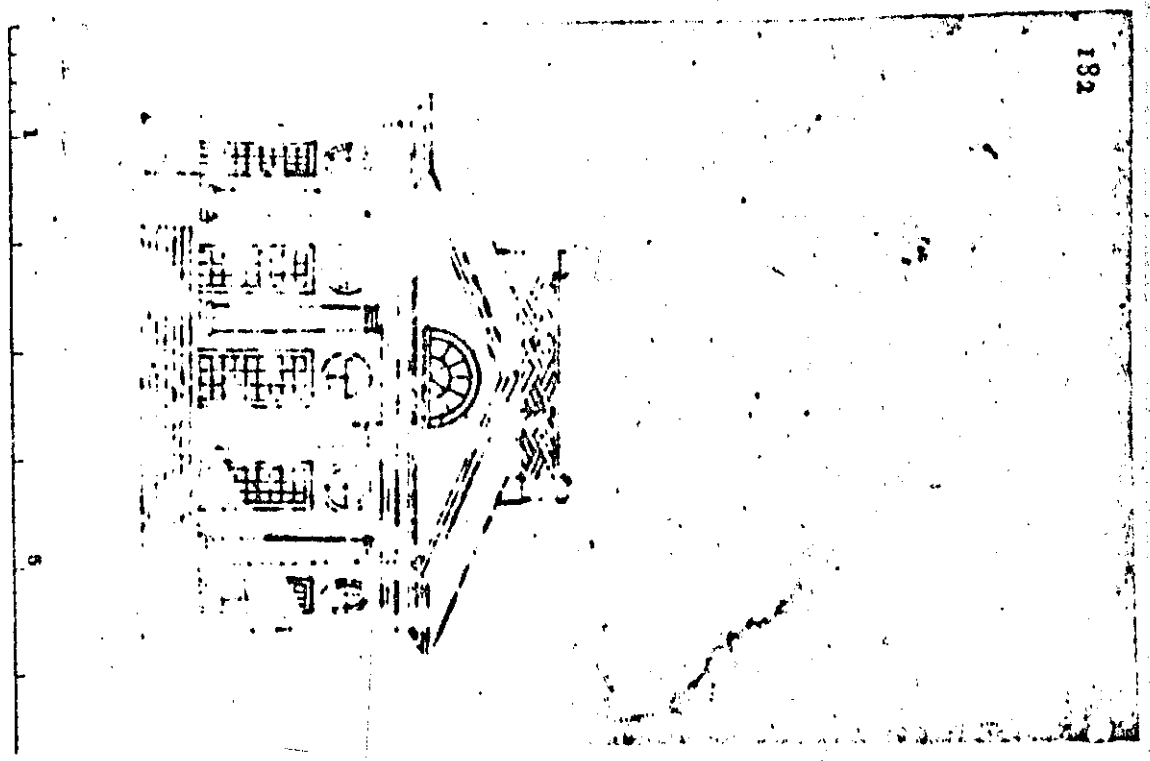

Thomas Jefferson's drawing for the addition to Farmington

10-301  
July 1969)

UNITED STATES DEPARTMENT OF THE INTERIOR  
NATIONAL PARK SERVICE

NATIONAL REGISTER OF HISTORIC PLACES

PROPERTY MAP FORM

(Type all entries - attach to or enclose with map)

STATE	Virginia
COUNTY	Albemarle
FOR NPS USE ONLY	
ENTRY NUMBER	DATE

SEE INSTRUCTIONS

1. NAME

COMMON: Farmington

AND/OR HISTORIC: Farmington

2. LOCATION

STREET AND NUMBER:

.7 mi. N of Rt. 250, .9 mi. W of intersection with Rt. 250-29 Bypass.

CITY OR TOWN:

(Charlottesville vic.)

STATE:	CODE	COUNTY:	CODE
Virginia	45	Albemarle	003

3. MAP REFERENCE

SOURCE:

U.S.G.S. 7.5', quadrangle Charlottesville West, Va.

SCALE: 1:24000

DATE: 1964

4. REQUIREMENTS

- TO BE INCLUDED ON ALL MAPS
1. Property boundaries where required.
  2. North arrow.
  3. Latitude and longitude reference.

UNITED STATES DEPARTMENT OF THE INTERIOR  
NATIONAL PARK SERVICE

NATIONAL REGISTER OF HISTORIC PLACES

PROPERTY PHOTOGRAPH FORM

(Type all entries - attach to or enclose with photograph)

STATE	Virginia
COUNTY	Albemarle
FOR NPS USE ONLY	
ENTRY NUMBER	DATE

SEE INSTRUCTIONS

1. NAME

COMMON: Farmington

AND/OR HISTORIC: Farmington

2. LOCATION

STREET AND NUMBER:

.7 mi. N of Rt. 250, .9 mi. W of intersection with Rt. 250-29 Bypass.

CITY OR TOWN:

(Charlottesville vic.)

STATE:	CODE	COUNTY:	CODE
Virginia	45	Albemarle	003

3. PHOTO REFERENCE

PHOTO CREDIT: Virginia State Chamber of Commerce

DATE OF PHOTO: 1962

NEGATIVE FILED AT:

Virginia State Chamber of Commerce; Richmond, Virginia

4. IDENTIFICATION

DESCRIBE VIEW, DIRECTION, ETC.  
  
View from the east

U.S.G.S. 7½' quadrangle (Scale: 1:24,000)  
 Charlottesville West, Va. 1964

+ Farmington

Latitude

Longitude

NW 38° 03' 48"

78° 32' 40"

NE 38° 03' 48"

78° 32' 25"

SE 38° 03' 41"

78° 32' 25"

SW 38° 03' 41"

78° 32' 40"

