

NATIONAL REGISTER OF HISTORIC PLACES
INVENTORY - NOMINATION FORM

(NATIONAL HISTORIC

LANDMARK) *(Type all entries complete applicable sections)*

COUNTY:

Hanover

FOR NPS USE ONLY

ENTRY DATE

1. NAME

COMMON:

Marlbourne

AND/OR HISTORIC:

Marlbourne (Edmund Ruffin Plantation)

2. LOCATION

STREET AND NUMBER:

on U.S. 360, 17 miles northeast of Richmond and 3 miles west of Pamunkey River

CITY OR TOWN:

Mechanicsville

CONGRESSIONAL DISTRICT:

Seventh (7th)

STATE

Virginia 23111

COUNTY:

51 Hanover

CODE

085

CLASSIFICATION

CATEGORY (Check One)	OWNERSHIP		STATUS	ACCESSIBLE TO THE PUBLIC
<input checked="" type="checkbox"/> District <input type="checkbox"/> Building <input type="checkbox"/> Sisk <input type="checkbox"/> Structure <input type="checkbox"/> Object	<input type="checkbox"/> Public <input checked="" type="checkbox"/> Private <input type="checkbox"/> Both	Public Acquisition: <input type="checkbox"/> In Process <input type="checkbox"/> Being Considered	<input checked="" type="checkbox"/> Occupied <input type="checkbox"/> Unoccupied <input type="checkbox"/> Preservation work in progress	Yes: <input type="checkbox"/> Restricted <input type="checkbox"/> Unrestricted <input checked="" type="checkbox"/>
PRESENT USE (Check One or More as Appropriate)				
<input checked="" type="checkbox"/> Agricultural <input type="checkbox"/> Commercial <input type="checkbox"/> Educational <input type="checkbox"/> Entertainment	<input type="checkbox"/> Government <input type="checkbox"/> Industrial <input type="checkbox"/> Military <input type="checkbox"/> Museum	<input type="checkbox"/> Park <input checked="" type="checkbox"/> Private Residence <input type="checkbox"/> Religious <input type="checkbox"/> Scientific	<input type="checkbox"/> Transportation <input type="checkbox"/> Other (Specify)	<input type="checkbox"/> Comments

4. OWNER OF PROPERTY

OWNER'S NAME

Mr. Tighlman Broaddus

STREET AND NUMBER:

Route 2

CITY OR TOWN:

Mechanicsville

STATE:

Virginia 23111

CODE

51

5. LOCATION OF LEGAL DESCRIPTION

COURTHOUSE, REGISTRY OF DEEDS, ETC.:

Hanover County Courthouse

STREET AND NUMBER:

CITY OR TOWN:

Hanover

STATE

Virginia

CODE

51

6. REPRESENTATION IN EXISTING SURVEYS

TITLE OF SURVEY:

Historic American Buildings Survey Inventory

DATE OF SURVEY: 1969

Federal State County Local

DEPOSITORY FOR SURVEY RECORDS:

Library of Congress/ Annex

STREET AND NUMBER:

Prints and Photographs Division

CITY OR TOWN:

Washington

STATE:

D.C.

CODE

11

SEE INSTRUCTIONS

STATE: Virginia
COUNTY: Hanover
ENTRY NUMBER
DATE

FOR NPS USE ONLY

VLR-9/9/69 NRHP-10/15/66 NHL-7/19/64

7 DESCRIPTION

CONDITION	(Check One)					
	<input type="checkbox"/> Excellent	<input type="checkbox"/> Good	<input checked="" type="checkbox"/> Fair	<input type="checkbox"/> Deteriorated	<input type="checkbox"/> Ruins	<input type="checkbox"/> Unexposed
	(Check One)			(Check One)		
	<input checked="" type="checkbox"/> Altered	<input type="checkbox"/> Unaltered	<input type="checkbox"/> Moved	<input checked="" type="checkbox"/> Original Site		

DESCRIBE THE PRESENT AND ORIGINAL (If known) PHYSICAL APPEARANCE

Marlbourne is the burial place and one time home of Edmund Ruffin, agricultural pioneer and radical secessionist. It is a white frame, two-story house, overlooking broad lowlands; it has a two story porch in front and another porch in the rear. There are one-story wings on either side of the main building, the east wing being a 20th century addition. Very little remains of the original outbuildings; only a dairy shed and a smokehouse are still standing. The fields surrounding the house still contain traces of the marl pits and irrigation sites with which Ruffin pursued his agricultural experiments. These are shown on the accompanying sketch map A. The building is structurally sound, but in serious need of surface repairs.

BOUNDARIES

The boundaries are those owned by Edmund Ruffin, 1843-1855. The main Marlbourne tract is owned by Tighlman Broaddus; the Loury tract, purchased by Ruffin in the early 1850's, is delineated on sketch map A. About one quarter is owned by Mr. Broaddus, and another quarter by his brother, Meade Broaddus. The rest is owned jointly by three sisters: Mrs. Sterling Anderson, Mrs. C. R. Randolph, and Miss Jane Everly Ruffin.

As shown by the yellow line on the accompanying topographic map entitled "Manquin, Va." and dated 1965, from a point at the junction of U.S. Route 360 and Virginia Route 605, proceed northwest along Route 605 about 2,000 feet, then northeast perpendicular to Route 605 about 1700 feet to a point touching the junction of the Pamunkey River and a small wooded plot south of that river. Proceed west about 2000 feet along the south bank of the Pamunkey River to a point touching its junction with another small wooded plot. Proceed southwest about 600 feet to Route 605, then northwest about 1700 feet along Route 605 to the junction of that road with Totopotomy Creek. Proceed southwest and south about 3000 feet along the south branch of Totopotomy Creek, then southwest about 2,700 feet to a point about 300 feet east of a service road connecting Route 605 with Route 628. Proceed northwest on a line perpendicular to the one just followed about 2200 feet, then southwest, again perpendicular about 3000 feet to a point on the Totopotomy some 2500 feet due north of Route 628. Proceed southwesterly about 3000 feet along the Totopotomy to Route 628 and past it about 500 feet. Proceed northeast about 1500 feet to the service road, then southerly along the service road about 1500 feet to Route 628. Proceed southerly about 3500 feet along Route 628 to a point about 1800 feet north of its junction with Route 606. Proceed northwest about 2200 feet to a point touching a bend in an unnamed creek. Proceed northwesterly along the creek about 4300 feet to a point where a large wooded area which the creek has followed bends southeast. Proceed about 2500 feet

SEE INSTRUCTIONS

NATIONAL REGISTER OF HISTORIC PLACES
INVENTORY - NOMINATION FORM

(NATIONAL HISTORIC
LANDMARKS)

(Continuation Sheet)

STATE Virginia	
COUNTY Hanover	
FOR NPS USE ONLY	
ENTRY NUMBER	DATE

(Number all entries)

7.. Description second page

southeasterly along the edge of the woods and along a line with it to an old railroad grade. Proceed about 4500 feet northeast along the grade to a point about 2300 feet southeast of the junction of U.S. Route 360 and Route 605. Proceed northwest about 2300 feet on a line with Route 605 to the point of beginning.

B. SIGNIFICANCE

PERIOD (Check One or More as Appropriate)

<input type="checkbox"/> Pre-Columbian	<input type="checkbox"/> 16th Century	<input type="checkbox"/> 18th Century	<input type="checkbox"/> 20th Century
<input type="checkbox"/> 15th Century	<input type="checkbox"/> 17th Century	<input checked="" type="checkbox"/> 19th Century	

SPECIFIC DATE(S) (If Applicable and Known) **1843-1855**

AREAS OF SIGNIFICANCE (Check One or More as Appropriate)

<input type="checkbox"/> Aboriginal	<input type="checkbox"/> Education	<input checked="" type="checkbox"/> Political	<input type="checkbox"/> Urban Planning
<input type="checkbox"/> Prehistoric	<input type="checkbox"/> Engineering	<input type="checkbox"/> Religion/Philosophy	<input type="checkbox"/> Other (Specify)
<input type="checkbox"/> Historic	<input type="checkbox"/> Industry	<input type="checkbox"/> Science	_____
<input checked="" type="checkbox"/> Agriculture	<input type="checkbox"/> Invention	<input type="checkbox"/> Sculpture	_____
<input type="checkbox"/> Architecture	<input type="checkbox"/> Landscape Architecture	<input type="checkbox"/> Social/Humanitarian	_____
<input type="checkbox"/> Art	<input type="checkbox"/> Literature	<input type="checkbox"/> Theater	_____
<input type="checkbox"/> Commerce	<input type="checkbox"/> Military	<input type="checkbox"/> Transportation	_____
<input type="checkbox"/> Communications	<input type="checkbox"/> Music		_____
<input type="checkbox"/> Conservation			_____

STATEMENT OF SIGNIFICANCE

SEE INSTRUCTIONS

Marlbourne was the home of Edmund Ruffin (1794-1865), and the site of many of his pioneering agricultural experiments.

When Ruffin began farming in 1813, agriculture in Virginia was at a low ebb. The continual planting of a single crop on the same lands, and poor plowing and planting methods, had depleted the soil. Many planters were ruined, and thousands had left the state. Ruffin had little knowledge, practical or theoretical, concerning soil depletion. Within three years, he had achieved positive results by applying calcerous earths (mare) to restore the fertility of soil turned "acid" by harmful cultivation. In October 1818, Ruffin demonstrated that fertilizers, crop rotation, drainage and proper plowing would produce fertility equal to or greater than the original. By 1832 his theories and results had grown into a volume of 242 pages, An Essay on Calcareous Manures. This work ran through five editions and grew to nearly five hundred pages. In 1833, he began publication of an agricultural journal, the Farmer's Register. It rendered invaluable service to the whole South for ten years. When the Virginia State Agricultural Society was organized in 1845, he was elected its president.

Ruffin moved to Marlbourne in 1843, where he lived until retirement in 1855. He wrote and spoke much on agricultural improvement in these years for newspapers, farm journals, and agricultural societies. Also during this time, Ruffin developed his ardent defense of slavery and the right to secession in four pamphlets: The Effects of Domestic Slavery on the Manners, Habits, and Welfare of the Agricultural Population of the Southern States, and the Slavery of Class to Class in the Northern States (1854); The Political Economy of Slavery (1858); African Colonization Unveiled (1859); and Slavery and Free Labor Described and Compared (1859-60). In 1860 he published a book, Anticipations of the Future, Designed to show the necessity of secession and the glories of an independent South.

Ruffin attended three state conventions for secession 1861, and fired the first shot against Fort Sumter in Charleston harbor. With the collapse of the Confederacy in 1865, Ruffin shot himself with a shotgun, June 18. He is buried in the family graveyard at Marlbourne.

9. MAJOR BIBLIOGRAPHICAL REFERENCES

Cutler, W. P., "A Pioneer in Agricultural Science," in Yearbook of U.S. Dept. Agriculture in 1895 (1896), pp. 493-502

Swem, E. G., "An Analysis of Edmund Ruffin's Farm Register with a Bibliography of Edmund Ruffin" (Bulletin of VA. State Lib., XI, July-Oct., 1918)

Craven, A. O., Edmund Ruffin, Southerner (1932)

Craven, A. O., "Edmund Ruffin", in Dictionary of American Biography vol. XVI, (1943), pp. 215-16.

10. GEOGRAPHICAL DATA

LATITUDE AND LONGITUDE COORDINATES DEFINING A RECTANGLE LOCATING THE PROPERTY			O R	LATITUDE AND LONGITUDE COORDINATES DEFINING THE CENTER POINT OF A PROPERTY OF LESS THAN TEN ACRES		
CORNER	LATITUDE	LONGITUDE		LATITUDE	LONGITUDE	
	Degrees Minutes Seconds	Degrees Minutes Seconds		Degrees Minutes Seconds	Degrees Minutes Seconds	
NW	18.301790.4171200	° ' "		° ' "	° ' "	
NE	18.305040.4172750	° ' "		° ' "	° ' "	
SE	18.306790.4170100	° ' "		° ' "	° ' "	
SW	18.303500.4168550	° ' "		° ' "	° ' "	

APPROXIMATE ACREAGE OF NOMINATED PROPERTY: 1200

LIST ALL STATES AND COUNTIES FOR PROPERTIES OVERLAPPING STATE OR COUNTY BOUNDARIES

STATE:	CODE	COUNTY	CODE
STATE:	CODE	COUNTY:	CODE
STATE:	CODE	COUNTY:	CODE
STATE:	CODE	COUNTY:	CODE

11. FORM PREPARED BY

NAME AND TITLE:
Stephen Lissandrello, Historian, Landmarks Review Project

ORGANIZATION: Historic Sites Survey, National Park Service DATE: 12/16/74

STREET AND NUMBER:
1100 L. Street, N.W.

CITY OR TOWN: Washington STATE: D.C. CODE: 11

12. STATE LIAISON OFFICER CERTIFICATION

As the designated State Liaison Officer for the National Historic Preservation Act of 1966 (Public Law 89-665), I hereby nominate this property for inclusion in the National Register and certify that it has been evaluated according to the criteria and procedures set forth by the National Park Service. The recommended level of significance of this nomination is:

National State Local

Name (NATIONAL HISTORIC LANDMARKS)

Title

Date (NATIONAL HISTORIC LANDMARKS)

NATIONAL REGISTER VERIFICATION

I hereby certify that this property is included in the National Register.

(NATIONAL HISTORIC LANDMARKS)
Landmark
Director, Office of Archeology and Historic Preservation Designated: July 11, 1974 date

Date (NATIONAL HISTORIC LANDMARKS) Boundary Commission: Cornelius Hanna 6-23-74

ATTEST: Chief of Div. & Arch. Surveys date

Date Keeper of The National Register: [Signature] 7/27/75

SEE INSTRUCTIONS

A.

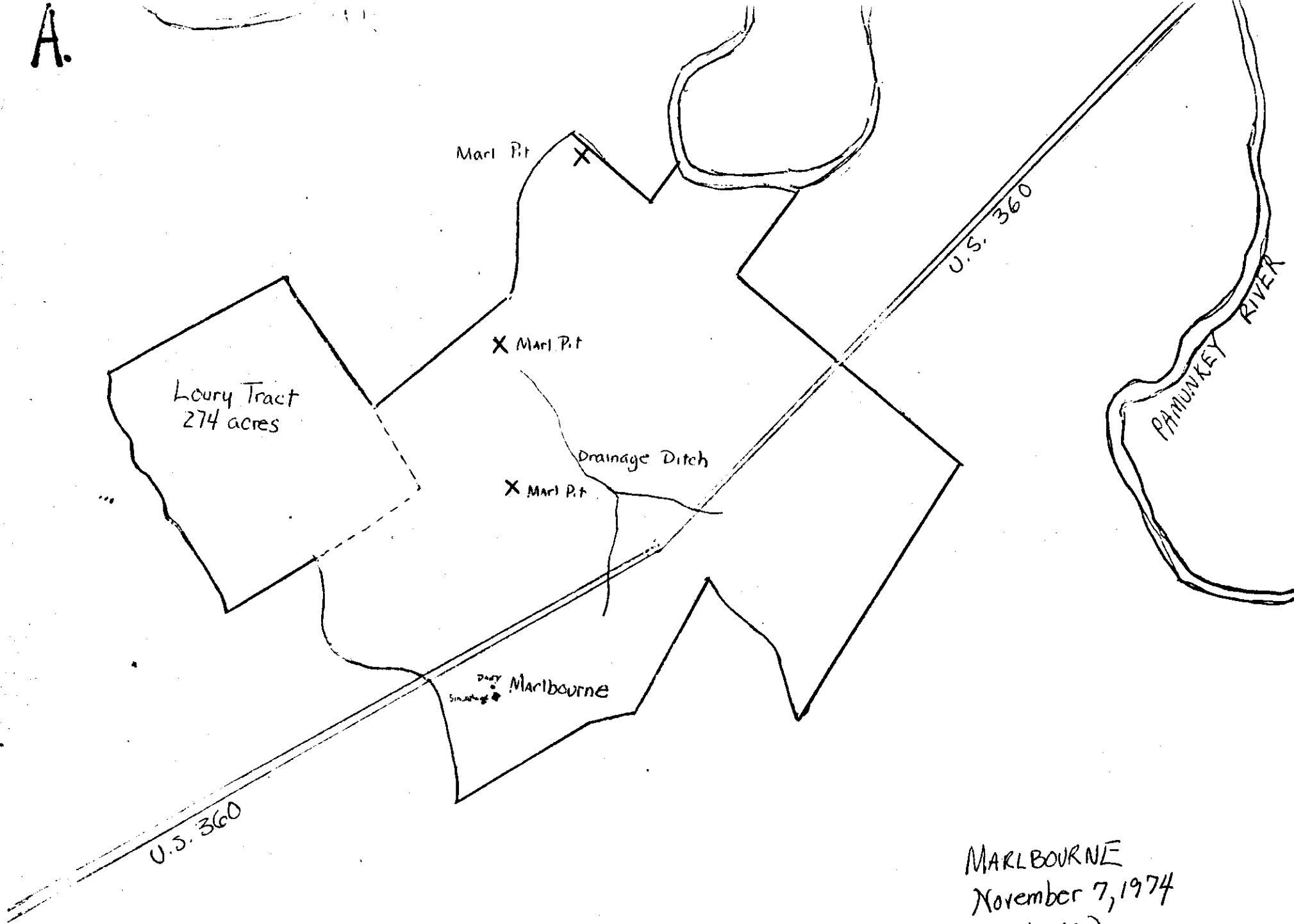

MARLBORNE
November 7, 1974
(1:24,000).

(STUDLEY 11 12)

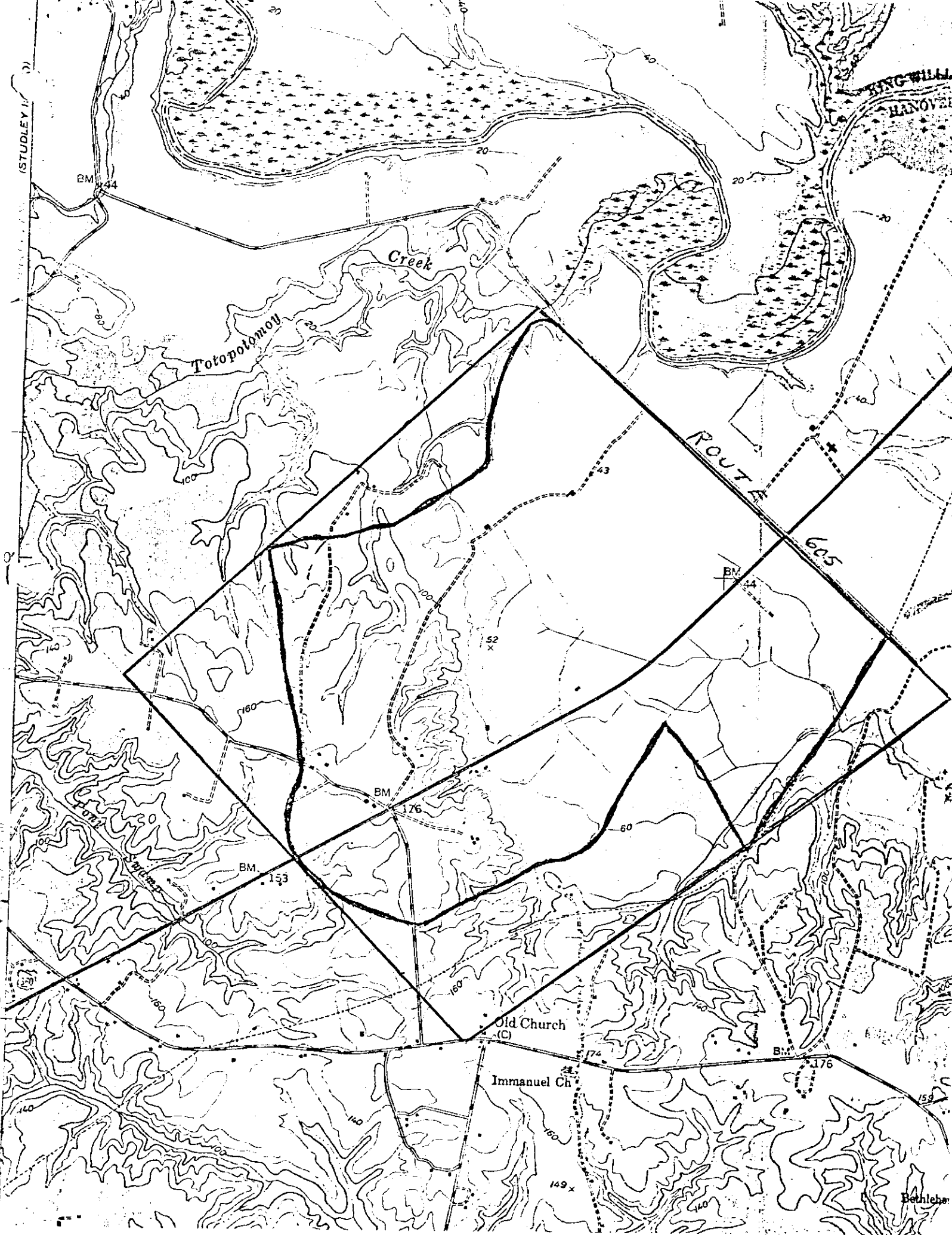

BM 44

Totopotomoy Creek

ROUTE 605

605

BM 44

BM 176

BM 153

Old Church (C)

Immanuel Ch

BM 176

Bethlehe

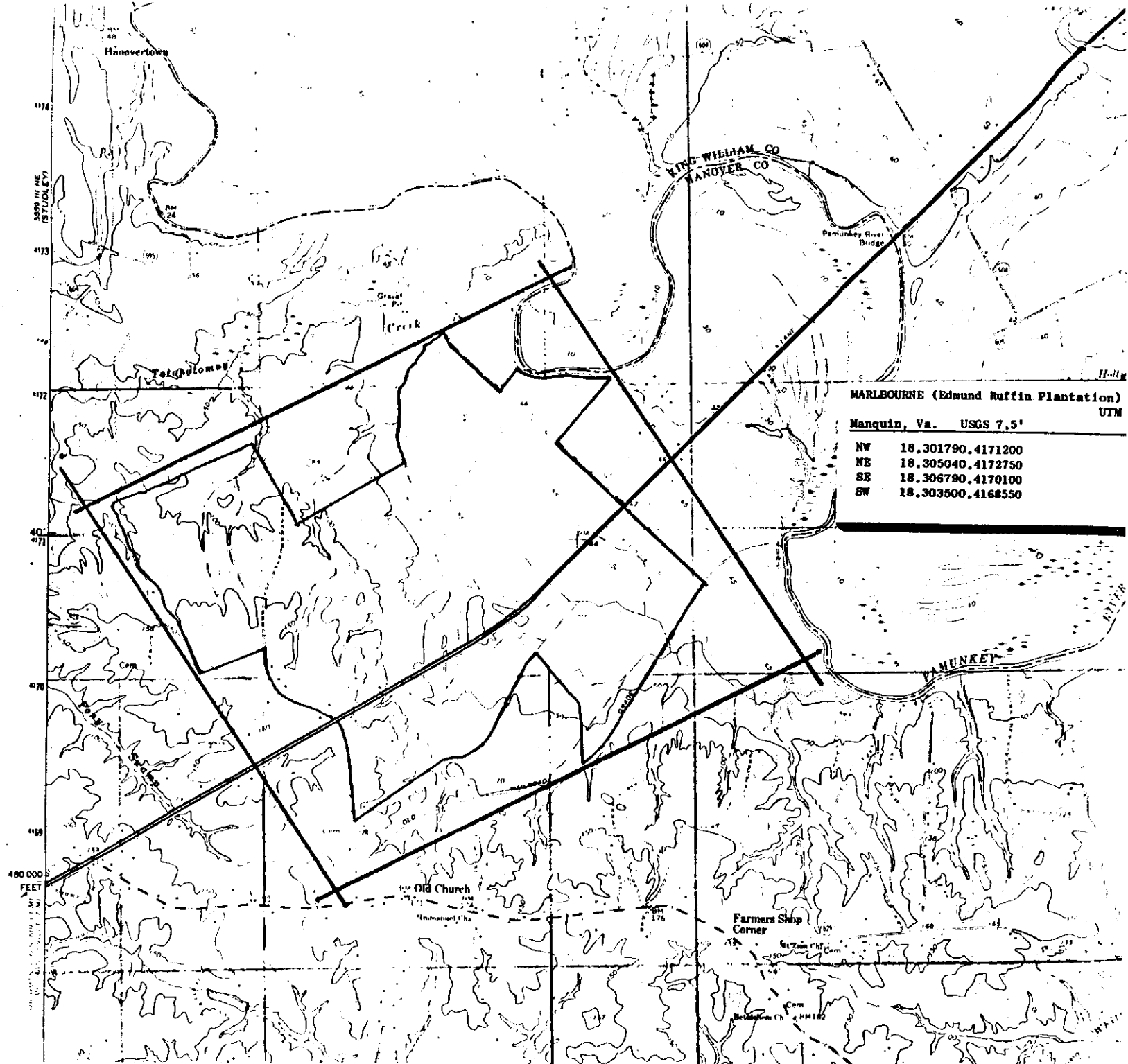

MARLBOURNE (Edmund Ruffin Plantation)
 UTM

Manquin, Va. USGS 7.5'

NW	18.301790.4171200
NE	18.305040.4172750
SE	18.306790.4170100
SW	18.303500.4168550