

NATIONAL REGISTER OF HISTORIC PLACES
INVENTORY - NOMINATION FORM

(Type all entries - complete applicable sections)

VLR-11/5/68
NRHP-11/12/69



STATE: Virginia	
COUNTY: Montgomery	
FOR NPS USE ONLY	
ENTRY NUMBER	DATE

1. NAME

COMMON:
Smithfield

AND/OR HISTORIC:
Smithfield

2. LOCATION

STREET AND NUMBER: .8 mi. S of Rt. 685, 1 mi. W of Blacksburg city limits.

CITY OR TOWN:

STATE: Virginia CODE: 45 COUNTY: Montgomery CODE: 121

3. CLASSIFICATION

CATEGORY (Check One)	OWNERSHIP		STATUS	ACCESSIBLE TO THE PUBLIC
District <input type="checkbox"/> Building <input checked="" type="checkbox"/>	Public <input type="checkbox"/>	Public Acquisition: <input type="checkbox"/>	Occupied <input checked="" type="checkbox"/>	Yes: <input type="checkbox"/>
Site <input type="checkbox"/> Structure <input type="checkbox"/>	Private <input checked="" type="checkbox"/>	In Process <input type="checkbox"/>	Unoccupied <input type="checkbox"/>	Restricted <input checked="" type="checkbox"/>
Object <input type="checkbox"/>	Both <input type="checkbox"/>	Being Considered <input type="checkbox"/>	Preservation work in progress <input checked="" type="checkbox"/>	Unrestricted <input type="checkbox"/>
PRESENT USE (Check One or More as Appropriate)				
Agricultural <input type="checkbox"/>	Government <input type="checkbox"/>	Park <input type="checkbox"/>	Transportation <input type="checkbox"/>	Comments <input type="checkbox"/>
Commercial <input type="checkbox"/>	Industrial <input type="checkbox"/>	Private Residence <input type="checkbox"/>	Other (Specify) <input type="checkbox"/>	
Educational <input type="checkbox"/>	Military <input type="checkbox"/>	Religious <input type="checkbox"/>		
Entertainment <input type="checkbox"/>	Museum <input checked="" type="checkbox"/>	Scientific <input type="checkbox"/>		

4. OWNER OF PROPERTY

OWNERS NAME:
Association for the Preservation of Virginia Antiquities

STREET AND NUMBER:
2705 Park Avenue

CITY OR TOWN: Richmond STATE: Virginia CODE: 45

5. LOCATION OF LEGAL DESCRIPTION

COURTHOUSE, REGISTRY OF DEEDS, ETC.:
Montgomery County Court House

STREET AND NUMBER:

CITY OR TOWN: Christiansburg STATE: Virginia CODE: 45

APPROXIMATE ACREAGE OF NOMINATED PROPERTY: 4.5 acres

6. REPRESENTATION IN EXISTING SURVEYS

TITLE OF SURVEY:
Historic American Buildings Survey Inventory

DATE OF SURVEY: 1958 Federal State County Local

DEPOSITORY FOR SURVEY RECORDS:
Library of Congress

STREET AND NUMBER:

CITY OR TOWN: Washington STATE: District of Columbia CODE: 08

SEE INSTRUCTIONS

STATE: Virginia
COUNTY: Montgomery
ENTRY NUMBER: DATE: FOR NPS USE ONLY

7. DESCRIPTION

CONDITION	(Check One)					
	Excellent <input checked="" type="checkbox"/>	Good <input type="checkbox"/>	Fair <input type="checkbox"/>	Deteriorated <input type="checkbox"/>	Ruins <input type="checkbox"/>	Unexposed <input type="checkbox"/>
INTEGRITY	(Check One)			(Check One)		
	Altered <input type="checkbox"/>	Unaltered <input checked="" type="checkbox"/>		Moved <input type="checkbox"/>	Original Site <input checked="" type="checkbox"/>	

DESCRIBE THE PRESENT AND ORIGINAL (if known) PHYSICAL APPEARANCE

Although located in the western part of the state, the Smithfield plantation house is of a form and style found in the Tidewater region. The house is a one and one-half story frame, L-shaped structure with dormers. The principal facade is five-bays with a centered front door; the ell has asymmetrical arrangement of windows and doors. Each arm of the house features a gable end, though the roof is hipped where the ell joins the main block. The house also displays an exterior chimney, an interior chimney, and an interior end chimney. All of the architectural details of Smithfield, both on the interior and exterior, are of the utmost simplicity.

The outbuildings at Smithfield include a smokehouse, summer kitchen, law office, spring house, grist mill, miller's house, and barn.

Although little changed since it was completed, Smithfield has been recently restored.

SEE INSTRUCTIONS

8. SIGNIFICANCE

PERIOD (Check One or More as Appropriate)

- Pre-Columbian 16th Century 18th Century 20th Century
 15th Century 17th Century 19th Century

SPECIFIC DATE(S) (If Applicable and Known)

AREAS OF SIGNIFICANCE (Check One or More as Appropriate)

- | | | | | | | |
|----------------|--------------|--------------------------|----------------|-------------------------------------|-----------------|--------------------------|
| Aboriginal | Education | <input type="checkbox"/> | Political | <input checked="" type="checkbox"/> | Urban Planning | <input type="checkbox"/> |
| Prehistoric | Engineering | <input type="checkbox"/> | Religion/Phi- | | Other (Specify) | <input type="checkbox"/> |
| Historic | Industry | <input type="checkbox"/> | losophy | <input type="checkbox"/> | | |
| Agriculture | Invention | <input type="checkbox"/> | Science | <input type="checkbox"/> | | |
| Art | Landscape | <input type="checkbox"/> | Sculpture | <input type="checkbox"/> | | |
| Commerce | Architecture | <input type="checkbox"/> | Social/Human- | | | |
| Communications | Literature | <input type="checkbox"/> | itarian | <input type="checkbox"/> | | |
| Conservation | Military | <input type="checkbox"/> | Theater | <input type="checkbox"/> | | |
| | Music | <input type="checkbox"/> | Transportation | <input type="checkbox"/> | | |

STATEMENT OF SIGNIFICANCE (Include Personages, Dates, Events, Etc.)

Smithfield is one of the earliest large plantation houses built west of the Blue Ridge Mountains. The land on which it stands was originally patented to Colonel John Patton. His nephew, Colonel William Preston, served with his uncle in the war against the Indians, and in 1773 received 3000 acres in Montgomery County. Colonel Preston began building the present house shortly before the Revolution, completing it after the war. James Patton Patterson, later Governor of Virginia, was born at Smithfield, and his daughter married John Floyd who served as Virginia's Governor from 1830-34. Their son, John Buchanan Floyd, was also born at Smithfield, and served as Governor from 1849-52.

Significant because of its early appearance and location, Smithfield, with its vast array of outbuilding, is unique for its time and place.

SEE INSTRUCTIONS

9. MAJOR BIBLIOGRAPHICAL REFERENCES

Lamb, Janie B., "Smithfield, Home of the Prestons," Virginia Magazine of History and Biography, XLVII, April, 1939, 109-125.
 Kegley, B. F., Virginia Frontier, Roanoke, 1933.
 Preston Papers, Virginia Historical Society.
 Crush, Charles W., The Montgomery County Story, 1776-1957, Jamestown Festival, 1957.
 Lancaster, Robert A., Historic Virginia Homes and Churches, Philadelphia: 1915.

10. GEOGRAPHICAL DATA

LATITUDE AND LONGITUDE COORDINATES DEFINING A RECTANGLE LOCATING THE PROPERTY			D R	LATITUDE AND LONGITUDE COORDINATES DEFINING THE CENTER POINT OF A PROPERTY OF LESS THAN ONE ACRE		
CORNER	LATITUDE	LONGITUDE		LATITUDE	LONGITUDE	
	Degrees Minutes Seconds	Degrees Minutes Seconds		Degrees Minutes Seconds	Degrees Minutes Seconds	
NW	° ' "	° ' "		37° 13' 26"	80° 25' 56"	
NE	° ' "	° ' "				
SE	° ' "	° ' "				
SW	° ' "	° ' "				

LIST ALL STATES AND COUNTIES FOR PROPERTIES OVERLAPPING STATE OR COUNTY BOUNDARIES

STATE:	CODE	COUNTY	CODE
STATE:	CODE	COUNTY:	CODE
STATE:	CODE	COUNTY:	CODE
STATE:	CODE	COUNTY:	CODE

11. FORM PREPARED BY

NAME AND TITLE:
 Staff, Virginia Historic Landmarks Commission, James W. Moody, Jr., Director

ORGANIZATION: Virginia Historic Landmarks Commission DATE: April 28, 1969

STREET AND NUMBER:
 Room 1116, Ninth Street State Office Building

CITY OR TOWN: Richmond STATE: Virginia CODE: 45

12. STATE LIAISON OFFICER CERTIFICATION

As the designated State Liaison Officer for the National Historic Preservation Act of 1966 (Public Law 89-665), I hereby nominate this property for inclusion in the National Register and certify that it has been evaluated according to the criteria and procedures set forth by the National Park Service. The recommended level of significance of this nomination is:

National State Local

Name Edw P. Alexander per John
 Dr. Edward P. Alexander, Chairman
 Title Virginia Historic Landmarks Comm.
 Date June 2, 1969

NATIONAL REGISTER VERIFICATION

I hereby certify that this property is included in the National Register.

 Chief, Office of Archeology and Historic Preservation

Date _____

ATTEST:

 Keeper of The National Register

Date _____

SEE INSTRUCTIONS

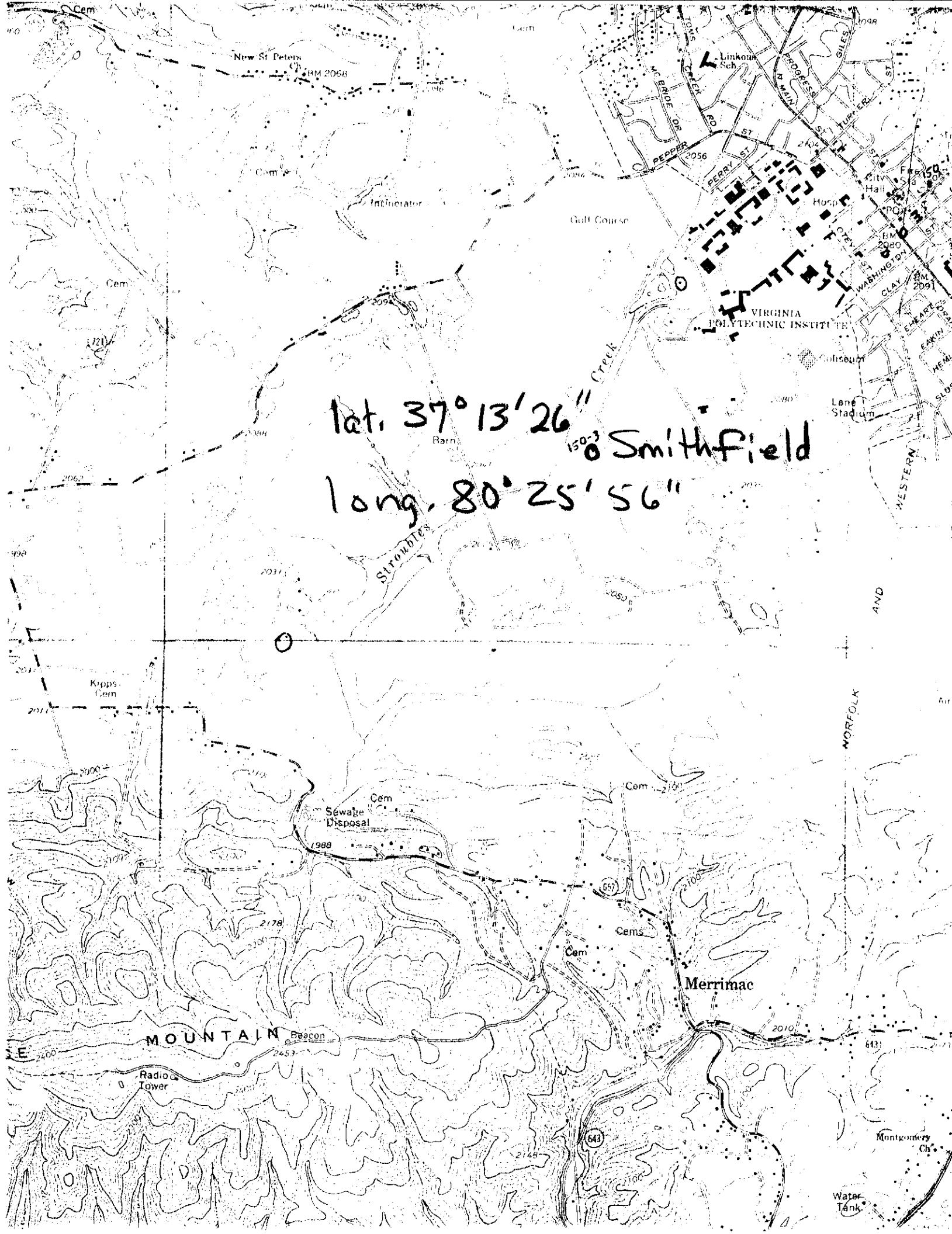

lat. $37^{\circ}13'26''$
Smithfield
long. $80^{\circ}25'56''$