

already on National Register

UNITED STATES DEPARTMENT OF THE INTERIOR
NATIONAL PARK SERVICE

**NATIONAL REGISTER OF HISTORIC PLACES
INVENTORY -- NOMINATION FORM**

FOR FEDERAL PROPERTIES

FOR NPS USE ONLY
RECEIVED MAY 31 1977
DATE ENTERED *approved 5/23/78*

SEE INSTRUCTIONS IN HOW TO COMPLETE NATIONAL REGISTER FORMS
TYPE ALL ENTRIES -- COMPLETE APPLICABLE SECTIONS

1 NAME

HISTORIC

FREDERICKSBURG & SPOTSYLVANIA COUNTY BATTLEFIELDS
AND/OR COMMON
MEMORIAL NATIONAL MILITARY PARK AND CEMETERY

2 LOCATION

STREET & NUMBER

1013 LAFAYETTE BOULEVARD

___ NOT FOR PUBLICATION

CITY, TOWN

CONGRESSIONAL DISTRICT

FREDERICKSBURG

___ VICINITY OF

7

STATE

VIRGINIA 22401

CODE

51

COUNTY

FREDERICKSBURG (CTY)

CODE

630

3 CLASSIFICATION

CATEGORY

- ___ DISTRICT
- BUILDING(S)
- STRUCTURE
- ___ SITE
- ___ OBJECT

OWNERSHIP

- PUBLIC
- ___ PRIVATE
- ___ BOTH
- PUBLIC ACQUISITION**
- ___ IN PROCESS
- ___ BEING CONSIDERED

STATUS

- OCCUPIED
- ___ UNOCCUPIED
- ___ WORK IN PROGRESS
- ACCESSIBLE**
- YES: RESTRICTED
- ___ YES: UNRESTRICTED
- ___ NO

PRESENT USE

- ___ AGRICULTURE
- ___ COMMERCIAL
- EDUCATIONAL
- ___ GOVERNMENT
- ___ INDUSTRIAL
- ___ MILITARY
- MUSEUM
- PARK
- ___ PRIVATE RESIDENCE
- ___ RELIGIOUS
- ___ SCIENTIFIC
- ___ TRANSPORTATION
- ___ OTHER:

4 AGENCY

REGIONAL HEADQUARTERS: (if applicable)

MID-ATLANTIC REGION, NATIONAL PARK SERVICE

STREET & NUMBER

143 SOUTH THIRD STREET

CITY, TOWN

PHILADELPHIA

___ VICINITY OF

STATE

PENNSYLVANIA

19106

5 LOCATION OF LEGAL DESCRIPTION

COURTHOUSE,
REGISTRY OF DEEDS, ETC.

(SEE ATTACHED CONTINUATION SHEET)

STREET & NUMBER

CITY, TOWN

STATE

6 REPRESENTATION IN EXISTING SURVEYS

TITLE

BOUNDARY SURVEYS

DATE

1929 TO PRESENT

FEDERAL ___ STATE ___ COUNTY LOCAL

DEPOSITORY FOR
SURVEY RECORDS

FEDERAL RECORDS CENTER

CITY, TOWN

SUTTLAND

STATE

MARYLAND

20023

7 DESCRIPTION

CONDITION		CHECK ONE	CHECK ONE
<input type="checkbox"/> EXCELLENT	<input type="checkbox"/> DETERIORATED	<input type="checkbox"/> UNALTERED	<input checked="" type="checkbox"/> ORIGINAL SITE
<input checked="" type="checkbox"/> GOOD	<input type="checkbox"/> RUINS	<input checked="" type="checkbox"/> ALTERED	<input type="checkbox"/> MOVED DATE _____
<input type="checkbox"/> FAIR	<input type="checkbox"/> UNEXPOSED		

DESCRIBE THE PRESENT AND ORIGINAL (IF KNOWN) PHYSICAL APPEARANCE

Fredericksburg Battlefield: During the war period the town was a rather compact mass along the river, with 5,000 inhabitants. The portions of the field now in park ownership were almost devoid of houses and developments in 1862. Their present surroundings are heavily urban. The physical appearance of the Fredericksburg Battlefield is of a swath of grass and trees in a sea of modern houses and roads.

Chancellorsville Battlefield, Wilderness Battlefield, Spotsylvania Battlefield: In the 1860's these battlefields were within the region known as "The Wilderness of Spotsylvania." The area was a dense mass of second growth timber and matted undergrowth with only an occasional narrow road or cleared subsistence farm. Military action was keyed to the few thin gaps in the wilderness resulting from the transportation routes. The appearance of the area in the current parklands is maintained as near as possible to the historic scene, with the exception of the several high-speed modern roads which course through the park. As at Fredericksburg, the battlefields' appearance is dominated by non-park land nearby which is developed in a variety of intrusive ways. Only a small percentage of the battle area is preserved, particularly at the fields of Chancellorsville and the Wilderness.

Inventory of Historic Sites and Structures

1. Earthworks - There are approximately 35 distinct sets of earthen fortifications with a total length of 37 miles. A myriad of earthworks, usually shoulder height and log revetted, were erected in 1862-64. The remains have melted down to an average height of about two feet. These works represent the entire range of mid-nineteenth-century field fortifications.
2. The Stone Wall and the "Sunken Road" - Only a 50-yard section of the original 600-yard long Stone Wall has survived. This wall section, dry-laid, is in a good state of preservation. The road has been raised and covered with macadam.
3. The "Bloody Angle" - Very shallow trenches are the meager remains of the long-revetted earthen parapets which were constructed in May 1864.
4. "Chatham" - Constructed in the 1760's by William Fitzhugh, "Chatham" is a fine and well-preserved example of Georgian architecture. The two-story brick mansion has Flemish bond walls and two hyphen wings at either end. Carved entrance surrounds of the Corinthian order at front and rear and block modillion cornices serve to embellish the pleasing design. A one and one-half story brick servants quarters is standing on the property. (Interp/Admin)

photo #3

8 SIGNIFICANCE

PERIOD	AREAS OF SIGNIFICANCE -- CHECK AND JUSTIFY BELOW			
<input type="checkbox"/> PREHISTORIC	<input type="checkbox"/> ARCHEOLOGY-PREHISTORIC	<input type="checkbox"/> COMMUNITY PLANNING	<input type="checkbox"/> LANDSCAPE ARCHITECTURE	<input type="checkbox"/> RELIGION
<input type="checkbox"/> 1400-1499	<input type="checkbox"/> ARCHEOLOGY-HISTORIC	<input type="checkbox"/> CONSERVATION	<input type="checkbox"/> LAW	<input type="checkbox"/> SCIENCE
<input type="checkbox"/> 1500-1599	<input type="checkbox"/> AGRICULTURE	<input type="checkbox"/> ECONOMICS	<input type="checkbox"/> LITERATURE	<input type="checkbox"/> SCULPTURE
<input type="checkbox"/> 1600-1699	<input checked="" type="checkbox"/> ARCHITECTURE	<input type="checkbox"/> EDUCATION	<input checked="" type="checkbox"/> MILITARY	<input type="checkbox"/> SOCIAL/HUMANITARIAN
<input checked="" type="checkbox"/> 1700-1799	<input type="checkbox"/> ART	<input type="checkbox"/> ENGINEERING	<input type="checkbox"/> MUSIC	<input type="checkbox"/> THEATER
<input checked="" type="checkbox"/> 1800-1899	<input type="checkbox"/> COMMERCE	<input type="checkbox"/> EXPLORATION/SETTLEMENT	<input type="checkbox"/> PHILOSOPHY	<input type="checkbox"/> TRANSPORTATION
<input type="checkbox"/> 1900-	<input type="checkbox"/> COMMUNICATIONS	<input type="checkbox"/> INDUSTRY	<input type="checkbox"/> POLITICS/GOVERNMENT	<input type="checkbox"/> OTHER (SPECIFY)
	<input type="checkbox"/> INVENTION			

SPECIFIC DATES DECEMBER 1862 - MAY 1864 BUILDER/ARCHITECT

STATEMENT OF SIGNIFICANCE

A major theater of the American Civil War (1861-1865) lay between the rival capitals of Washington and Richmond. The intervening land was fought over repeatedly. The town of Fredericksburg stands midway between those cities. As a result, the countryside around Fredericksburg was the scene of four major battles: Fredericksburg, Chancellorsville, the Wilderness, and Spotsylvania Court House. A number of smaller engagements were a part of these campaigns, and cavalry skirmishes in the vicinity were a frequent occurrence throughout the war. Within a radius of 17 miles, more than 100,000 men were casualties in the battles. A detached site south of Fredericksburg is the house where General T. J. Jackson, CSA, died on May 10, 1863. The loss of Jackson was an irreparable blow to the Army of Northern Virginia, with an immeasurably broad impact on the course of the war. The significance of the house known as Jackson Shrine is based on the significance of the general who left the war behind and died within its walls.

DESCRIPTION OF THE PROPERTY TO Fredericksburg

A Union drive on Richmond in the late fall of 1862 was blunted at the base of Marye's Heights southwest of Fredericksburg. Union General Ambrose E. Burnside crossed the Rappahannock River on December 11 and captured the city. On December 13 he ordered assault after assault against General Robert E. Lee's Confederate troops posted behind a Stone Wall at the base of the Heights. The result was a bloody repulse of these Union forces. Burnside retreated across the river two days later.

The Ennis and Stevens Houses, located just in front of the Stone Wall were struck repeatedly by gunfire. Mrs. Martha Stevens remained in her home during the battle, and cared for wounded soldiers.

9 MAJOR BIBLIOGRAPHICAL REFERENCES

Bigelow, John The Campaign of Chancellorsville, New Haven, Yale University Press, 1910.

Henderson, G.F.R. Stonewall Jackson and the American Civil War, London, Longmans, Green and Company, 1898.

10 GEOGRAPHICAL DATA

ACREAGE OF NOMINATED PROPERTY 4601

UTM REFERENCES (See attached continuation sheet)

A	ZONE	EASTING	NORTHING	B	ZONE	EASTING	NORTHING
C				D			

VERBAL BOUNDARY DESCRIPTION

The boundaries of the nominated property coincide with the boundaries of Fredericksburg and Spotsylvania County Battlefields Memorial National Military Park and Cemetery as of April 7, 1976.

LIST ALL STATES AND COUNTIES FOR PROPERTIES OVERLAPPING STATE OR COUNTY BOUNDARIES

STATE	CODE	COUNTY	CODE
VIRGINIA	51	STAFFORD	179
STATE	CODE	COUNTY	CODE
VIRGINIA	51	SPOTSYLVANIA	177

11 FORM PREPARED BY

10. (See attached continuation sheet)

NAME / TITLE

Robert Krick (FSNMP) and Brooke Blades (MARO)

ORGANIZATION

National Park Service

DATE

April 7, 1976

STREET & NUMBER

143 South Third Street

TELEPHONE

(215) 597-9970

CITY OR TOWN

Philadelphia,

STATE

Pennsylvania 19106

12 CERTIFICATION OF NOMINATION

STATE HISTORIC PRESERVATION OFFICER RECOMMENDATION

YES ___ NO ___ NONE ___

STATE HISTORIC PRESERVATION OFFICER SIGNATURE

In compliance with Executive Order 11593, I hereby nominate this property to the National Register, certifying that the State Historic Preservation Officer has been allowed 90 days in which to present the nomination to the State Review Board and to evaluate its significance. The evaluated level of significance is National State Local.

FEDERAL REPRESENTATIVE SIGNATURE

[Signature]

MAY 25 1977

TITLE

DATE

FOR NPS USE ONLY

I HEREBY CERTIFY THAT THIS PROPERTY IS INCLUDED IN THE NATIONAL REGISTER

DATE

[Signature]
5/23/78

DIRECTOR, OFFICE OF ARCHITECTURAL AND HISTORIC PRESERVATION

ATTEST:

[Signature]

KEEPER OF THE NATIONAL REGISTER

KEEPER OF THE NATIONAL REGISTER

UNITED STATES DEPARTMENT OF THE INTERIOR
NATIONAL PARK SERVICE

**NATIONAL REGISTER OF HISTORIC PLACES
INVENTORY -- NOMINATION FORM**

FOR NPS USE ONLY

RECEIVED MAY 31 1977

DATE ENTERED *6/23/78*

CONTINUATION SHEET

ITEM NUMBER 5

PAGE one

5. LOCATION OF LEGAL DESCRIPTION

Clerk of the Circuit Court
Spotsylvania County
P. O. Box 96
Spotsylvania, Virginia 22553

S. L. Alexander
Clerk of the Circuit Court
Stafford, Virginia 22554

Clerk of the Circuit Court
Caroline County
Bowling Green, Virginia 22427

Clerk of the Circuit Court
Orange County
Box 230
Orange, Virginia 22960

Clerk of the Circuit Court
City of Fredericksburg
P. O. Box 488
Fredericksburg, Virginia 22401

UNITED STATES DEPARTMENT OF THE INTERIOR
NATIONAL PARK SERVICE

**NATIONAL REGISTER OF HISTORIC PLACES
INVENTORY -- NOMINATION FORM**

FOR NPS USE ONLY

RECEIVED MAY 31 1977

DATE ENTERED

Approved 5/23/78

CONTINUATION SHEET

ITEM NUMBER 7

PAGE one

- Page 2*
5. Ennis House - This two-story frame farm house was erected in the first half of the nineteenth century. It was located just east of the Stone Wall, on the side towards Fredericksburg. A brick chimney, offset from the gable, stood at the south end. Before the 1860's a leanto frame addition was constructed at the south end. This addition, like the original portion, stood on a stone rubble foundation. Two other rooms were added to the east (rear) side following the Civil War. The present weatherboard siding covers the original, some of which still bears bullet scars. The building is presently in a rather poor state of repair. (exterior Interp)
6. Stevens House (site) - The Stevens House stood immediately south of the Ennis House and was of similar construction. The one-and-one-half story dwelling burned in the twentieth century. No remains are currently visible.
- Page 3*
7. Quarters #1 (Building #2) - This one-and-one-half story stone house was constructed c. 1870 for use by the superintendent of the National Cemetery. The structure, possessing a mansard roof covered with octagonal slates, is in good condition. Stones taken from the original Stone Wall were employed in the construction. (Park Housing)
8. National Cemetery - The remains of nearly 16,000 soldiers are interred in this cemetery. Most were Union casualties from the fighting around Fredericksburg.
- Page 4*
9. Salem Church (Building #45) - The two-story brick Baptist church was erected in 1844. Salem Church was restored in the period 1972-74 and is in excellent condition. The common bond walls are heavily scarred on the east and north sides by bullets and cannon projectiles. An interesting detail of the structure is the corbelled brick cornice on the north and south sides. (Interp)
10. Maury House (site) - A depression filled with brick rubble is the only trace of the Maury House, a late eighteenth-century brick structure.

UNITED STATES DEPARTMENT OF THE INTERIOR
NATIONAL PARK SERVICE

NATIONAL REGISTER OF HISTORIC PLACES
INVENTORY -- NOMINATION FORM

FOR NPS USE ONLY

RECEIVED

MAY 31 1977

DATE ENTERED

Approved 5/23/78

CONTINUATION SHEET

ITEM NUMBER 7

PAGE two

- Photo 5*
11. Catharine Furnace (ruins) - Scattered stones and the base of a stone chimney stack mark the location of this nineteenth-century iron furnace. The complex, destroyed in 1864, originally included nine buildings and a furnace.
12. Chancellorsville Inn (ruins) - George Chancellor erected this two-story brick house c. 1815. Originally, a three-story wing stood at the rear. The eastern half of the building burned in May 1863. An addition was constructed c. 1880 to replace the destroyed section. The entire structure was razed in 1929. A portion of the cellar and foundation walls **remains exposed**.
13. "Jackson Trail" - This road trace, partially paved and covered with gravel, is basically unaltered in terms of location and surroundings.
- Photo 6*
14. Lacy House - The Lacy House was constructed in 1781, and is currently in good condition. Rough wooden shingles cover the original weatherboards of the two-story, T-shaped structure. Interior trim and flooring largely date from the initial construction period of the house. (**Housing**)
15. Widow Tapp Farm (site) - No remains are visible of the crude one-story frame farm house.
16. Woods Road - The outline of a section of a Civil War road trace used in troop movements is still visible.
17. Landrum House (ruins) - The bases of two stone end chimneys indicate the position of the Landrum House, a nineteenth-century farm dwelling.
18. McCoull House (ruins) - The McCoull House was a one-story frame structure with exterior brick chimneys at each end. An open cellar hole and stone foundations are the only visible remains.
19. Harrison House (ruins) - The Harrison House was nearly identical in construction to the McCoull House, both being humble farm dwellings. A stone rubble-filled depression remains.

UNITED STATES DEPARTMENT OF THE INTERIOR
NATIONAL PARK SERVICE

**NATIONAL REGISTER OF HISTORIC PLACES
INVENTORY -- NOMINATION FORM**

FOR NPS USE ONLY

RECEIVED MAY 31 1977

DATE ENTERED

Approved 5/23/78

CONTINUATION SHEET

ITEM NUMBER 7

PAGE three

20. "Jackson Shrine" (Building #5) - The one-and-one-half story frame office of "Fairfield", at Guinea Station, has been restored and is in excellent condition. Two exterior brick chimneys stand at the south end, one being enclosed by a leanto addition. The window sash, floorboards and wooden wainscot are largely original. (Interp)
21. "Fairfield" (site) - A two-story brick mansion which stood north of the office. Constructed by Thomas Coleman Chandler in the first half of the nineteenth century, the building was destroyed c. 1900. No remains are currently visible
22. Confederate supply depot (site) - A Confederate supply-base was on the Chandler property northeast of the office in 1862.
23. Iron and Gold Holes - Conical holes, some 20 feet in depth, dug following the Civil War for mining purposes.

UNITED STATES DEPARTMENT OF THE INTERIOR
NATIONAL PARK SERVICE

NATIONAL REGISTER OF HISTORIC PLACES
INVENTORY -- NOMINATION FORM

FOR NPS USE ONLY

RECEIVED

MAY 31 1977

DATE ENTERED

approved 5/23/78

CONTINUATION SHEET

ITEM NUMBER 8 PAGE one

"Chatham", across the river from Fredericksburg, possesses both architectural and historical significance. The building is an excellent example of the Georgian style. It was employed as headquarters by numerous Union generals. During the Battle of Fredericksburg, artillery posted nearby fired on the city. An early field telegraph was utilized here at the same time. Following the fighting a hospital was established on the property by, among others, Clara Barton.

Chancellorsville

General Joseph Hooker succeeded Burnside as commander of the Union Army of the Potomac. In the spring of 1863, he sought to strike the rear of Lee's Army of Northern Virginia. Lee turned and faced Hooker on May 1. As Hooker stood stationary at Chancellorsville, General T. J. "Stonewall" Jackson, marching along a wooded route now known as "Jackson Trail", launched a savage surprise attack on the exposed Union right flank late in the afternoon of May 2. The Federal line was broken, but Jackson was accidentally wounded by his own men and died eight days later. On May 3 the Confederates renewed the attack, and drove Hooker back against the Rappahannock River. (Hooker was injured when an artillery shell struck his headquarters in the Chancellorsville Inn. Subsequent gunfire destroyed a portion of the house.)

Lee then confronted a portion of the Union Army under General John Sedgwick which had moved through Fredericksburg. After fighting in the fields around Salem Church on May 3 and 4, Sedgwick was also forced back to the river.

Both the Maury House and Catharine Furnace were landmarks on the battlefield. The Maury House was the birthplace of Matthew Fontaine Maury (1806-74), a pioneer oceanographer. Catharine Furnace was incorporated in 1836 by the Wellford family, and abandoned ten years later. Re-opened for the manufacture of Confederate munitions, it was destroyed by Union cavalry in 1864.

UNITED STATES DEPARTMENT OF THE INTERIOR
NATIONAL PARK SERVICE

**NATIONAL REGISTER OF HISTORIC PLACES
INVENTORY -- NOMINATION FORM**

FOR NPS USE ONLY

RECEIVED MAY 31 1977

DATE ENTERED *approved 5/23/78*

CONTINUATION SHEET

ITEM NUMBER 8 PAGE TWO

The Wilderness

The coming of spring, 1864 witnessed the arrival of General Ulysses S. Grant in the East. On May 4 he led the Union army into a densely wooded area known as the Wilderness. Lee attacked the Union forces early the next morning, and for two days fierce fighting raged. A threatened Union breakthrough on May 6 was halted by a Texas brigade near the Widow Tapp Farm. Lee attempted to lead the counterchange but was prevented from doing so by troops crying "Lee to the Rear". The battle was a stalemate, and Grant moved toward Spotsylvania Court House on the evening of May 7.

Grant established his headquarters in a field near the Lacy House. This building was the summer residence of Confederate Major J. Horace Lacy, who also was the wartime owner of "Chatham". (In April 1781, the Marquis de Lafayette camped with a force of American cavalry in the fields around the Lacy House. A British cavalry unit launched a surprise attack, but Lafayette escaped following a wild chase through the wheat fields.)

Spotsylvania

Lee was able to outrace Grant to the vital road junction at Spotsylvania Court House on May 8. The Confederates entrenched northwest of the junction, with a "muleshoe" - shaped salient forming the center of the line. After three days of fighting on May 9,10,11, two Federal corps assualted the salient on the early morning of May 12. General Winfield Hancock, located at the Landrum House approximately three-fourths of a mile to the north, directed the attack. Twenty-four hours of unbelievably brutal hand-to-hand combat along an angle of the salient line gave rise to the infamous name "Bloody Angle". A Union charge pushed into the salient as far as the McCoull House where it was halted. Lee's headquarters stood nearby, and the house was the scene of yet another "Lee to the rear" incident. The Confederates finally withdrew on the morning of May 13 to a new line at the base of the salient, north of Lee's new headquarters location near the Harrison House. The final Confederate line, occupied on May 18, was located immediately south of the house. This line held until May 21, when Grant once again moved to the left and towards Richmond.

UNITED STATES DEPARTMENT OF THE INTERIOR
NATIONAL PARK SERVICE

**NATIONAL REGISTER OF HISTORIC PLACES
INVENTORY -- NOMINATION FORM**

FOR NPS USE ONLY

RECEIVED

MAY 31 1977

DATE ENTERED

approved 5/23/78

CONTINUATION SHEET

ITEM NUMBER 9

PAGE one

9. MAJOR BIBLIOGRAPHICAL REFERENCES

Henderson, G. F. R. The Campaign of Fredericksburg, London, Kegan Paul,
Trench and Company, 1886.

Steere, Edward The Wilderness Campaign, Harrisburg, Stockpole
Books, 1960.

UNITED STATES DEPARTMENT OF THE INTERIOR
NATIONAL PARK SERVICE

FOR NPS USE ONLY

RECEIVED MAY 31 1977

DATE ENTERED *Approved 5/23/78*

**NATIONAL REGISTER OF HISTORIC PLACES
INVENTORY -- NOMINATION FORM**

CONTINUATION SHEET

ITEM NUMBER 10

PAGE one

10. GEOGRAPHICAL DATA

UTM References

Map #1 - FREDERICKSBURG

	ZONE	EASTING	NORTHING
A.	18	284760	4242970
B.	18	285250	4243020
C.	18	285240	4242320
D.	18	285520	4242740

Map #2 - FREDERICKSBURG

A.	18	283910	4241460
B.	18	284360	4241450
C.	18	283880	4240840
D.	18	284220	4240820
E.	18	283300	4240530
F.	18	283520	4240540
G.	18	283270	4237500
H.	18	284240	4239000
I.	18	286740	4236440

Map #3 - GUINEA

J.	18	286750	4235210
K.	18	287280	4235870

Map #4 - SALEM CHURCH

A.	18	278620	4240680
B.	18	278930	4240920

UNITED STATES DEPARTMENT OF THE INTERIOR
NATIONAL PARK SERVICE

**NATIONAL REGISTER OF HISTORIC PLACES
INVENTORY -- NOMINATION FORM**

FOR NPS USE ONLY	
RECEIVED	MAY 31 1977
DATE ENTERED	<i>approved 5/23/78</i>

CONTINUATION SHEET

ITEM NUMBER 10

PAGE two

Map #5 - MINE RUN

A.	18	257960	4245420
B.	18	259440	4240080

Map #6 - CHANCELLORSVILLE

C.	18	260950	4246020
D.	18	262680	4240610
E.	18	263180	4243850
F.	18	263880	4241200

Map #7 - CHANCELLORSVILLE

A.	18	264250	4245040
B.	18	264780	4245040
C.	18	263640	4244440
D.	18	265210	4242910
E.	18	265720	4243020
G.	18	263870	4241240
H.	18	265230	4240390
I.	18	265150	4238210
J.	18	265800	4238170

Map #8 - CHANCELLORSVILLE

K.	18	265800	4238170
L.	18	267390	4238190
M.	18	268220	4244520
N.	18	269570	4244500

Map #9 - SALEM CHURCH

O.	18	271450	4242160
----	----	--------	---------

UNITED STATES DEPARTMENT OF THE INTERIOR
NATIONAL PARK SERVICE

FOR NPS USE ONLY	
RECEIVED	MAY 31 1977
DATE ENTERED	approved 5/23/78

**NATIONAL REGISTER OF HISTORIC PLACES
INVENTORY -- NOMINATION FORM**

CONTINUATION SHEET

ITEM NUMBER 10

PAGE three

Map #10 - BROKENBURG

A.	18	269660	4232390
B.	18	269640	4231860

Map #11 - SPOTSYLVANIA

C.	18	271180	4234180
D.	18	273600	4234780
E.	18	273000	4231700
F.	18	274440	4232120

Map #12 - GUINEA

A.	18	285930	4224880
B.	18	286060	4224990
C.	18	286250	4224500
D.	18	286340	4224640

10. Overlapping State or County Boundaries

VIRGINIA	51	ORANGE	137
VIRGINIA	51	CAROLINE	033
VIRGINIA	51	FREDERICKSBURG (CITY)	630

SCALE: 1" = 200'

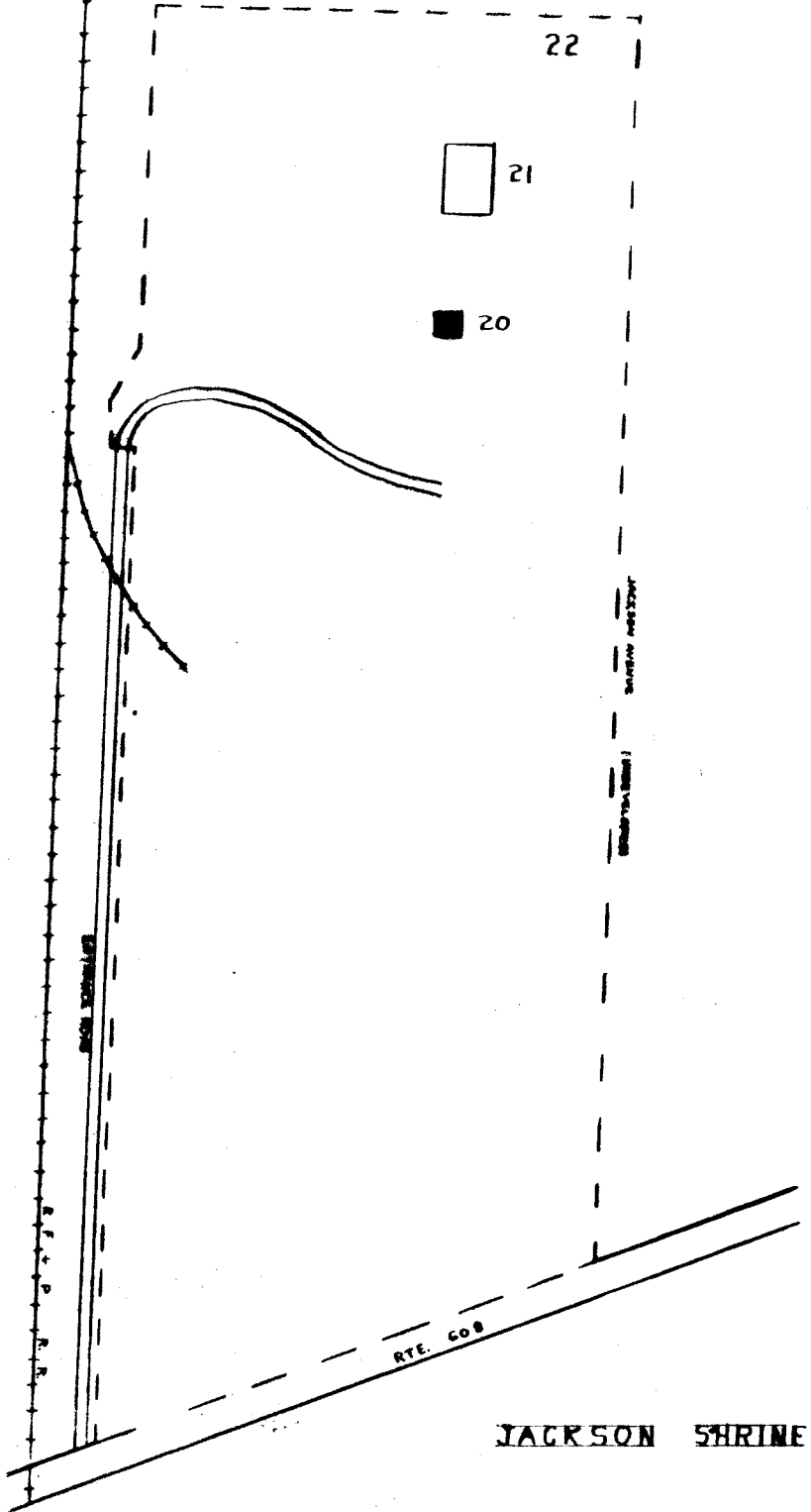

JACKSON SHRINE

FREDERICKSBURG

↑
N
NOT TO SCALE

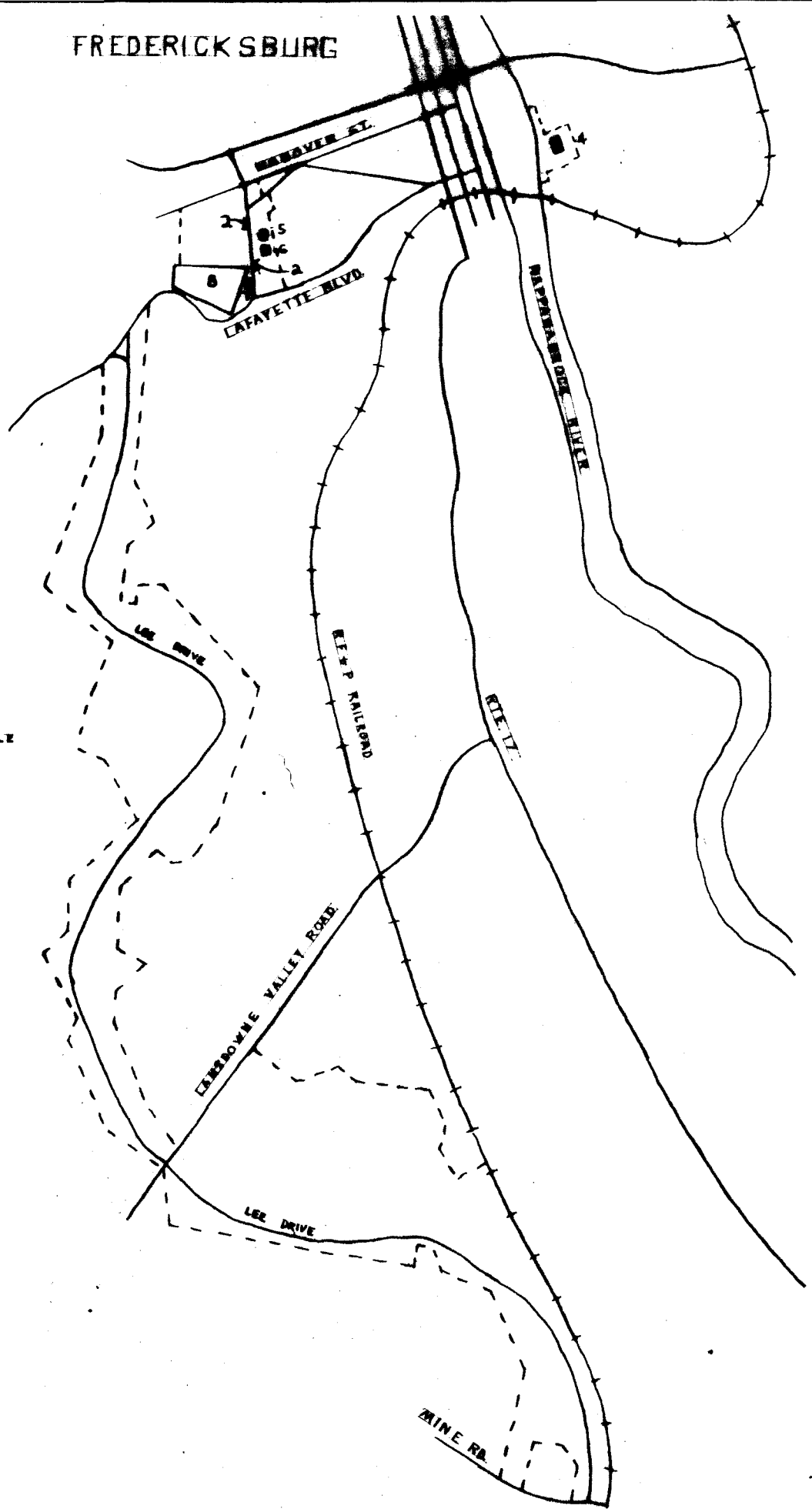

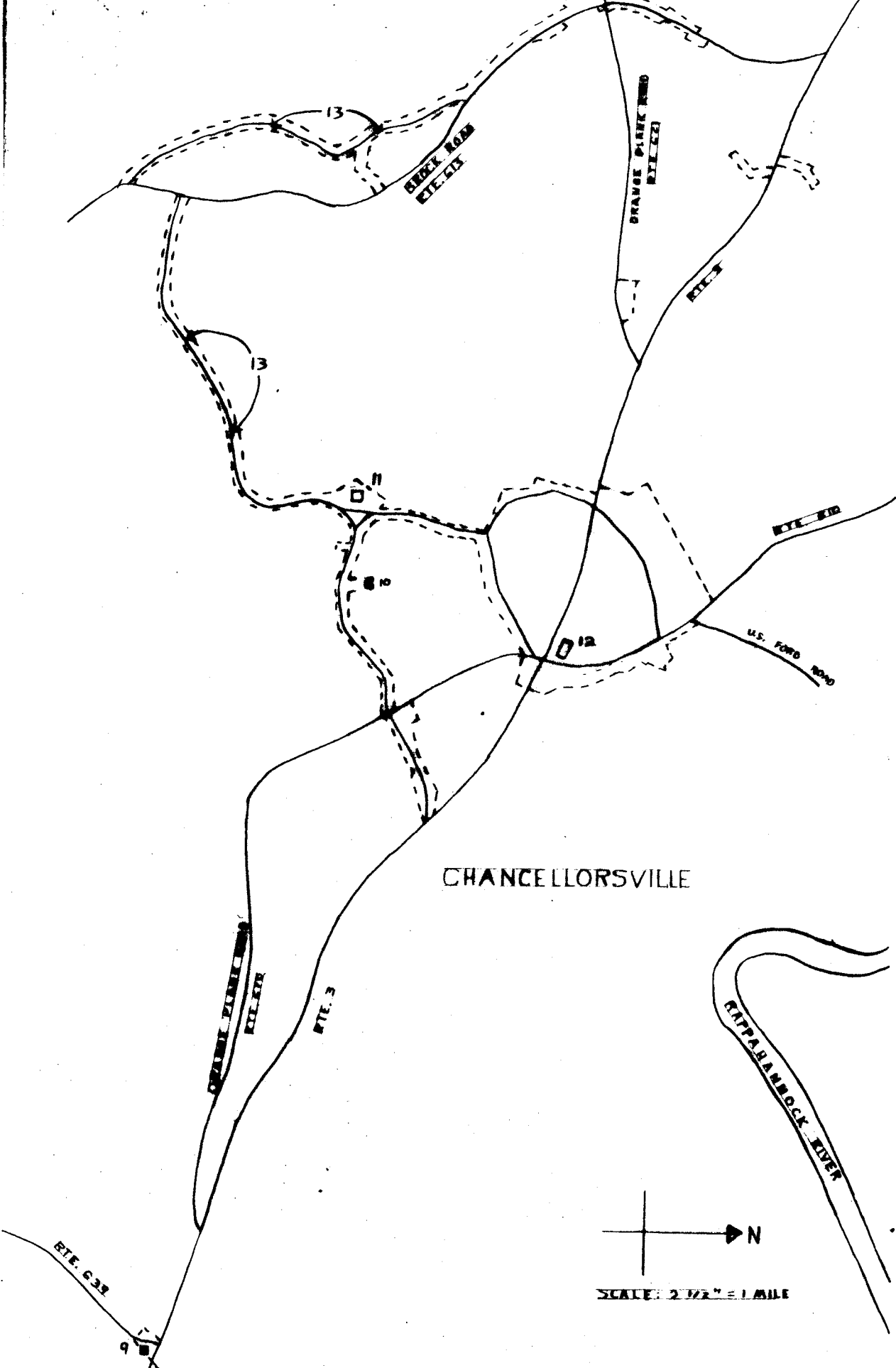

THE WILDERNESS

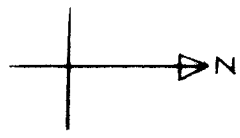

SCALE: 3/4" = 1 MILE

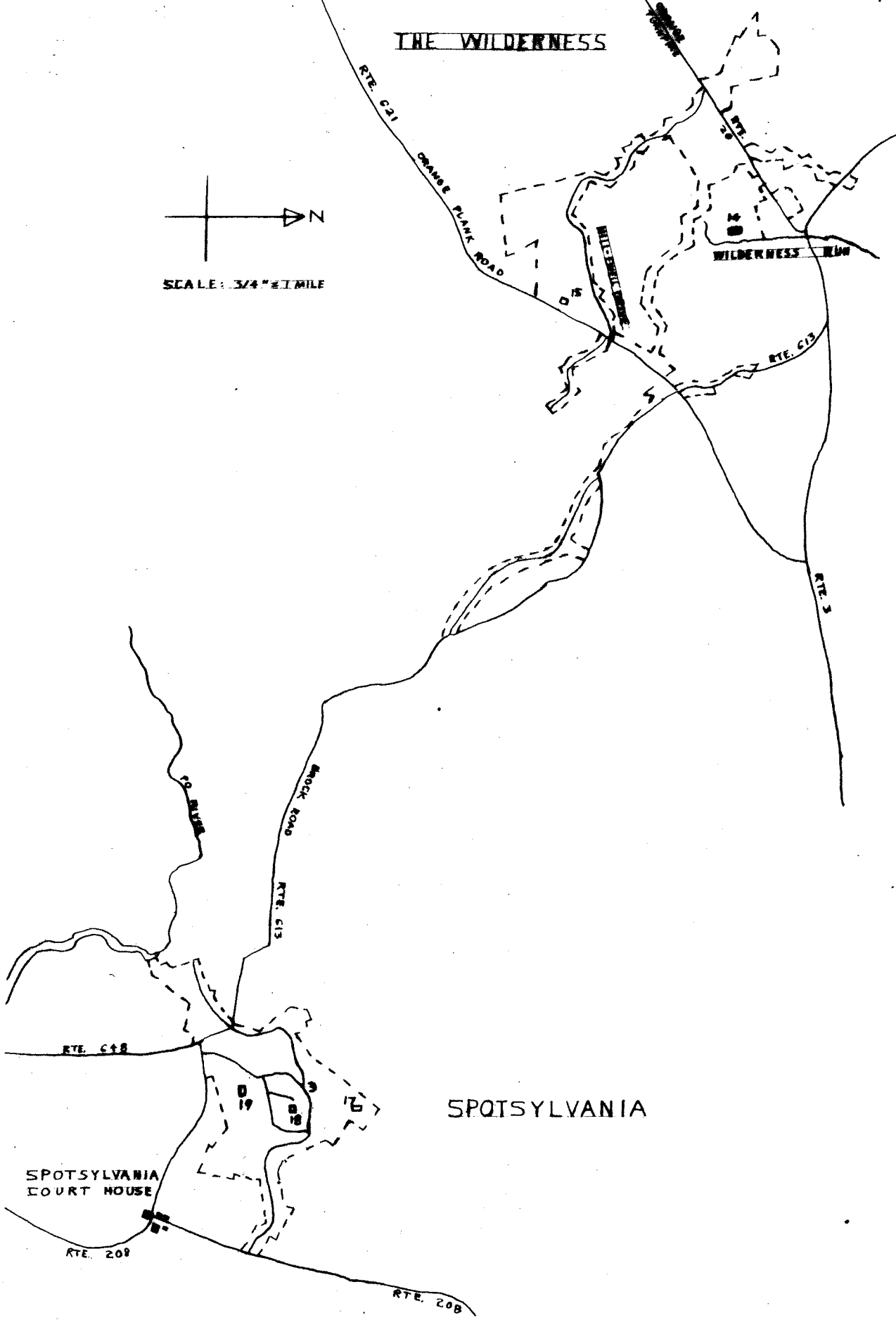

SPOTSYLVANIA

SPOTSYLVANIA COURT HOUSE

RTE. 208

RTE. 208

RTE. 621

GRAND PINE ROAD

WILDERNESS ROAD

RTE. 613

RTE. 3

MOCK ROAD

RTE. 615

RTE. 618

SOUTH RIVER

19

18

17

WILDERNESS CREEK