

VLR-9/9/69 NHL-10/9/60

NATIONAL REGISTER OF HISTORIC PLACES
INVENTORY - NOMINATION FORM

(Type all entries - complete applicable sections)

STATE: Virginia	
COUNTY: Williamsburg (City)	
FOR NPS USE ONLY	
ENTRY NUMBER	DATE

1. NAME

COMMON:
WREN BUILDING

AND/OR HISTORIC:

2. LOCATION

STREET AND NUMBER:
College of William and Mary

CITY OR TOWN:
Williamsburg

STATE: Virginia 23185 CODE: 51 COUNTY: Williamsburg (City) CODE: 830

3. CLASSIFICATION

CATEGORY (Check One)	OWNERSHIP	STATUS	ACCESSIBLE TO THE PUBLIC
<input type="checkbox"/> District <input checked="" type="checkbox"/> Building <input type="checkbox"/> Site <input type="checkbox"/> Structure <input type="checkbox"/> Object	<input checked="" type="checkbox"/> Public <input type="checkbox"/> Private <input type="checkbox"/> Both	Public Acquisition: <input type="checkbox"/> In Process <input type="checkbox"/> Being Considered	<input checked="" type="checkbox"/> Occupied <input type="checkbox"/> Unoccupied <input type="checkbox"/> Preservation work in progress
PRESENT USE (Check One or More as Appropriate)			
<input type="checkbox"/> Agricultural <input type="checkbox"/> Commercial <input checked="" type="checkbox"/> Educational <input type="checkbox"/> Entertainment	<input type="checkbox"/> Government <input type="checkbox"/> Industrial <input type="checkbox"/> Military <input type="checkbox"/> Museum	<input type="checkbox"/> Park <input type="checkbox"/> Private Residence <input type="checkbox"/> Religious <input type="checkbox"/> Scientific	<input type="checkbox"/> Transportation <input type="checkbox"/> Other (Specify) _____ _____ _____
		<input type="checkbox"/> Comments _____ _____	

4. OWNER OF PROPERTY

OWNER'S NAME:
Commonwealth of Virginia

STREET AND NUMBER:

CITY OR TOWN: Richmond STATE: Virginia 23219 CODE: 51

5. LOCATION OF LEGAL DESCRIPTION

COURTHOUSE, REGISTRY OF DEEDS, ETC.
City Hall

STREET AND NUMBER:

CITY OR TOWN: Williamsburg STATE: Virginia 23185 CODE: 51

6. REPRESENTATION IN EXISTING SURVEYS

TITLE OF SURVEY:
HABS

DATE OF SURVEY: 1937-39 Federal State County Local

DEPOSITORY FOR SURVEY RECORDS:
Library of Congress

STREET AND NUMBER:

CITY OR TOWN: Washington STATE: D.C. CODE: 11

SEE INSTRUCTIONS

STATE: Virginia
COUNTY: Williamsburg (City)
ENTRY NUMBER
DATE
FOR NPS USE ONLY

7 DESCRIPTION

CONDITION	(Check One)					
	<input checked="" type="checkbox"/> Excellent	<input type="checkbox"/> Good	<input type="checkbox"/> Fair	<input type="checkbox"/> Deteriorated	<input type="checkbox"/> Ruins	<input type="checkbox"/> Unexposed
	(Check One)			(Check One)		
	<input checked="" type="checkbox"/> Altered	<input type="checkbox"/> Unaltered	<input type="checkbox"/> Moved	<input type="checkbox"/> Original Site		

DESCRIBE THE PRESENT AND ORIGINAL (If known) PHYSICAL APPEARANCE

a. **BACKGROUND INFORMATION:** The first successful college in Virginia and the second in all the English colonies, the College of William and Mary was chartered on February 8, 1693. Middle Plantation (later renamed Williamsburg) was chosen as the site, and the cornerstone was laid in 1695. Designed by Sir Christopher Wren and "adapted to the Nature of the Country by the Gentlemen there," the building was completed in its original form in 1702, when two sides of the proposed quadrangle were finished. Accidentally burned in 1705, the building was subsequently rebuilt, and a third side of the quadrangle was completed in 1732. Twice more, in 1859 and 1862, the building was damaged by fire, with consequent alterations in each reconstruction. When John D. Rockefeller, Jr., undertook its restoration in 1927, only two-thirds of the original wall height remained. Timely discovery of the Bodleian Plate" at Oxford University, depicting several important buildings of 18th century Williamsburg, permitted an authentic restoration of the Wren Building.

One of the largest buildings erected in the English colonies up to that time, the Wren Building was four stories high (including English basement and attic) and 136 feet long. Though begun in the 17th century, its design was proudly of the 18th. The mature Renaissance design incorporates a formal symmetry, with the central axis accented by round-arch portal, balcony, sharp-pitched gable and cupola. Balancing the central axis are uniformly spaced windows and narrow dormers. The north wing, completed at the same time as the front portion, contains the "Great Hall"; the south wing, constructed in 1732, is the chapel. Restoration in 1928 was authentic, with the only alterations being additional stairs and other minor details needed to adapt the building to a continuing academic use. The interior woodwork having been completely destroyed by fire, painstaking research was necessary in order to permit authentic replacement.

b. **BOUNDARIES:** A white picket fence surrounds the (approximate) 2 acres of land which has been reserved for the Wren Building. The acreage is in the shape of a triangle, pointing east--in direct line with the western terminus of Duke of Gloucester Street.

From the junction of Duke of Gloucester Street, Richmond Road, and Jamestown Road (which is at the point of said triangle), proceed in a northwest direction along Richmond Road for about 500 feet; thence south for about 800 feet to Jamestown Road; thence in a northeasterly direction along Jamestown Road for about 500 feet to point of beginning.

Wren Building is located on the western (wide) end of the said triangle and faces east, in the direction of the point of the triangle.

SEE INSTRUCTIONS

8. SIGNIFICANCE

PERIOD (Check One or More as Appropriate)

<input type="checkbox"/> Pre-Columbian	<input type="checkbox"/> 16th Century	<input type="checkbox"/> 18th Century	<input type="checkbox"/> 20th Century
<input type="checkbox"/> 15th Century	<input checked="" type="checkbox"/> 17th Century	<input type="checkbox"/> 19th Century	

SPECIFIC DATE(S) (If Applicable and Known)

AREAS OF SIGNIFICANCE (Check One or More as Appropriate)

<input type="checkbox"/> Aboriginal	<input type="checkbox"/> Education	<input type="checkbox"/> Political	<input type="checkbox"/> Urban Planning
<input type="checkbox"/> Prehistoric	<input type="checkbox"/> Engineering	<input type="checkbox"/> Religion/Philosophy	<input type="checkbox"/> Other (Specify)
<input type="checkbox"/> Historic	<input type="checkbox"/> Industry	<input type="checkbox"/> Science	_____
<input type="checkbox"/> Agriculture	<input type="checkbox"/> Invention	<input type="checkbox"/> Sculpture	_____
<input checked="" type="checkbox"/> Architecture	<input type="checkbox"/> Landscape Architecture	<input type="checkbox"/> Social/Humanitarian	_____
<input type="checkbox"/> Art	<input type="checkbox"/> Literature	<input type="checkbox"/> Theater	_____
<input type="checkbox"/> Commerce	<input type="checkbox"/> Military	<input type="checkbox"/> Transportation	_____
<input type="checkbox"/> Communications	<input type="checkbox"/> Music		_____
<input type="checkbox"/> Conservation			_____

STATEMENT OF SIGNIFICANCE

The restored original building of the College of William and Mary, ascribed to Sir Christopher Wren. Originally built in 1695-1702, it was rebuilt after a fire in 1705.

SEE INSTRUCTIONS

9. MAJOR BIBLIOGRAPHICAL REFERENCES

The Restoration of Colonial Williamsburg in Virginia, reprinted from The Architectural Record, December 1935 (New York, 1935); Hugh Morrison, Early American Architecture (New York, 1952).

10. GEOGRAPHICAL DATA

LATITUDE AND LONGITUDE COORDINATES DEFINING A RECTANGLE LOCATING THE PROPERTY			O R	LATITUDE AND LONGITUDE COORDINATES DEFINING THE CENTER POINT OF A PROPERTY OF LESS THAN TEN ACRES		
CORNER	LATITUDE	LONGITUDE		LATITUDE	LONGITUDE	
	Degrees Minutes Seconds	Degrees Minutes Seconds		Degrees Minutes Seconds	Degrees Minutes Seconds	
NW	° ' "	° ' "		37 ° 16 ' 14 "	76 ° 42 ' 32 "	
NE	° ' "	° ' "				
SE	° ' "	° ' "				
SW	° ' "	° ' "				

APPROXIMATE ACREAGE OF NOMINATED PROPERTY: 2

LIST ALL STATES AND COUNTIES FOR PROPERTIES OVERLAPPING STATE OR COUNTY BOUNDARIES

STATE:	CODE	COUNTY	CODE

11. FORM PREPARED BY

NAME AND TITLE:
Frank S. Melvin

ORGANIZATION: Virginia State Office, National Park Service

DATE: 6/30/72

STREET AND NUMBER:
Box 10008

CITY OR TOWN: Richmond

STATE: Virginia 23240

CODE: 51

12. STATE LIAISON OFFICER CERTIFICATION

NATIONAL REGISTER VERIFICATION

As the designated State Liaison Officer for the National Historic Preservation Act of 1966 (Public Law 89-665), I hereby nominate this property for inclusion in the National Register and certify that it has been evaluated according to the criteria and procedures set forth by the National Park Service. The recommended level of significance of this nomination is:

National State Local

Name _____

Title _____

Date _____

I hereby certify that this property is included in the National Register.

Chief, Office of Archeology and Historic Preservation

Date _____

ATTEST:

Keeper of The National Register

Date _____

SEE INSTRUCTIONS

A.

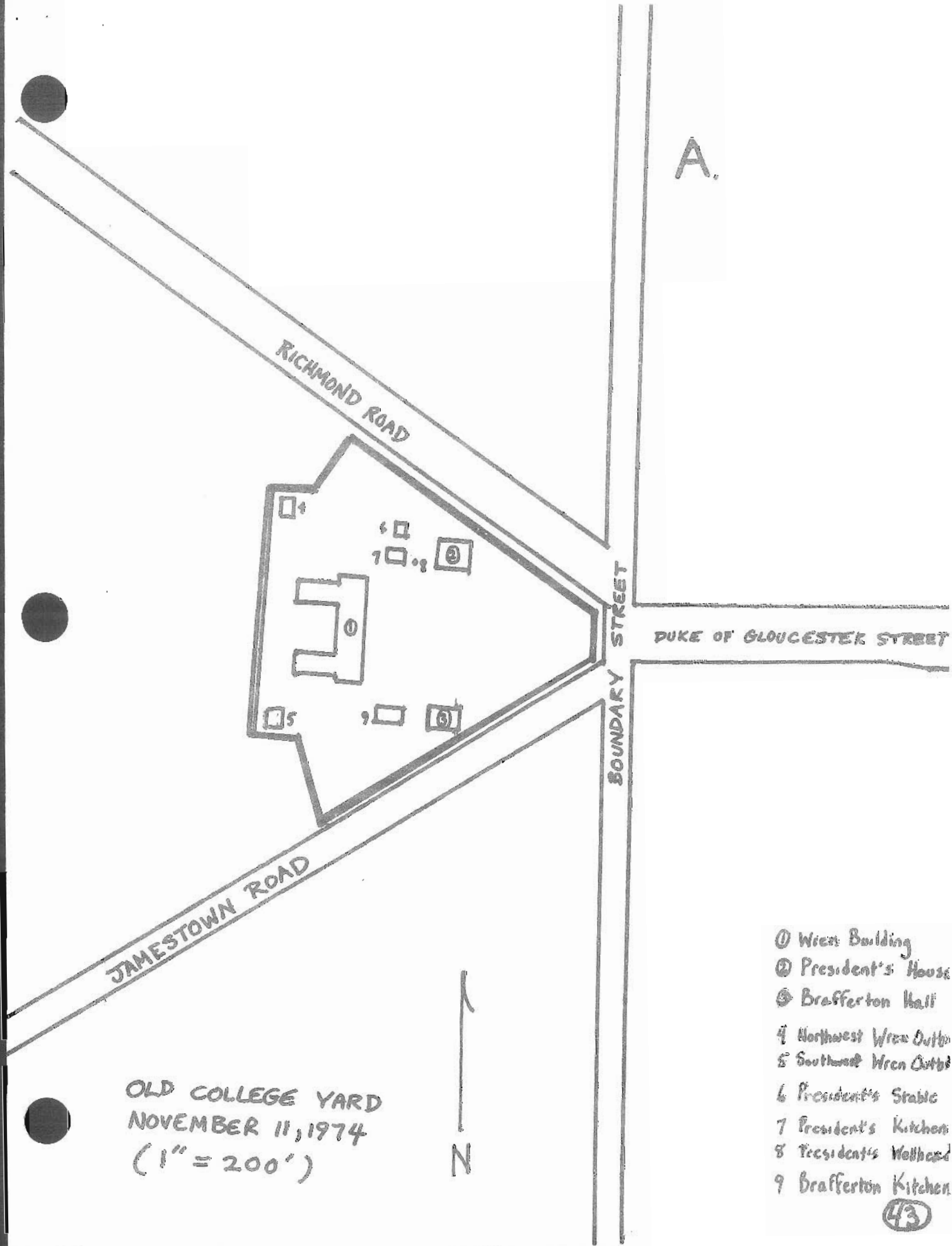

OLD COLLEGE YARD
 NOVEMBER 11, 1974
 (1" = 200')

- ① West Building
- ② President's House
- ③ Brafferton Hall
- ④ Northwest Wren Outbd
- ⑤ Southwest Wren Outbd
- ⑥ President's Stable
- ⑦ President's Kitchen
- ⑧ President's Washhouse
- ⑨ Brafferton Kitchen

(43)

WREN BUILDING, COLLEGE OF WILLIAM AND MARY NATIONAL HISTORIC LANDMARK

UTM REFERENCES:

18 348440 4126060

137-0013

