

(Rev. 10-90)
NPS Form 10-900

United States Department of the Interior
National Park Service

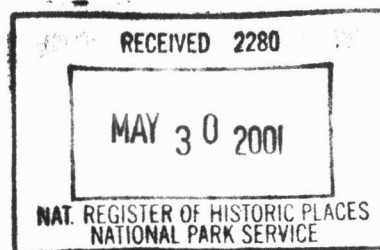

OMB No. 1024-0018

NATIONAL REGISTER OF HISTORIC PLACES REGISTRATION FORM

698

This form is for use in nominating or requesting determinations for individual properties and districts. See instructions in How to Complete the National Register of Historic Places Registration Form (National Register Bulletin 16A). Complete each item by marking "x" in the appropriate box or by entering the information requested. If any item does not apply to the property being documented, enter "N/A" for "not applicable." For functions, architectural classification, materials, and areas of significance, enter only categories and subcategories from the instructions. Place additional entries and narrative items on continuation sheets (NPS Form 10-900a). Use a typewriter, word processor, or computer, to complete all items.

1. Name of Property

Historic name: Chatham Historic District

Other names/site number: DHR File #187-5001

2. Location

Street & number Main, Payne, Pruden, Reid, Whittle, Streets; Lanier Avenue; Court Place; Gilmer Drive
not for publication _____

City or town Chatham vicinity _____ State Virginia Code
VA County Pittsylvania Code 143 Zip 24531

3. State/Federal Agency Certification

As the designated authority under the National Historic Preservation Act of 1986, as amended, I hereby certify that this X nomination _____ request for determination of eligibility meets the documentation standards for registering properties in the National Register of Historic Places and meets the procedural and professional requirements set forth in 36 CFR Part 60. In my opinion, the property X meets _____ does not meet the National Register Criteria. I recommend that this property be considered significant _____ nationally _____ statewide X locally. (_____ See continuation sheet for additional comments.)

William R. Swann May 2, 2001
Signature of certifying official Date

Virginia Department of Historic Resources

State or Federal agency and bureau

In my opinion, the property _____ meets _____ does not meet the National Register criteria. (_____ See continuation sheet for additional comments.)

Signature of commenting or other official Date

State or Federal agency and bureau

4. National Park Service Certification

I, hereby certify that this property is:

✓ entered in the National Register

_____ See continuation sheet.

_____ determined eligible for the

Patrick Andrew 7/13/01

☐ determined not eligible for the National Register
☐ removed from the National Register
☐ other (explain): _____

Signature of Keeper

Date of Action

5. Classification

Ownership of Property (Check as many boxes as apply)

☒ private
☒ public-local
☒ public-State
☒ public-Federal

Category of Property (Check only one box)

☐ building(s)
☒ district
☐ site
☐ structure
☐ object

Number of Resources within Property

Contributing	Noncontributing	
<u>188</u>	<u>44</u>	Buildings
<u>2</u>	<u>0</u>	Sites
<u>0</u>	<u>8</u>	Structures
<u>1</u>	<u>0</u>	Objects
<u>191</u>	<u>52</u>	Total

Number of contributing resources previously listed in the National Register 4Name of related multiple property listing (Enter "N/A" if property is not part of a multiple property listing.) **Virginia**
Diners

U. S. Department of the Interior
National Park Service

Chatham Historic District
Chatham, Virginia

6. Function or Use

Historic Functions (Enter categories from instructions)

Cat: <u>Domestic</u>	Sub: <u>Single Dwelling, Hotel</u>
<u>Commerce/Trade</u>	<u>Business, Financial Institution,</u>
<u>Social</u>	<u>Meeting Hall</u>
<u>Government</u>	<u>City Hall, Courthouse, Post Office,</u>
<u>Religion</u>	<u>Religious Facility,</u>
<u>Recreation and Culture</u>	<u>Theater</u>

Current Functions (Enter categories from instructions)

Cat: <u>Domestic</u>	Sub: <u>Single Dwelling,</u>
<u>Commerce/Trade</u>	<u>Business, Financial Institution</u>
<u>Social</u>	
<u>Government</u>	<u>City Hall, Courthouse, Post Office</u>
<u>Religion</u>	<u>Religious Facility</u>
<u>Recreation and Culture</u>	

7. Description

Architectural Classification (Enter categories from instructions)

Early Classical Revival; Federal; High Victorian Revival;
Queen Anne; Italianate; Beaux Arts; Classical Revival;
Craftsman, Commercial Style; Moderne; Art Deco

Materials (Enter categories from instructions)

Foundation Brick, Concrete,
Roof Metal, Shingle
Walls Brick, Wood,
Other _____

Narrative Description (Describe the historic and current condition of the property on one or more continuation sheets.)

X See continuation sheet

8. Statement of Significance

Applicable National Register Criteria (Mark "x" in one or more boxes for the criteria qualifying the property for National Register listing)

- | | | |
|----------|---|--|
| <u>X</u> | A | Property is associated with events that have made a significant contribution to the broad patterns of our history. |
| ___ | B | Property is associated with the lives of persons significant in our past. |
| <u>X</u> | C | Property embodies the distinctive characteristics of a type, period, or method of construction or represents the work of a master, or possesses high artistic values, or represents a significant and distinguishable entity whose components lack individual distinction. |
| ___ | D | Property has yielded, or is likely to yield information important in prehistory or history. |

Criteria Considerations (Mark "X" in all the boxes that apply.)

- ☒ A owned by a religious institution or used for religious purposes.
- ☐ B removed from its original location.
- ☐ C a birthplace or a grave.
- ☒ D a cemetery.
- ☐ E a reconstructed building, object or structure.
- ☒ F a commemorative property.
- ☐ G less than 50 years of age or achieved significance within the past 50 years.

Areas of Significance (Enter categories from instructions)

Architecture
Commerce
Politics/Government

Period of Significance

1807-1950

Significant Dates

1807
1813
1853

Significant Person (Complete if Criterion B is marked above)

Cultural Affiliation

Architect/Builder

Narrative Statement of Significance (Explain the significance of the property on one or more continuation sheets.)

☒ See continuation sheet

9. Major Bibliographical References

Bibliography (Cite the books, articles, and other sources used in preparing this form on one or more continuation sheets.)☒ See continuation sheet**Previous documentation on file (NPS)**☐ preliminary determination of individual listing (36 CFR 67) has been requested.☒ previously listed in the National Register☐ previously determined eligible by the National Register☐ designated a National Historic Landmark☐ recorded by Historic American Buildings Survey # _____☐ recorded by Historic American Engineering Record # _____**Primary Location of Additional Data**☒ State Historic Preservation Office☐ Other State agency☐ Federal agency☐ Local government☐ University☒ OtherName of repository: Pittsylvania Public Library

10. Geographical Data

Acreage of Property 95 acres**UTM References** (Place additional UTM references on a continuation sheet)

Zone Easting Northing

1 17 643110 40775404 17 642680 4075800

Zone Easting Northing

2 17 643170 40755405 17 642660 4076660

Zone Easting Northing

3 17 642850 40755406 17 642960 4077420☐ See continuation sheet.

Verbal Boundary Description (Describe the boundaries of the property on a continuation sheet.)☒ See continuation sheet **B****Boundary Justification** (Explain why the boundaries were selected on a continuation sheet.)☒ See continuation sheet

11. Form Prepared By

Name/title Alison Stone Blanton, Architectural HistorianOrganization Hill Studio, P.C. date November 2000Street & number 120 West Campbell Avenue telephone 540-342-5263City or town Roanoke state VA zip code 24011

Additional Documentation

Submit the following items with the completed form:

Continuation Sheets**Maps**

A USGS map (7.5 or 15 minute series) indicating the property's location.

A sketch map for historic districts and properties having large acreage or numerous resources.

Photographs

Representative black and white photographs of the property.

Additional items (Check with the SHPO or FPO for any additional items)

Property Owner

(Complete this item at the request of the SHPO or FPO.)

Name See attached sheets

Street & number _____ telephone _____

City or town _____ state _____ zip code _____

=====

Paperwork Reduction Act Statement: This information is being collected for applications to the National Register of Historic Places to nominate properties for listing or determine eligibility for listing, to list properties, and to amend existing listings. Response to this request is required to obtain a benefit in accordance with the National Historic Preservation Act, as amended (16 U.S.C. 470 et seq.).

Estimated Burden Statement: Public reporting burden for this form is estimated to average 18.1 hours per response including the time for reviewing instructions, gathering and maintaining data, and completing and reviewing the form. Direct comments regarding this burden estimate or any aspect of this form to the Chief, Administrative Services Division, National Park Service, P.O. Box 37127, Washington, DC 20013-7127; and the Office of Management and Budget, Paperwork Reductions Project (1024-0018), Washington, DC 20503.

United States Department of the Interior
National Park Service

National Register of Historic Places
Continuation Sheet

Chatham Historic District
Chatham, Virginia

Section 7 Page 1

7. Summary Description:

The Chatham Historic District is located in the historic center of the Town of Chatham, the county seat of Pittsylvania County. Located in Southside Virginia, Chatham is surrounded by a rolling, agricultural terrain rich in tobacco production. The linear district is situated along Main Street (Business Route 29), an historic north-south regional transportation route, known in the early 19th century as the Pittsylvania-Lynchburg Turnpike. Established in 1777 as the county seat, the courthouse was originally located to the west of the present courthouse at the Cherrystone Creek Meeting House Spring. After a dispute over the location of the courthouse in 1807, the town was laid out into 12 lots centering on Main Street and named Competition until 1852 when the name was changed to Chatham in honor of William Pitt, Earl of Chatham. The present Greek-Revival style **Pittsylvania Courthouse**, a National Historic Landmark, was constructed in 1853 and stands along a gentle curve in the street at the center of the district. One- and two-story brick commercial and governmental buildings dating to the late 19th and early- to mid-20th century line Main Street on either side of the courthouse. Beyond the commercial area to the north and south, Main Street becomes residential with churches and schools as well. The approximately 95-acre district consists of 140 contributing primary resources and 21 non-contributing primary resources, including three properties listed on the National Register and Virginia Landmark Register.

The district is composed of relatively-intact town blocks of government, commercial, residential, religious and educational buildings and structures ranging in date from the early 19th Century to the mid-20th Century. Buildings in the district represent a broad range of styles, including Federal, Greek Revival, Gothic Revival, Queen Anne, Colonial Revival, Neoclassical, and Craftsman. The district consists of a total of 245 resources, including 191 (78%) contributing resources and 54 (22%) non-contributing resources. The 191 historic resources include 138 primary buildings, 50 secondary buildings, two cemeteries, and one statue. The 52 non-historic resources include 21 primary buildings, 23 secondary buildings, and eight secondary structures. Many of the predominately two-story brick commercial buildings in the district retain their original first-floor storefronts and the majority of the residential structures survive with little alteration. Thus the district maintains a high level of historic integrity. The few non-contributing buildings in the district are those that maintain little of their historic integrity and have been irreversibly altered or those built after 1950.

United States Department of the Interior
National Park Service

National Register of Historic Places
Continuation Sheet

Chatham Historic District
Chatham, Virginia

Section 7 Page 2

Historic Development and Architectural Analysis

Colony to Nation (1750-1789)

The first court of present-day Pittsylvania County, established in 1777, was held at the Cherrystone Creek Meeting House to the west of the district. In 1782, the first courthouse was constructed to the east on a hill overlooking the original location. This red brick structure with white columns stood at the approximate site of the present **Chatham Clerk's Office and Judge Tredway House, 16 Court Place (187-5001-0160)** and served the county for nearly 70 years. The **Tunstall-Hargrave House, 7 Court Place (187-5001-0158)**, perhaps the oldest building in the Chatham Historic District, survives from this early courthouse settlement period. The core of the present building was built in 1782 as the home of Richard Johnson, who donated land for the courthouse. After numerous alterations over the years, including a wraparound Victorian porch, the house has been restored to its simple Colonial appearance with its symmetrical design and full-height portico.

Early National Period (1789-1830)

This period marked a shift in the development of the town from the area overlooking Cherrystone Creek Bottom (present-day Court Place and Whittle Street) to Main Street. After a controversy over the location of the 1782 courthouse, the General Assembly declared the location valid and directed that eight acres south and east of the courthouse be laid out into a grid system of 12 lots centering on present-day Main Street, an early stagecoach road. The town was to be called Competition, in reference to the dispute. The **Chatham Clerk's Office (187-5001-0160)**, located behind the Judge Tredway House at 16 Court Place, was constructed in 1813 and survives in part to represent the early courthouse complex. The majority of the building has been reconstructed from original plans. It now houses a small museum with Revolutionary and Civil War artifacts.

Antebellum Period (1830-1860)

By 1840 Pittsylvania County ranked second to Henrico County in population figures with 26,398 inhabitants and this growth is reflected in the development of the town of Competition, which was renamed Chatham in 1852. Main Street continued to be the primary thoroughfare and several taverns and stores located along this early roadway. Although none of these early 19th century commercial establishments survive, the pattern of development along Main Street they established is still evident today. Most significant to the development of the town was the construction in 1853 of the new **Pittsylvania Courthouse, 1 North Main Street (187-5001-0092)**. Designed by L.A. Shumaker, it combines the classical form and detailing of the traditional Greek-Revival style with the newly-popular Italianate style in the addition of a cupola. Sitting high on a raised basement,

United States Department of the Interior
National Park Service

National Register of Historic Places
Continuation Sheet

Chatham Historic District
Chatham, Virginia

Section 7 Page 3

this one-story brick building with Doric portico continues as an architectural landmark and centerpiece to the town and the historic district.

Several large residences were established during this period on the outskirts of the town limits. These houses were located on large tracts of land that related more to the topography than to the grid system of the new town. Rural rather than urban in character, these dwellings were surrounded by a number of dependencies as well as open fields for pasture. The **Oaks (187-5001-0118)** was built in 1832 by Dr. Robert Coles at 215 Gilmer Drive, just off Main Street. This three-bay, two-story frame structure is simple in design with a central-passage, single-pile plan, side-gable roof and exterior end chimneys. The projecting central bay and full-width porch are later modifications. In 1845, Coles sold the house to George Gilmer, a Chatham lawyer, for whom the street is named. Directly across Main Street stands the 1840s **Dr. Richard White House, 216 North Main Street (187-5001-0011)**, home of a colleague of Dr. Coles. This frame house, which is similar in siting to **The Oaks**, originally consisted of the two east bays with the side gable roof and exterior end chimney. Most notable about this property is the survival of a log kitchen located directly behind the main house. The 1840s **Dr. Richard White Kitchen, 228 North Main Street (187-5001-0010)** stands on a separate lot now with a 1930s residence facing onto Main Street.

At the southern end of town stands **Morea, 42 Franklin Place (187-5001-0061)**, constructed in 1837 as Oak Hall by the architect and merchant John Poindexter. This two-story, five-bay, Federal-style dwelling has been restored to its original appearance with the side-gable roof with modillioned cornice and pedimented entry porch. A number of contributing buildings surround the main house, including a one-and-a-half story frame school and office building, a chicken coop, and a springhouse. The 1835 **Hugh Weir House, 25 Lanier Avenue (187-5001-0129)** is the only brick residence from the early 1800s. This two-story, three-bay dwelling features typical Federal-style elements, including six-over-nine sash windows, elliptical fanlight transom over the door, and ocular windows in the gable ends. Situated sideways to Lanier Avenue, the house originally fronted North Main Street with extensive front gardens.

Two residences on Reid Street dating from the 1850s illustrate the popularity of the Greek-Revival and the Gothic-Revival styles in domestic design. The **Rison-Hairston House, 235 Reid Street (187-5001-0153)** stands as a good example of the Greek-Revival style with temple-front portico and simple rectangular transom and sidelights surrounding the double-leaf entrance. The **Fairytale Cottage, 125 Reid Street (187-5001-0154)** was constructed in 1851 by Chatham Hall professor Griffin D. Neal as a wedding present for his bride (Clement 1957:21). This excellent example of the Carpenter Gothic style features steeply pitched, gabled dormers with decorative vergeboards.

United States Department of the Interior
National Park Service

National Register of Historic Places
Continuation Sheet

Chatham Historic District
Chatham, Virginia

Section 7 Page 4

Reconstruction and Growth (1865-1914)

Following the Civil War, the town of Chatham was incorporated in 1874 and its boundaries extended three quarters of a mile from the courthouse in all directions. With the completion of the Virginia Midland Railroad to Chatham in the 1870s, Chatham became a transport station for the valuable agricultural products of the region. With this boost to the economy spurred by the railroad, the commercial district of Chatham began to grow. Of the 161 primary buildings in the district, 43% were constructed during this period.

The commercial buildings, which continued to line Main Street on either side of the courthouse, are typically two stories in height and of brick construction. The **Planter's Bank/Shepherd's Store, 10 North Main Street (187-5001-0031)** and **Whitehead's Store, 11 Sout Main Street (187-5001-0090)**, both built at the turn of the century, are good examples of the typical two-story, three-bay form with a central, recessed entrance and decorative wood cornice at the storefront and parapet. The central, round-arched element of the parapet at the **Planter's Bank** helps to distinguish it from the other commercial buildings and is echoed in the round-arched windows and the arcade at street level. The angled stone piers and recessed storefront accentuate the curvature of the road at this point on Main Street. Larger commercial buildings from this period include two storefronts flanking a central entrance to the upper floors. The ca. 1895 **Commercial Building, 20-24 North Main Street (187-5001-0028)** maintains the segmental-arched windows and corbelled brick cornice that were typical of late-19th century commercial buildings. The **Thompson's Drug and Haberdashy Building, 14-16 North Main Street, (187-5001-0029)**, with its simple cornice, recessed panels, and square-headed sash windows, is a slightly more modernized commercial building from the same period.

Four of the six churches in the district date to this period of Chatham's development. Three of these churches were established in the first half of the 19th century, with the new buildings constructed to house larger congregations. **Corinth Christian Church, 135 Reid Street (187-5001-0151)** was constructed for an early black congregation formed after the Civil War. All four of these ecclesiastical structures are designed in the Gothic-Revival style and feature the simple rectangular nave plan with gable front and corner tower or belfry. **Emmanuel Episcopal Church, 66 North Main Street (187-5001-0022)**, was constructed in 1881 to replace the earlier 1844 church on the same site. This yellow brick church is designed in the Gothic-Revival style with a steep gabled roof echoed in the gabled belfry and corner buttress. The building features a cross-gable with apse at the rear and a tripartite, stained-glass Tiffany window on the front façade. The 1886 **Chatham Presbyterian Church, 128 North Main Street (187-5001-0016)**, presents a different interpretation

United States Department of the Interior
National Park Service

National Register of Historic Places
Continuation Sheet

Chatham Historic District
Chatham, Virginia

Section 7 Page 5

of the Gothic-Revival style with its jerkin-head roof, pyramidal belfry, and corbelled brickwork at the cornices. A one-story, polygonal addition was constructed on the north side in 1987. The **Chatham Baptist Church, 12 Court Place (187-5001-0159)** was constructed in 1889 with funds and land donated by the Hargrave family. This two-story brick church is an example of the Perpendicular Gothic-Revival style with its buttressed walls and soaring spire atop the belfry. A Sunday school wing was added to the rear of the church in the early 20th century and a large new fellowship hall has been added recently. The **Corinth Christian Church, 135 Reid Street (187-5001-0151)** was constructed for an African-American population soon after the Civil War. This small frame church, which has been covered with brick veneer, was also designed in the popular Gothic-Revival style with its pointed-arch windows and doors and the two crenellated corner towers.

The majority of the buildings in the district dating from this period are domestic. The dominant style of the period is the Queen-Anne style and the majority of the buildings are of frame construction. A notable exception to this popular trend is the 1874 **Laird-Whitehead House, 335 South Main Street (187-5001-0064)**, with its symmetrical design in the late Greek-Revival style. The Neoclassical portico with colossal Ionic columns was added in 1910.

Several high-style examples of the Queen-Anne style can be seen in the residences along Main and Reid streets. The largest and most elaborate of these resources is the 1870s **Scruggs House (187-5001-0156)** on Reid Street. This expansive frame dwelling is two-and-a-half stories with an intersecting hip-and-gable roof with chimney pots and a central tower with integral porch. Pedimented gables and dormers feature Palladian windows with diamond-patterned lights. The nine-bay wraparound porch extends across the front with a pedimented entry bay and a corner turret. A spindlework frieze and turned balustrade detail this porch as well as an integral porch on the second story. The ca. 1880s **Hunt-Hodgins House, 124 North Main Street (187-5001-0017)**, features cornice brackets and a polygonal bay with an open porch on the second story. A number of the Queen-Anne style dwellings of the period feature corner turrets, such as the ca. 1890s **House, 22 Whittle Street (187-5001-0161)** and the ca. 1900 **M.C. Plaster House, 301 South Main Street (187-5001-0067)** with its bell-shaped turret. The turret form is also found at the corners of wraparound porches, as in the ca. 1900 **Asa Hodnett House, 237 South Main Street (187-5001-0068)**.

An excellent example of the Queen-Anne style is the **Canada-Melton House, 270 North Main Street (187-5001-0002)** at the northern end of this district. This ca. 1875 frame dwelling features many of the typical Queen-Anne style elements such as the stepped façade with intersecting hip-and-gable roof, polygonal bays, and the curved wraparound porch with spindlework frieze, turned

United States Department of the Interior
National Park Service

National Register of Historic Places
Continuation Sheet

Chatham Historic District
Chatham, Virginia

Section 7 Page 6

columns, scrollsawn brackets, and turned balustrade. The windows feature tracery in the upper sashes. Colonial-Revival influences on this design include the pedimented gables with tripartite windows and the denticulated cornice. **The Judge Coles House/The Columns, 214 South Main Street (187-5001-0054)**, built in 1897, also represents the transition from the Queen Anne to the Colonial-Revival style as its complex form with various rooflines, polygonal bays, and wraparound porch is detailed with pedimented gables, Ionic columns, a modillioned cornice, and an elliptical fanlight. A simpler version of this transitional style can be seen in the **House, 21 Lanier Street (187-5001-0130)**. This modest, two-story frame dwelling features a stepped façade with intersecting-gable roof, molded cornice, and gable returns.

A number of one-story Queen-Anne style dwellings are also found throughout the district. One of the simpler examples is the one-story cottage form with hip roof at the **Henry Bolanz House, 65 North Main Street (187-5001-0099)**. A spindle work frieze and turned columns and balustrade detail the three-bay porch that extends across the front. More typical is the one-story, “L”-shaped dwelling with intersecting-gable roof, such as the ca. 1890s **Bess Tredway House, 26 Whittle Street (187-5001-0162)**, with Queen-Anne style detailing in the porch. Polygonal bays are added to this form in the two turn-of-the-century examples of the **Sours Rental Cottage #1, 245 North Main Street (187-5001-0113)** and the **Sours Rental Cottage #2, 253 North Main Street (187-5001-0114)**. The inherent variety of the Queen-Anne style can be seen in the subtle differences of these two adjacent dwellings.

World War I – World War II (1914-1945)

The population boom Chatham experienced in the first two decades of the 20th century resulted in a marked growth in the town with the number of developed lots doubling during this period. With this growth, the town’s infrastructure improved as well with the construction of two new governmental buildings and two schools. The post office was given a permanent home with the construction of the simple, one-story Colonial-Revival style **United States Post Office, 31 South Main Street (187-5001-0083)** in the 1930s with its WPA mural on the interior. The large, two-story brick **Moses Building, 11 North Main Street (187-5001-0093)**, attests to the growth of the local government as it provided expanded space for town and county offices. Classical-Revival detailing in the projecting end bays with corner quoins and deep attic cornice help to minimize the expanse of the building.

The construction of two new schools during this period reflects the growth of the town as well as the progress in educational facilities throughout the state in the early 20th century. The 1924

United States Department of the Interior
National Park Service

National Register of Historic Places
Continuation Sheet

Chatham Historic District
Chatham, Virginia

Section 7 Page 7

Chatham High School (187-5001-0139) on Pruden Street is a mixture of early 20th century stylistic influences combined with the typical school design details such as a recessed entry, broad expanses of windows, and solid brick walls. Classical detailing is seen in the arched entrance and the raised attic level for the auditorium space. The influence of the Colonial-Revival style is more straightforward in the 1925 **Chatham Elementary School, 319-323 South Main Street (187-5001-0065)**, with its two-story, rectangular brick form and side gable roof with dormers and gabled parapet at the ends of the central block. A classic broken pediment surrounds the main entrance. The library building, which is now attached by a covered walkway, is also an excellent example of the Colonial-Revival style with its one-and-one-half story brick form with brick corner quoins and gabled roof with dormers, exterior end chimneys, and classical cornice with modillions.

The majority of the commercial buildings in the district date from this period of growth. Three banks were constructed along Main Street in the 1920s prior to the Depression. These prominent buildings, two of which are located on corners adjacent to the Courthouse, are all designed in the Classical-Revival style. The **Planters Bank and Trust, 2-4 North Main Street (187-5001-0033)**, and the **Chatham Savings Bank, 1-9 South Main Street (187-5001-0091)** both feature a temple front with a recessed entry topped by a pedimented gable with modillions and a simple entablature supported by pilasters and columns. Although it lacks the temple front with pedimented gable, the **First National Bank, 25 South Main Street (187-5001-0085)** is similar with its recessed entrance and classical stone entablature supported by brick pilasters. Other commercial buildings designed in the Colonial-Revival style include the ca. 1915 **Elliott's Hardware Store, 21 South Main Street (187-5001-0086)**, and the ca. 1925 **Overby's Hardware, 18 South Main Street (187-5001-0039)**. These two-story brick buildings feature a modillioned cornice and brick quoins. Keystones top the arched and square-headed windows. Two prominent Colonial-Revival style buildings with commercial space on the ground floor include the ca. 1900 **Masonic Temple, 61 North Main Street (187-5001-0098)** and the ca. 1925 **Collie Hotel/William Pitt Hotel, 27 South Main Street (187-5001-0084)**.

The Commercial style also influenced buildings in the district during this period. This simple, straightforward design as seen in the **Whitehead's General Store/Movie Theater, 24-26 South Main Street (187-5001-0041)**, relies on corbelled brickwork to detail the utilitarian façade rather than stylistic references. Another more utilitarian commercial building is the 1920s **Chatham Knitting Mill, 119 South Main Street (187-5001-0078)**, with its simple rectangular form with gable roof, numerous windows on all elevations to provide light, and wide loading door. This is the only industrial building in the district.

United States Department of the Interior
National Park Service

National Register of Historic Places
Continuation Sheet

Chatham Historic District
Chatham, Virginia

Section 7 Page 8

The rise of the automobile in the first half of the 20th century introduced three new building types that are represented in the district: the automobile dealer, the service station, and the streetcar diner. The **Gammon Motor Company, 115 South Main Street (187-5001-0079)** was constructed in 1923 as an Oldsmobile, Essex, Hudson, and Republic Trucks dealership. This building, which originally featured a molded cornice and two-over-two wood sash windows, has been extensively remodeled with the cornice removed and the windows replaced with two banks of metal sash windows. The building continues to be used as an automobile repair shop and retains its characteristic porte-cochere across the front. The ca. 1930 **Hunt Moter Company, 30 South Main Street (187-5001-0043)**, is another early car dealership. The **Sours Garage, 301 North Main Street (187-5001-0116)**, constructed in the 1920s at the northern end of the district, is an excellent surviving example of an early service station. This trapezoid-shaped building takes full advantage of its location on the diagonal intersection of two streets with a porte-cochere extending across the front to provide easy access from both directions. This intact building features exposed rafters and original wood storefronts with painted signage advertising the automobile services as well as grocery items offered for sale.

Two of the most notable resources in the district from this period are two ca. 1920s streetcars that were converted to diners in the 1940s after the demise of the street railway systems throughout the country. The ca. 1923-1927 **Bill's Diner/Streetcar Named Desire, 1 Depot Street (187-5001-0044)** originally provided streetcar service in Reidsville, North Carolina before that service was discontinued and the single-track car was converted to a diner in 1938 by William Lewis Fretwell. The ca. 1920s **Burnett's Diner/Main Street Café, 19 South Main Street (187-5001-0087)**, was originally built as a double-truck streetcar by the Perley A. Thomas Car Company of High Point, North Carolina and served as the Danville Traction and Power Company Car No. 66 until its retirement ca. 1939. The Burnett brothers purchased the streetcar and converted it to a diner in the 1940s. These sleek, utilitarian structures were similar in design to the prefabricated lunch wagons of the 1920s and offered an inexpensive alternative for semi-mobile restaurants during the Depression era. Both of these streetcars are listed on the Virginia Landmark Register and the National Register.

While much of the new growth during this period occurred in the commercial sector of the district, a total of 23 domestic buildings were constructed in the period between 1917 and 1945. As with the commercial buildings, the Colonial-Revival style was the most popular for new residences. The ca. 1920 **Overby House, 144 North Main Street (187-5001-0013)** is a typical two-story, three-bay frame example of a Colonial-Revival style dwelling with dormered hip roof

United States Department of the Interior
National Park Service

National Register of Historic Places
Continuation Sheet

Chatham Historic District
Chatham, Virginia

Section 7 Page 9

and full-width porch with pedimented entry bay. The ca. 1925 **Coles-Fitzgerald House, 121 North Main Street (187-5001-0105)**, is a more formal interpretation of the style with broken-pediment door surround and leaded glass transom and sidelights. The **House, 230 South Main Street (187-5001-0056)** illustrates the Craftsman influence on the Colonial-Revival style with wide eaves supported by paired brackets combined with the symmetrical, hip roof form with pedimented entry porch. While not predominant, a few Craftsman-style bungalows exist in the district. The ca. 1925 **Dave Jefferson House, 209 South Main Street (187-5001-0072)** is an excellent example of this mid-20th century domestic style.

Only one church in the district dates to this period, the **Chatham Christian Church, 135 South Main Street (187-5001-0076)**. This church was established in 1847 and the present structure is the third church on the site. This simple, rectangular brick church with gable roof is Jacobean in style with the stepped parapet, sandstone detailing, and grouped windows.

The New Dominion (1945-present)

Only two contributing buildings in the district date from this period and both structures illustrate the use of new materials in the mid-20th century. The ca. 1945 **Movie Theater, Pruden Street (187-5001-0138)** utilizes a Quansant hut for its main body. A concrete-block façade with stylized end pilasters has been constructed at the front entrance. A curved retaining wall at the entrance steps accentuates the curved form of the Quansant hut. The ca. 1950 **Beauty Plaza, 25 Pruden Street (187-5001-0143)** features a two-toned, glazed brick façade that is unique to the district.

United States Department of the Interior
National Park Service

National Register of Historic Places
Continuation Sheet

Chatham Historic District
Chatham, Virginia

Section 7 Page 10

INVENTORY

187-5001-0001	1940 ca	Contributing Building
300 North Main	Express Station	

This one story concrete block commercial building has a flat roof, two garage bays with roll-up doors, a single aluminum and plate glass door flanked on either side by a plate glass window sheltered by metal shed roof overhang. The corner that addresses the traffic intersection is rounded. The side window is a fixed metal twelve light window with a center pivot.

187-5001-0002	1875 ca	Contributing Building
270 North Main Street	Canada, W.T., House	Contributing Building
	Melton, H., House	

This is a two story frame residential building with an intersecting hipped roof and front gable. The pedimented gable end has a tripartite window over a three sided bay. The porch is an open wraparound porch with a hipped roof and pedimented gable front supported by turned columns. It has a spindle work frieze and balustrade; there are dentils in the pediment and in the cornice. The central door has a decorative surround and a 2-light segmented arch transom. This is a frame shed with a gable roof. There is a frame shed to the rear of the house.

187-5001-0003	1930 ca	Contributing Building
262 North Main Street	Tom Gray House	Contributing Building
	Adcock, L., House	Contributing Building
		Contributing Building
		Contributing Building

This is a one story frame building with a side gable roof and a side gable porch with paired square columns and a turned balustrade. The central entry has an arched overhang supported on knee braces over the brick stoop. There is a two-story frame dwelling with side gable roof at the rear with of the property. There are two frame garages with gable roof behind the house. There is a frame shed at the rear of the property.

187-5001-0004	1890s	Contributing Building
256 North Main Street	Crews, T., House	Contributing Building

This is a two story frame building with an intersecting gable roof. There is a pedimented gable with

United States Department of the Interior
National Park Service

National Register of Historic Places
Continuation Sheet

Chatham Historic District
Chatham, Virginia

Section 7 Page 11

shingles and a polygonal bay with a three peaked roof with singles in the gable ends. The on story porch has a hipped roof with pedimented gable over the entry; it has a spindle work frieze, turned columns with scroll brackets. The balustrade has a grid pattern. This is a frame shed with gable roof and weatherboard siding. The shed is located behind the house.

187-5001-0005	1890s	Contributing Building
252 North Main Street	Fuller, T., House	Contributing Building

This is a two story, frame residential building with a one story wraparound porch. The porch has fluted columns and a turned balustrade; there is a corner bay. The off-center door has a 2-light rectangular transom and applied decorations. The garage is to the rear of the house.

187-5001-0006	1890s	Contributing Building
246 North Main Street	Haley, G., House	

This is a two story frame residential building with an intersecting hipped roof and front gable. The first and second story of the front gable is a bay with central paired windows on both stories. The porch has a spindle frieze, turned columns with brackets, and a scroll sawn balustrade. The door has a four light transom and three light sidelights.

187-5001-0007	1900 ca	Contributing Building
242 North Main Street	Dabney House	
	McDole, J., House	

This is a one story frame residential building with a side gable roof; there is a pedimented gable on the side. The central door is framed by two 6/1 double hung sash windows. The one story three bay porch has slender paired round columns and a square balustrade.

187-5001-0008	1890s	Contributing Building
238 North Main Street	Price, J., House	

This is a two story frame residential building with an intersecting hipped roof and gable front. The one story four bay porch has a turned balustrade and round columns supporting a hipped roof. The central door has an oval light.

United States Department of the Interior
National Park Service

National Register of Historic Places
Continuation Sheet

Chatham Historic District
Chatham, Virginia

Section 7 Page 12

187-5001-0009	1925 ca	Contributing Building
232 North Main Street	Vickrey, G., House	

This is a one story frame residential building with a flared hipped roof and three dormer windows. The central door has a seven-light transom and four-light sidelights; it is flanked on either side by paired 1/1 double hung sash windows with shutters. The three bay porch has square columns and balustrade.

187-5001-0010	1840s	Contributing Building
228 North Main Street	White, Dr. Richard, Kitchen	Contributing Building
	Thomas Cabin	

One-story, 2-bay log kitchen with 6/6 sash window beside single leaf wood board door. Weatherboard siding, gable metal roof. Random rubble chimney and foundation. A ca. 1930, 1-1/2 story brick Colonial Revival dwelling stands at the front of the property.

187-5001-0011	1840s	Contributing Building
216 North Main Street	White, Dr. Richard, House	Contributing Building
	Hurt, R., House	

This is a two story frame residential building with a central gable. It has a one story, three bay porch with lattice work and turned columns. There is a pitched roof shed at the end of the driveway.

187-5001-0012	1919	Contributing Building
202 North Main Street	Dr. Langhorne Whitehead House	

This is a two story frame residential building with a one story hipped roof porch, with exposed rafter tails, supported on paired square columns on a brick base. The porch has a square balustrade. On the first floor there is a central door with a crosslight and a five light rectangular transom between one fixed single light window and one double hung 10/1 sash window. On the second floor there are three 6/1 double hung casement windows below the central dormer with two fixed 6 light windows.

187-5001-0013	1920 ca	Contributing Building
144 North Main Street	Overbey, C., House	Contributing Building

This is a two story, Craftsman style frame residential building with a one story porch. The porch has

United States Department of the Interior
National Park Service

National Register of Historic Places
Continuation Sheet

Chatham Historic District
Chatham, Virginia

Section 7 Page 13

a central projecting pedimented gable supported on paired square columns on a solid frame wall. On the first floor, to the left of the central door is a slightly projecting bowed 5-sided bay with Craftsman detailing in the upper sash. This motif is repeated on all the windows on the façade. There is a one story garage to the rear of the house.

187-5001-0014	1997	Non-Contributing Building
136 North Main Street	Watson Memorial Church	

This brick church was recently reconstructed on the site of the historic structure.

187-5001-0015	1970s	Non-Contributing Building
132 North Main Street	Methodist Parsonage	

This two-story brick structure with gable roof reflects the Colonial Revival style with minimal detailing.

187-5001-0016	1886 ca	Contributing Building
128 North Main Street	Chatham Presbyterian Church	

This brick church building has a jerkinhead roofed nave, pointed arch/pedimented gable roof portico, pyramidal roof corner tower, and a polygonal side apse addition. The portico nave, and tower have corbelled brick detail and pointed arch openings. The main entrance is the double leaf, panelled wood door with stained glass pointed arch transom windows in the base of the tower; it has paneled reveals and applied buttresses. There is a single leaf wood door with pointed arch stained glass transom in the portico. There is a central pointed arch stained glass window in the nave below a round rose window.

187-5001-0017	1880s	Contributing Building
124 North Main Street	Hunt-Hodgins, C., House	

This is two story (plus attic) frame residential building. In the front gable there are decorative shingles, a projecting second story open porch with a balustrade, turned columns, and paneled frieze above a polygonal bay. The porch has a balustrade, square columns, and scroll sawn brackets and chamfered corners. At the second story roofline there is turned spindlework. There is a louvered dormer; the chimneys are corbelled with panelled stacks.

United States Department of the Interior
National Park Service

National Register of Historic Places
Continuation Sheet

Chatham Historic District
Chatham, Virginia

Section 7 Page 14

187-5001-0018	1945 ca	Contributing Building
118 North Main Street	Jones, J., House	Contributing Building

This is a two story brick residential building. There is a central single leaf door with 3 light, one panel sidelights and a fanlight with keystone. This is a vertical board shed with steep gable asphalt shingle roof. There is a shed to the rear of the building.

187-5001-0019	1920s	Contributing Building
112 North Main Street	Carter-Jones House	Non-contributing Building

This is a two story masonry residential building with a central portico. The portico has a flat roof with wide eaves supported on corner piers and Doric columns; it has a turned balustrade on the sides. The door surround has an entablature supported on Doric pilasters. There are also 10 light sidelights. On the first floor there are two double hung sash 8/8 windows; on the second story there is a central tripartite double hung sash window with a 4/4 by 6/6 by 4/4 configuration. It is framed by two 6/6 double hung sash windows. The dormer windows are small 6/6 double hung sash windows. There is a one story concrete block garage.

187-5001-0020	1919	Contributing Building
106 North Main Street	Whitehead, C., House	Contributing Building
	D.T. Williams House	

This is a two story (plus attic) residential building with a flared hipped roof and a one story wraparound porch supported on paired columns. There is also a side porch with a single leaf wood door with 9 lights and 3 horizontal panels. The front door has the same articulation and a painted fanlight. There is a frame, two bay garage.

187-5001-0021	1880s	Contributing Building
102 North Main Street	Sease, T., House	Contributing Building
	Judge Coles House	

This is a 2 story frame domestic building; it has a brick foundation and a metal intersecting hipped roof. It has a one story, five bay porch with a hipper roof supported by Doric columns. There is a central single leaf door with sidelights and a transom. There is also a polygonal side bay with a 1/1 window and a wrought iron fence around the property. This is a one story frame garage with weatherboard siding and a standing seam metal gable roof with exposed rafters. It sits on a brick

United States Department of the Interior
National Park Service

National Register of Historic Places
Continuation Sheet

Chatham Historic District
Chatham, Virginia

Section 7 Page 15

foundation.

187-5001-0022
66 North Main Street

1881 ca
Emmanuel Episcopal Church

Contributing Building

The building was originally constructed of wood frame and weatherboard, but in a 1917 renovation was clad in stretcher bond pale yellow/beige brick. The building has a gable front with a tripartite set of lancet stained-glass windows. To one side of the facade is a slender spire with square cone roof and recessed details in the brickwork. To the opposite side of the facade is a square tower with entrance and belfry. The entrance is topped by a raised gable in the brickwork. The openings for the belfry are gothic arched.

187-5001-0023
60 North Main Street

1910 ca
Thompson, Dr., House
Thompson Family Medical Center

Contributing Building

Non-contributing Building

This is a two story brick residential building that has been converted into medical offices. The central door has a tripartite rectangular transom and one-light sidelights and is framed on either side by a double hung sash 8/1 windows. On the second floor there are three 8/1 double hung sash windows. The dormer windows are 6/6 double hung sash windows. The porch has turned balustrade, and Doric columns and supporting an entablature and pitched roof. There are stairs and a handicapped access ramp to the front door. This is a large, four bay concrete block garage with shed roof, asphalt shingle side gable and exposed rafters. There is a large concrete block garage.

187-5001-0024
34-38 North Main Street

1925 ca
Reynolds Building/Oliver's Grocery
Economic Development
Arey Attorney at Law
Pittsylvania County Chamber of Commerce

Contributing Building

This is a two story, three bay, brick commercial building with two discreet store fronts separated by a central, single leaf one light two panel door with 2 light transom. The left storefront has three multi-light, double-hung sash windows, a double-leaf 6 panel door, a 14 light transom, and is framed by fluted doric pilasters supporting an entablature with an inset signband. The right storefront has a shed roof entrance overhang supported by brackets; fluted doric pilasters defining the storefront; fixed, 20 light windows; single leaf, six panel door (off-center) and 4 light transom. The

United States Department of the Interior
National Park Service

National Register of Historic Places
Continuation Sheet

Chatham Historic District
Chatham, Virginia

Section 7 Page 16

upper facade has equally spaced paired, two-light, double hung sash windows below decorative corbelling at and below the cornice. The roof is flat. Side and rear elevation: There are four paired double-light, double-hung sash windows; six double-light, double hung sash windows on the side and three on the rear; one single-leaf, three-panel door with five lights on the side; two single-leaf, six-panel doors on the rear. The rear is both one and two story.

187-5001-0025
32 North Main Street

1930 ca
Sours General Store
Dr. Lawrence Office
Southeastern Eye Center

Contributing Building

This two story, one bay brick commercial building has a single leaf two panel, nine light wood door centered between two fixed 20 light wood windows. The lower facade is infilled with vertical wood siding. The upper facade three 6/6 double hung sash windows and a corbelled brick cornice. The rear elevation is concrete block with exterior chimney, two eight light metal casement windows and two six light metal casement windows.

187-5001-0026
30 North Main Street

1925 ca
Star-Tribune

Contributing Building

This two story, one bay masonry commercial building has three fixed aluminum one light windows with concrete lintels and sills in the upper facade; the lower facade has an aluminum single leaf door and single light transom centered between sets of three aluminum single light windows on brick half-walls. The windows in the upper facade a paired, vertical two-light windows with jack arches.

187-5001-0027
28 North Main Street

1925 ca
Chatham Chiropractic

Contributing Building

This two story, one bay brick commercial building has an aluminum and plate glass storefront; the upper facade has two paired 8/8 double hung sash windows on brick sills below a corbelled brick cornice and flat roof. The side has five course American bond brickwork.

187-5001-0028
20-24 North Main Street

1895 ca
M and W Flower Shop

Contributing Building

United States Department of the Interior
National Park Service

National Register of Historic Places
Continuation Sheet

Chatham Historic District
Chatham, Virginia

Section 7 Page 17

This is a two story brick commercial building. The lower facade is divided into two discreet storefronts. Each has two doors set within the plate glass storefront. The upper facade has seven arched 2/2 double hung sash windows with brick surrounds below an elaborately corbelled cornice and a flat roof. The rear elevation has six arched window openings on the second story: three boarded up, two 2/2 double hung sash, and one 1/2 double hung sash. There are four arched window openings on the first story: two are boarded up and two are 2/2 double hung sash windows. There are two single leaf wood doors.

187-5001-0029	1895 ca	Contributing Building
14-16 North Main Street	Thompson's Drug and Haberdashery	
	Bargain Shop	

This two story, three bay commercial building has two discreet storefronts divided by a centrally located entrance to the second floor. The storefront on the right has two plate glass and aluminum storefront windows set upon quarter brick walls and a recessed entry with a double leaf wood door with pedimented peak surround and three-light sidelights. The left storefront has two aluminum and plate glass storefront windows set upon brick half-walls and a recessed entry with a single leaf aluminum and plate glass door. The central door to the second story is slightly recessed between the two storefronts with a single leaf aluminum and plate glass door and a sidelight. Above this door is the raised brick outline of an open cross-shape; this motif is repeated above the 10/1 double hung sash window located directly above the central door. The central window is part of the row of windows in the upper facade, but the other four are 8/1 double hung sash windows.

187-5001-0030	1925 ca	Contributing Building
12 North Main Street	Hargraves Barber	
	Rudolph Shupik Attorney	

This is a one story, one bay brick commercial building with a single leaf, six panel wood door and a stained glass transom. There is an off-center, 1/1 double hung sash window. There is corbelling at the cornice.

187-5001-0031	1905 ca	Contributing Building
10 North Main Street	Planters Bank	
	Chatham Insurance	
	Shepherd's	
	W. C. Brown Insurance Services	

United States Department of the Interior
National Park Service

National Register of Historic Places
Continuation Sheet

Chatham Historic District
Chatham, Virginia

Section 7 Page 18

This is a two story, masonry building with an angled, arcaded entry. Inside the arcade, there are fluted pilasters between the windows, door, and side at the wall juncture. There are molded concrete block pier supports on the storefront. The ceiling of the entry has dentil moldings and there are three square transoms with original glass. In the upper facade, there are three arched window openings with the arched heads in-filled. The windows are 2/2 double hung sash windows. The applied metal cornice has large dentil moldings and a round head at the center peak.

187-5001-0032	1905 ca	Contributing Building
6 North Main Street	Chatham Jewelry Store	
	Boppa's	

This is a two story one bay masonry building with an angled storefront. There are aluminum windows in the front. There is a brick corner corbel at the cornice above two arched 2/2 double hung sash windows. There is a wide band of greenstone applied between the first and second floor with scallop trim at the second floor line.

187-5001-0033	1920 ca	Contributing Building
2-4 North Main Street	Planters Bank and Trust	
	Wachovia	
	Overbey Law Office	

This one story, one bay bank building has a temple front. The pediment, with dentils and brackets, has a full entablature and architrave supported by fluted Corinthian columns flanked by piers with palm capitals. The recessed entry has been closed with glass and cast metal in the door, vertical transom and sidelights. There is a scrolled bracket the in-filled entry.

187-5001-0034	1970 ca	Non-contributing Building
2 South Main Street	American General Finance	

This 1-story, masonry building has a row of three projecting bricks below the cornice. The pedimented entry has fluted pilasters. Flat jack arches accent the window tops and brick sills project at the bottoms.

187-5001-0035	1920 ca	Contributing Building
4 South Main Street	Woodfin's Pharmacy	

United States Department of the Interior
National Park Service

National Register of Historic Places
Continuation Sheet

Chatham Historic District
Chatham, Virginia

Section 7 Page 19

Whitehead's Drug Store

This is a one story brick commercial building with plate glass and aluminum storefront windows set on half-walls below a broad awning. There is an off-center aluminum and plate glass double leaf door. Above the awning is a cornice with dentil moldings below a flat roof. There is a stepped parapet with brick buttresses at the sides. There is five course American bond above the cornice and stretcher bond below.

187-5001-0036

6-10 South Main Street

1925 ca

Harris Building

Henry Davis, Lawyer

Dr. Randolph, Dentist

Contributing Building

This is a two story brick commercial building divided into two discreet storefronts. The right storefront is sided; it has a central doorway between two sets of paired 6/6 double hung sash windows. Like the left storefront, it has an aluminum shed roof awning. The left storefront with fixed plate glass windows has a central recessed entry, aluminum and plate glass single leaf door, and a single light transom; there is an off center plate glass door leading to the second story. The windows in the upper facade are paired 1/1 double hung sash on brick sills. There is a corbelled brick cornice and recessed sign tablets.

187-5001-0037

12-14 South Main Street

1900 ca

Pino's

E.G. Coles Insurance Agency

Contributing Building

This is a two story masonry commercial building with four 2/2 double hung sash windows in the upper facade, and a single leaf wood door, a single leaf aluminum door, and one fixed aluminum and plate glass window in the storefront.

187-5001-0038

16 South Main Street

1925 ca

Jefferson's Furniture Store

Leggett's

People's Department Store

Chatham Furniture

Kim School - Tae Kwon Do

Contributing Building

United States Department of the Interior
National Park Service

National Register of Historic Places
Continuation Sheet

Chatham Historic District
Chatham, Virginia

Section 7 Page 20

This is a two story, one bay, brick commercial building with a corbelled brick cornice and four 6/1 arched double hung sash windows in the upper facade. There is an off center, recessed aluminum and glass double leaf door and plate glass windows set upon brick quarter walls. The side has five course American bond.

187-5001-0039	1925 ca	Contributing Building
18 South Main Street	Overbey's Hardware	
	PCCA	

This is a two story, one bay brick commercial building with a plate glass and aluminum storefront with a single leaf aluminum and glass door below an aluminum marquee. Above the marquee is wood siding. The upper facade has corbelled corners, a recessed sign tablet, and a corbelled cornice. It has a flat roof. The rear of the building is intact with first floor segmental arched window openings (two 8/12 and one 12 light), a central single leaf nine light (new) wood door. The second story has three 6/6 double hung sash windows.

187-5001-0040	1905 ca	Non-contributing Building
22 South Main Street	Art's Barber	

This is a one story, one bay, masonry commercial building remodeled with stone veneer on the exterior. The roof is flat, with pitched sides. There is a central aluminum and glass door set between two plate glass windows.

187-5001-0041	1925 ca	Contributing Building
24-26 South Main Street	Whitehead's General Store/Movie Theater	
	Goodwill Thrift Shop	

This is a two story commercial building with two discreet storefronts. The north storefront is remodeled with vinyl siding; it has a recessed entry with a single-leaf wood door and a single-light transom between two fixed, twenty-light plate glass windows. The south facade has a recessed aluminum and plate glass entry on a stuccoed brick base with T1-11 siding above a canvas awning. The sign tablet has been stuccoed.

187-5001-0042	1910	Contributing Building
28 South Main Street	Vicello's Store	
	Mitchell's Store	

United States Department of the Interior
National Park Service

National Register of Historic Places
Continuation Sheet

Chatham Historic District
Chatham, Virginia

Section 7 Page 21

Chatham Furniture Company

This is a two story, single bay masonry commercial building with aluminum siding on the upper facade and a plateglass and aluminum storefront with two sets of double leaf aluminum and glass doors. Separating the two stories is an aluminum marquee supported by metal poles.

187-5001-0043
30 South Main Street

1910
Hampco Apparel

Contributing Building

This is a two story, five bay, brick commercial building. The upper facade is divided by recessed fenestration with corbelled brick surrounds below a corbelled flat roofline. The windows are paired, fixed ten-light, metal casement windows with a central hopper. A shingle mansard overhang separates the first and second story. The first story has been altered to include 33 light storefront window and an off-center, recessed entry with a single-leaf wood door.

187-5001-0044
1 Depot Street

1923-1927
Bill's Diner
Streetcar Named Desire, A

Contributing Building

Bill's Diner is a streetcar converted for restaurant use. As a streetcar, the vehicle served its transportation life in Reidsville, North Carolina, until 1938. From the late 1930s through the 1950s, most towns and cities in the United States began converting to bus service. Because of this transportation evolution, streetcars were relegated to the scrapper, or for other purposes. For the budding restaurant entrepreneur, the streetcar had many of the same design and spatial characteristics as the factory-constructed diner. Bill Fretwell of Chatham, Virginia, recognized an opportunity when the streetcars of Reidsville were made available. He brought the single-truck car to Chatham to house his already successful food stand business in 1937. The streetcar vehicle became a popular competitor to the factory-made Lunch Wagons of the early 20th-century. The cross-design of rail vehicles and the mobile restaurants gave birth to the popular descriptive term "diner" for prefabricated diners.

United States Department of the Interior
National Park Service

National Register of Historic Places
Continuation Sheet

Chatham Historic District
Chatham, Virginia

Section 7 Page 22

187-5001-0045	1980s	Non-Contributing Building
108-116 South Main Street	Chatham Oil First Piedmont Corp.	

Two-story frame building with vinyl siding, hipped roof and one-story wing at front. Made to resemble a residence. Concrete block wing at rear.

187-5001-0046	1980s	Non-Contributing Building
118-120 South Main Street	Harris, Harvey, Neal and Company	

One-story, concrete block structure with vinyl siding forming a parapet at the side, flat roof. Entry at corner. The sash, double-hung windows on front elevation.

187-5001-0049	1900 ca	Contributing Building
146 South Main Street	Shelhorse House Poole, R., House	

This is a two story, frame building with an intersecting gable roof and a four bay frame wrap-around hipped roof porch. The front gable has a set of paired 2/2 double hung sash windows in the first story and a single 2/2 double hung sash window in the second story. In the foirst story of the intersecting gable there is a single leaf door with single light transom and single 2/2 double hung sash window in the second story.

187-5001-0050	1900 ca	Contributing Building
152 South Main Street	Faison-Hall House Broomell, M., House	

This is a two story frame residential building with a side gable roof and central peak; it has a three bay frame porch with projecting central bay and hipped roof supported by smooth doric columns. There is a central single leaf wood door and five 1/1 double hung sash windows.

187-5001-0051	1920 ca	Contributing Building
158 South Main Street	Collie House Plaszcz, R., House	

United States Department of the Interior
National Park Service

National Register of Historic Places
Continuation Sheet

Chatham Historic District
Chatham, Virginia

Section 7 Page 23

This is a two story brick residential building with mansard roof with slate shingles; there are two end gables. There are three 6/6 double hung sash windows in the second story with pent roofs. There is a one story, one bay integral porch with wrap-around pent roof. There is a central peak above the shell arched door surround.

187-5001-0052	1897	Contributing Building
162 South Main Street	Nanny Whitehead House	Contributing Building
	McCrudden, M., House	

This is a two story frame residential building with an intersecting gable roof; there are cornice returns in the front gable. The four bay porch spans the front gable and the wing; it has a hipped roof supported by turned columns. The walk leading to the door is slate. The one-story garage is sided with weatherboard and has a gable roof. The garage stands to the rear and side of the dwelling.

187-5001-0053	1900 ca	Contributing Building
204 South Main Street	Jesse Overbey House	Contributing Building
	Willis, C., House	Contributing Building

This is a two story frame residential building with an intersecting gable roof. The front gable has cornice returns. The one story, five bay porch spans the front of the house; it has a pediment above the central double leaf door. There is a stone retaining wall with a hedge around the property and a brick walk. This 1-story wash-house has weatherboard siding, a gable roof with asphalt shingles and a stone foundation. A wooden single leaf door provides entry. This new frame garage is sided with weatherboard and has a gable roof and concrete block foundation. The wash-house and garage stand directly behind the dwelling.

187-5001-0054	1897	Contributing Building
214 South Main Street	Judge Coles House	Contributing Building
	The Columns	Contributing Building
	Bed and Breakfast	

United States Department of the Interior
National Park Service

National Register of Historic Places
Continuation Sheet

Chatham Historic District
Chatham, Virginia

Section 7 Page 24

This is a two story frame residential building with an intersecting hip and gable slate shingle roof. On the second floor in the gable end, there is a projecting bay; it is located directly above the door. The door is a single leaf leaded glass door with full light leaded glass sidelights and arched transom. The one story wraparound porch has a hipped roof, modillions, and fluted Ionic columns and turned balustrade; it has a projecting bay over the front door. There is German siding on the first floor. There are boxwoods lining the front walk. The 1-story, weatherboard-sided wash-house has gable roof of standing seam metal and a brick chimney. The 1-story, 2-bay garage has a gable roof and vinyl siding. The two outbuildings stand to the rear of the dwelling.

187-5001-0055	1895	Contributing Building
220 South Main Street	Coleman-Shelhorse House	Contributing Building

This is a two story frame residential building with a hipped and gable roof; there are two front pedimented gables. There are finials on the roof. Both gable fronts have paired casement windows in the gable and paired double hung sash windows on the first and second stories. The one story five bay porch with corner turrets and a balcony over the central bay. The porch has fluted Doric columns, paired in the center bay, and a turned balustrade. The one-story gable-roofed garage is sided with weatherboards. The garage stands to the rear and left of the dwelling.

187-5001-0056	1910	Contributing Building
230 South Main Street	House	Contributing Building

This is a two story frame residential building with a steeply pitched hipped roof with profile brackets in the wide eaves. There is a central gable dormer with pediment; it has a tripartite rectangular window. On the second floor, below the dormer, is a larger rectangular tripartite window. There is a central portico with a pedimented gable roof supported by paired fluted Tuscan columns and a scroll-sawn balustrade; the central door has a fanlight and twelve light sidelights. The 1-story, 2-bay garage has a gable roof and weatherboard siding. Exposed rafters are visible at the roof and a shed-roof addition flanks the side. The garage is located to the rear of the dwelling.

187-5001-0057	1870s	Contributing Building
236 South Main Street	House	Non-contributing Building

This is a two story frame residential building with an intersecting hip and gable roof; there is an off center gable peak with scroll sawn verge board above a set of paired 1/1 windows. The one story porch has a hipped roof with an off center pediment. It has turned columns and a square balustrade.

United States Department of the Interior
National Park Service

National Register of Historic Places
Continuation Sheet

Chatham Historic District
Chatham, Virginia

Section 7 Page 25

The door has a two light rectangular balustrade. A non-historic pressed-board shed stands to the rear of the dwelling.

187-5001-0058	1870s	Contributing Site
South Main at Memorial Drive	Chatham Burial Park	

Located behind the Armory, approximately 250 markers in the cemetery bordered by curving road and marked with a small entrance sign on South Main Street. Stones ranging from mid-to-late 19th century to present; variety of material and style of headstones. Some plots are defined by wrought iron fencing or low granite borders. Older deciduous trees comprise the landscape which is defined by a slight hill.

187-5001-0059	1954	Non-contributing Building
	Armory	

One-story, brick veneer, flat roof, pilastered walls. One-story side wing. Metal entry porch along the front supported by metal poles.

187-5001-0060	1920s	Contributing Building
348 South Main Street	House,	

This is a two story brick residential building with a hipped roof. There are two central dormer windows with tripartite tracery windows. On the second floor there is a central tripartite double hung sash window with tracery/1; the windows on the first floor are also tripartite double hung sash with tracery/1. The central door has a broken transom and 1/1 sidelights. The one story three bay porch has a standing seam metal hipped roof supported on Tuscan columns.

187-5001-0061	1837	Contributing Building
42 Franklin Place	Morea	Contributing Buildings - 5
	Quencus Manor	Non-contributing Buildings-5
		Non-contributing Structure

Currently has a 1-story, 3-bay portico with Ionic columns over front entrance. In 1958 it had a brand new wraparound porch and 3 gable dormers, which have since been removed. The office is the most significant secondary structure associated with the property. This 1 1/2-story building has a gable

United States Department of the Interior
National Park Service

National Register of Historic Places
Continuation Sheet

Chatham Historic District
Chatham, Virginia

Section 7 Page 26

roof with two small gable-roofed dormers on the rear roof slope. A large brick chimney is located at the rear of the building. A stone foundation supports the beaded weatherboard-clad structure. The roof is covered with wood shingles. A 6-panel wood door provides entry. The dormers feature 4/4 casement windows.

The frame smokehouse has a gable roof covered with wood shingles. The frame building is clad with beaded weatherboard. A stone foundation supports this structure. The frame garage is sided with weatherboard and has a gable roof with flanking side shed. A 2-light casement window highlights the front. The shed-roof chicken coop is clad with weatherboard and is supported by concrete block piers. The framing in the long row of windows is missing. The frame springhouse is clad with weatherboard and covered by a standing seam metal gable roof. A solid uncoursed stone foundation supports this.

All secondary resources stand to the right and rear of the dwelling, somewhat wrapping around the house. The four non-historic sheds are all one story tall with weatherboard siding and shed roofs. The non-historic garage has a shed roof and is composed of concrete block. An in-ground pool is located to the rear of the property.

187-5001-0062
South Main Street

1870s
"Colored" Cemetery

Contributing Site

In an open field off of Main Street with no marked entrance. This small black cemetery features approximately 75-100 headstones. Large oaks line a gravel drive along the south side. Marked and unmarked graves with a variety of headstones and materials. There is no landscaping, walls or formal plantings.

187-5001-0063
343 South Main Street

1920s
Paul Crider's House
Cundiff, C. B., House

Contributing Building
Contributing Building

This is a one and one half story frame residential building with a gable roof and dormers and an integral one story five bay porch supported on square columns. There are three dormers; the central dormer has a gable roof and a row of four square multilight casement windows. The flanking dormers have hipped roofs and 1/1 sash windows. The central door is flanked by 1/1 sash windows. The gable-roofed garage has beaded board and batten siding. The garage is located to the rear and right of the dwelling.

United States Department of the Interior
National Park Service

National Register of Historic Places
Continuation Sheet

Chatham Historic District
Chatham, Virginia

Section 7 Page 27

187-5001-0064
335 South Main Street

1874
Laird-Whitehead House

Contributing Building
Non-contributing Building

The Laird-Whitehead House is located at 335 South Main Street (Business Route 29) in the town of Chatham, the county seat of Pittsylvania County. The main house faces west and is a two-story, three bay frame structure built in 1874 in the late Greek Revival/Italianate style. It has a hipped roof with two center chimneys, is covered with German siding and features wide eaves with a decorative bracketed cornice. The most prominent feature of the front facade is the handsome two-story pedimented portico executed in the Colonial Revival style around 1910. It features paired Ionic columns in the Colossal order, a full entablature and a dentilled cornice. There is a smaller two story gable roofed wing to the rear with a gable end chimney. There is a non-contributing garage/apartment built on the site of the old corncrib to the rear of the main house. The secondary resources are located at the rear of the dwelling. The corncrib was not seen when surveyed in February 2000.

187-5001-0065
319-323 South Main Street

1925
Chatham Elementary School
and Library

Contributing Building
Contributing Building

This is a two story five bay brick school building; the central three bay section has a gable roof and the flanking one bay wings have hipped roofs. The central section is defined by brick chimneys and each bay is has paired double hung sash 12/12 windows. There are three central pedimented dormer windows with 6/9 double hung sash windows. The central double leaf door with seven light transom has a segmental arched pediment and fluted Doric pilasters. There are brick quoins on the corners and arched side windows.

The one and one half story library has Flemish bond brickwork and an intersecting gable roof with dormers. There are two interior end flemish bond chimneys. The cornice has modillions and dentils. There are 4/4 double hung sash windows in the gable end. There are 6 6/6 double hung sash windows on the first floor. The door is a six panel single light door with four light rectangular transom. There is a one story three bay open porch with pedimented gable with modillions and dentils. It has smooth Doric columns and a square balustrade. The library is located to the front of the property.

187-5001-0066

1915 ca

Contributing Building

United States Department of the Interior
National Park Service

National Register of Historic Places
Continuation Sheet

Chatham Historic District
Chatham, Virginia

Section 7 Page 28

309 South Main Street	Overby, P. L., House	Contributing Building
	Moschler, L., House	Contributing Building
		Non-contributing Building

This is a two story frame residential building with an intersecting gable and hipped roof. The front gable has cornice returns. There is a one story wraparound hipped roof porch supported on square chamfered columns with a square balustrade. The porch has scroll sawn brackets. There is a two story rear wing with intersecting gable roof and a two story rear sleeping enclosed porch with a shed roof. The 1-story, frame workshop is covered with beaded weatherboard. A gable roof of standing seam metal covers it with exposed rafter ends. A shed roof addition flanks one side. A brick foundation supports the structure. The 1-story, frame garage has a gable roof with exposed rafter ends. The outbuildings are located to the rear of the property. A non-historic metal shed with gable roof is also in this complex.

187-5001-0067	1900 ca	Contributing Building
301 South Main Street	Wyatt-Whitehead House	
	McPlaster House	

This is a two story frame residential building with an intersecting hip and gable roof with a bell turret. There is a central hipped roof dormer with a tripartite window. The corner turret has 1/1 double hung sash windows. The one story wraparound porch has a hipped standing seam metal roof supported on turned columns with scroll sawn brackets and has a turned balustrade. On the first floor there is a multi-pane window and a central door with single light rectangular transom. On the side there are pedimented end gables.

187-5001-0068	1900 ca	Contributing Building
237 South Main Street	Asa Hodnett House	Non-contributing Building
	Cooper, E., House	

This is a two story frame residential building with a hip and gable roof and a pedimented front gable with a fixed multi-pane window. There is a one story wraparound porch with corner turret, with finial, with standing seam copper roof supported on smooth Doric columns and a turned balustrade. The side porch has a hipped roof, turned columns and a square balustrade. The central door has a four light transom and 3/1 sidelights. On the first floor there is a square casement multi-pane window. A non-historic garage with weatherboard siding and shed roof stands at the rear of the property.

United States Department of the Interior
National Park Service

National Register of Historic Places
Continuation Sheet

Chatham Historic District
Chatham, Virginia

Section 7 Page 29

187-5001-0069	1930s	Contributing Building
231 South Main Street	Allen, S., House	Contributing Building
	Tom Smith House	Non-contributing Structure

This is a two story brick residential building with an intersecting hipped roof with wide eaves. There is a dentilled cornice. A central portico with a pedimented gable roof supported on turned columns; the central door has a broken transom and 3/1 sidelights. The 1-story, 2-bay frame garage has a hipped roof of asphalt shingle topped by a cupola with weathervane. The garage and frame gazebo are located immediately behind the dwelling.

187-5001-0070	1850 ca	Contributing Building
225 South Main Street	Keatts-Harris House	Contributing Building
		Non-contributing Building

This is a one and one half story frame residential building with a gable roof with catslide with decorative verge board. There is a 6/6 double hung sash window in the gable front. The one story porch, with hipped roof, has square columns and latticework. The 1-story, 1-bay frame garage has a gable roof. The garage is located to the rear of the dwelling. The small, latticework gazebo is located immediately off of the right front corner of the dwelling.

187-5001-0071	1920 ca	Contributing Building
219 South Main Street	Bloomer, J., House	Non-contributing Building
	John Jones House	

This is a two story frame residential building with a hipped roof, wide eaves with brackets, and dormers. The two dormers have paired four light casement windows. The configuration of the second floor windows is double hung 8/1 sash windows. The one story hipped roof porch is supported on paired square columns with gridwork and a square balustrade. The central door has a broken transom (3x7x3) and six light sidelights and is flanked by tripartite double hung 4/1x8/1x4/1 sash windows. A metal shed with gable roof stands to the rear of the dwelling.

187-5001-0072	1925 ca	Contributing Building
209 South Main Street	Lyle, D., House	Non-contributing Structure
	Dave Jefferson House	

This is a one and one half story brick residential building with a gable roof with central gable dormer

United States Department of the Interior
National Park Service

National Register of Historic Places
Continuation Sheet

Chatham Historic District
Chatham, Virginia

Section 7 Page 30

with knee braces; the four windows in the dormer are 3/1 double hung sash windows. The integral porch is supported on brick piers and a wood post on a brick half wall. There are projecting headers at the water table and there is a row of headers at the attic story. The central door has six light flush panel sidelights and there is a pair of 3/1 double hung sash windows. A metal pole carport stands to the rear of the dwelling.

187-5001-0073	1910 ca	Contributing Building
205 South Main Street	Watson, R., House	
	Davis House	

This is a two story frame residential building with an intersecting gable roof with dormers; in the gable and the dormers are louvered vents. The windows are paired double hung sash windows with 3 6/1 on the second floor and two 2/2 on the first. The central door has a broken transom and 1/1 sidelights. The one story three bay porch has a hipped roof supported by Doric columns and has a slender, turned balustrade.

187-5001-0074	1935 ca	Contributing Building
153 South Main Street	Standard Oil Company	
	FasMart	

One-story, concrete block service station with flat roof, service bays altered with aluminum storefront. Metal covered gas island to front.

187-5001-0075	1947	Contributing Building
147 South Main Street	Scott Funeral Home	

This is a two story, three bay brick building with central portico. The portico has a copper mansard roof and 13 steps leading to the single leaf wood door. There is a recessed garage roll-up door at the basement level. There are two 4/4 double hung sash windows and two 6/6 double hung sash windows. On the second floor there are two 6/6 double hung sash windows and two 8/8 double hung sash windows. The roof is flat. There is a one story side addition visible from the front with two blind openings with lanterns. There are two bay windows with copper overhangs flanking a double leaf door with copper overhang on the side.

187-5001-0076	1921	Contributing Building
---------------	------	-----------------------

United States Department of the Interior
National Park Service

National Register of Historic Places
Continuation Sheet

Chatham Historic District
Chatham, Virginia

Section 7 Page 31

135 South Main Street

Chatham Christian Church

This brick church building has a front gable roof; elements of the the front gable end are a front gable vestibule with three sets of two double leaf panelled doors, concrete panels in the transoms, a cast iron lantern, and decorative buttresses. The church sits on a raised basement and extends seven bays to the rear with a 1x4x2 bay configuration.

187-5001-0077

1970s

Non-contributing Building

131 South Main Street

Grubb Auto

One-story brick veneer with hipped roof and integral full-width porch supported by square columns.

187-5001-0078

1920 ca

Contributing Building

119 South Main Street

Chatham Knitting Mills, Inc.

This is a two story, plus attic, four bay, brick building with a gable roof. The facade is divided into bays by brick pilasters which support a corbelled cornice. On the first story there are two arched window openings infilled with glass block, there is a single-leaf wood door with three-light transom in the arched doorway and there is a double-leaf door with two-light transom at the loading dock. In the second story there are four 6/6 double hung sash arched windows. The corbelled gable has two louvered windows. The side elevation is six bays deep with a CHATHAM KNITTING MILLS INC. sign dividing the first and second story. The second story windows are arched 6/6 double hung wood sash windows. Those on the first story are arched, fixed, ten light windows with a central hopper. The corbelled brick cornice continues along the side.

187-5001-0079

1923

Contributing Building

115 South Main Street

Gammon Motor Company
B&B Motors, Inc.

This is a two story, two bay masonry commercial building with a flat roof and a central porte cochere. The upper facade is defined by two ribbons of three pairs of 2/2 horizontal pane double hung sash windows. The lower facade has a double leaf garage door with 24 lights over one panel of vertical beaded board, two fixed aluminum and plate glass windows, one single leaf wood door with 3 lights over two vertical panels and a single light transom, and a single leaf single light wood door. The side with pilastered walls has five course American bond brickwork; the rear has segmental arched windows and a rollup garage door with 24 lights over 1 panel of vertical beaded

United States Department of the Interior
National Park Service

National Register of Historic Places
Continuation Sheet

Chatham Historic District
Chatham, Virginia

Section 7 Page 32

board.

187-5001-0080	1940 ca	Contributing Building
41 South Main Street	Country Clipper	

This is a one story, one bay, masonry commercial building. There is an off-center wood single-leaf, six-light door with single-light transom and there is a plate glass picture window below an aluminum awning. Quoins define the right corner of the facade. The roof is flat. The rear elevation has two paired metal casement windows and the side elevation has two three light metal casement windows and one two light metal casement window. There is a three-leaf, nine-light wood door with metal awning and concrete stairs.

187-5001-0081	1935 ca	Contributing Building
37 South Main Street	E. Hedrick Commercial Building	

One-story, concrete block building with brick veneer on front facade with inset brick sign band. Two wooden fixed store windows with transoms to the right of two single-leaf wooden doors with large transoms.

187-5001-0082	1935 ca	Contributing Building
33-35 South Main Street	Worsham Appliance and TV	

This is a one story, two bay, brick commercial building with three discreet storefronts. The left storefront has a recessed, angled entry below a metal marquee. The single leaf aluminum and glass door with sidelight and transom is off center in the aluminum and plate glass front. The central and right storefronts have original single leaf wood one-light doors next to one-panel original wood windows with transoms over the door and windows. The storefronts are divided by brick piers. Unifying the whole facade is a recessed brick sign tablet with row headers.

187-5001-0083	1935 ca	Contributing Building
31 South Main Street	U. S. Post Office - Chatham	

This is a one story, three bay, brick building with side-gable shingle roof. The front facade has a central recessed entry defined by doric pilasters supporting an entablature with metopes and triglyphs below a projecting cornice. The door is double leaf aluminum and plate glass below a fanlight. On either side of the entry there are two 6/6 double hung sash windows with flat jack arches above.

United States Department of the Interior
National Park Service

National Register of Historic Places
Continuation Sheet

Chatham Historic District
Chatham, Virginia

Section 7 Page 33

There is a dentilled cornice. The side elevation has an arched window set between two rectangular windows in the gable.

187-5001-0084
27 South Main Street

1925 ca
Collie Hotel
William Pitt Building

Contributing Building

This is a three story, three bay commercial building with a vaulted, recessed entry set below an entablature and cornice. The entablature is supported by two engaged Tuscan columns on either side. Each corner of the building is defined by brick pilasters. The vaulted recessed entry has a single leaf eight panel wood door with fan light and four-light sidelights; there are three stairs leading up to the door. Between each set of columns is a 6/1 double hung sash window with a three-light transom above. These windows have 1/2 length decorative metal grates in front of them. The upper facade is divided into three bays by the brick pilasters spanning the second and third story and supporting another full entablature and projecting cornice below the flat roofline. The entablature is articulated with diglyphs and metopes. The windows on both upper facades are identical: the central paired 6/1 double hung sash window is flanked on either side by a single 6/1 double hung sash window. Each window has a lintel with keystone. The side elevation is 9 bays deep, divided by brick pilasters. Both cornices continue from the front around the side dividing the building between the first and second stories. The window articulation of the front continues in the side elevation. The central bay has an arched 3/1 window on the third story, above a paired 6/1 double hung sash window in the second and first stories. There is a central side entry with single leaf door with four light transom and 3/1 sidelights. The basement is exposed on the side.

187-5001-0085
25 South Main Street

1915-1920
First National Bank
Pat's Place

Contributing Building

This is a two story brick enframed block commercial building. The central recessed bay with the storefront is framed by two heavy brick piers with recessed central panels set upon concrete bases. The piers support a full entablature and cornice below the roofline. The central bay has, at the first floor, a recessed entry set between storefront windows set on a half-wall covered by a deep awning. There is a signboard above the awning, set below a row of four paired casement windows.

187-5001-0086

1915-1920

Contributing Building

United States Department of the Interior
National Park Service

National Register of Historic Places
Continuation Sheet

Chatham Historic District
Chatham, Virginia

Section 7 Page 34

21 South Main Street

Elliott's Hardware

This is a two story brick commercial building with one storefront defined by piers with corbelled brick quoins. The aluminum and plate glass storefront has five fixed panels with an off-center recessed entry. There is one single leaf plate glass door with a sidelight and transom. The whole is unified by an aluminum marquee and sign board below a projecting brick course. The upper facade has five 6/6 double hung sash windows with sandstone sills and arched brick heads. The heads are infilled with stucco. Between each there is a raised brick diamond. There is a bracketed, molded wood cornice below the parapet and flat roof. The side is eight bays deep with five course American bond, and 8/8 double hung sash segmented arch windows. The rear elevation has a central, pedimented bay with a roll-up garage door on the first story and one on the second. The central bay is flanked on either side, on either floor, by two arched windows. One window on the first floor has been enlarged to make a single leaf, six panel door. There is one interior brick chimney, visible from the rear.

187-5001-0087

1920s

Contributing Building

19 South Main Street

Burnett's Diner
Chatham Cafe
Main Street Lunch
S & K Diner

Known longest as Burnett's Diner, this unusual restaurant building is one of two former early 20th century streetcars operating as eateries in the small Southside Virginia town of Chatham. Bill's Diner, a smaller streetcar is located about 150 feet south on the opposite side of Main Street (at the corner of Depot and Main Streets). The streetcar vehicle became a popular competitor to the factory made Lunch Wagons of the early 20th century. The cross-design of rail vehicles and the mobile restaurants gave birth to the popular descriptive term "diner" for prefabricated, semi-mobile, restaurants. Three brothers, Henry, Frank and Jessie Burnett bought the recently retired Danville Traction and Power Company Car No. 66 sometime around 1939. Hauled 20 miles north to Chatham on Booker Stone's flat bed truck, the Burnett brothers' diner opened for business sometime after 1938 and continued their service well into the 1960s. Burnett's Diner is one of the finest surviving examples of the streetcar-diner in Virginia and possibly in the eastern United States. Streetcar-diner conversions are extremely rare nationally, especially those that still operate as viable businesses. Built by the Perley A. Thomas Car Company of High Point, North Carolina, Car No. 66 was purchased by the Danville Traction and Power Company along with four other double-truck closed cars, in 1923. Buses began replacing the Danville streetcars in 1936. The Schoolfield-North

United States Department of the Interior
National Park Service

National Register of Historic Places
Continuation Sheet

Chatham Historic District
Chatham, Virginia

Section 7 Page 35

Danville route streetcars, which included Car No. 66, were replaced with buses in 1938, after a trial run of bus service. Rescued from the scrappers, the Burnett's purchased Car No. 66 for their restaurant space.

187-5001-0088	1925 ca	Non-contributing Building
17 South Main Street	Allan Easley Insurance	

This is a one story masonry commercial building with a shed roof overhang and T1-11 siding. It has two fixed windows and a single leaf, nine light door.

187-5001-0089	1920 ca	Contributing Building
15 South Main Street	Merriwethers on the Square	

This is a one story brick commercial building with a flat roof with molded cornice. It has three fixed arched windows and two arched double hung sash windows. The grouping of three fixed arched windows is repeated on the side as well. The door, with oval leaded glass over one panel is off center. The door and three windows are shaded by an awning. There is a cast iron sign.

187-5001-0090	1890s	Contributing Building
11 South Main Street	Whitehead's Chatham Propane and Appliance Showroom	

This is a two story, one bay masonry commercial building. The storefront has a recessed entry set between two fixed plate glass storefront windows with wood bases and in-filled transoms. The storefront cornice is molded and bracketed. The door is double leaf wood, single light with transom. The entry is tiled with a Greek Key pattern and the name "Whitehead's." In the upper facade, there are three arched, 2/2 double hung sash windows below a corbeled brick cornice. In the rear, there are two 6/6 double hung wood sash windows, one single leaf metal door with light, one double leaf metal door, and a metal fire escape.

187-5001-0091	1920 ca	Contributing Building
1-9 South Main Street	Chatham Savings Bank First Citizens Bank	

This is a one story, brick commercial building with an elaborate temple front. There are two Ionic columns, framed by pilasters with egg and dart detail at the cap, supporting a full entablature and

United States Department of the Interior
National Park Service

National Register of Historic Places
Continuation Sheet

Chatham Historic District
Chatham, Virginia

Section 7 Page 36

pediment with modillions; affixed to one pier is a metal sign with a clock. The piers extend above the pediment and the flat roof. Between the columns is a double leaf wood and glass door with single light sidelights. Above it is a tripartite window, six light by eighteen light by six light. There are granite stairs with a metal curved railing. The bank extends eight bays to the rear. The bays are defined by five large tripartite windows topped by thermal windows.

187-5001-0092
1 North Main Street

1853
Pittsylvania County Courthouse

Contributing Building

The Pittsylvania County Courthouse is located on the east side of U.S. Business Route 29 in the town of Chatham. The two-story, stretcher-bond brick edifice was erected after the plans of L.A. Shumaker. Built in 1853, the building combines elements from the Classical Revival and Italianate styles. The variation in styles is due to the fact that the structure was constructed near the end of a period of great popularity for Classical Revival styles that began with Thomas Jefferson's Roman Revival courthouse designs and culminated at mid-century in the Greek Revival styles. Alterations to the building include the enlargement of the Clerk's office in 1989, the addition of space for court-related offices in 1917, and a rear addition for the Sheriff's and Commonwealth's Attorney's offices in 1968. The facade (west) is distinguished by a pedimented Greek Revival portico that was influenced, according to building records, by the Campbell County Courthouse, located about 40 miles to the northeast. The portico has Doric columns on square piers and a Doric entablature with triglyphs and guttae. The tympanum is finished with formal shiplap siding. The portico shelters a restored double-door main entrance that features a louvered transom and a stone lintel with turned corner blocks. Two auxiliary entrances flank the portico on the ground level; an original single-door side entrance is found on the south elevation. Fenestration on the facade's first story consists of 6/6 hung-sash windows in three-part architraves. The side elevations have 6/6 hung-sash windows topped by lintels with turned corner blocks. Larger openings similarly executed are found on the second story. The building is topped by a cupola which, according to documentation, was added as the building was nearing completion in August 1853 to house a bell. The cupola is divided into two stages: the lower one containing the clock, the second the belfry. The belfry has an Italianate bracketed cornice and a railing with turned balusters. The building's ground floor is divided into the Clerk's and Treasurer's offices. The main floor contains the courtroom. An iron fence separates the courthouse from the sidewalk. The fence was mentioned specifically in the building specifications of 1853 and was erected to extend along Main Street with an entrance gate to the present jail. The size of the fence has been much reduced. The traditional Civil War statue stands to the north of the courthouse. The presence of Chatham's commercial development around the building contributes to its urban setting, which is somewhat relieved by the trees that grow along the

United States Department of the Interior
National Park Service

National Register of Historic Places
Continuation Sheet

Chatham Historic District
Chatham, Virginia

Section 7 Page 37

fence.

187-5001-0093
11 North Main Street

1938
Moses Building

Contributing Building

The Moses Building is a two story, three bay brick and concrete municipal building set upon a concrete raised basement. The facade is defined by two brick piers with concrete quoins on each side with one 8/8 double hung sash window at each story. In the central bay, there is an arched entry with one single-leaf aluminum and plate glass door with semi-circular granite stairs with metal handrail. There are six 8/8 double hung sash windows. In the upper façade there are seven 8/8 double hung sash windows below a concrete entablature, bracketed cornice and flat roof. The building is five bays deep with 8/8 double hung sash windows on the first and second stories and 6/6 double hung sash windows in the raised concrete basement on the side elevation.

187-5001-0094
31-33 North Main Street

1920 ca
Millner Building
Country Living Shop and Victor Millner

Contributing Building

This two story, two bay brick commercial building has two discreet storefronts defined by three heavy brick piers. The right storefront has been infilled with wood siding and a new single-leaf six-panel wood door. There are two paired single-light sash windows. The left storefront has two plateglass windows framing an aluminum and glass door and a single-light transom. Spanning both fronts is a metal marquee. Piers separate the upper facade into discreet but identical parts, each with two 6/1 double hung sash windows with brick sills and arched heads. There is a raised brick sign tablet below the corbelled cornice and flat roof. The side elevation has six course American bond brickwork; one single-leaf, aluminum and plate glass door with shed roof; one single-leaf, one-light, three-panel wood door; one single-leaf door flush with the basement; eight 1/1 double hung sash windows of varying sizes; an "ALLGOOD" and an Eldon Restaurant sign. The rear elevation has four wood, double-hung, 6/6 sash windows; two arched in-filled windows, one single-leaf door; an attached two bay, concrete block garage; shed roof porch of corrugated metal supported by wood posts. There are two chimneys - one interior and one exterior.

187-5001-0095
37 North Main Street

1925 ca
Chatham Cleaners

Contributing Building

This two story, one bay, brick commercial building has an off-center fixed aluminum and plate glass

United States Department of the Interior
National Park Service

National Register of Historic Places
Continuation Sheet

Chatham Historic District
Chatham, Virginia

Section 7 Page 38

storefront two-light window. There is one single-leaf aluminum and plate glass door with sidelight and transom and there is one wood and plate glass single leaf door with transom. The upper facade has paired 2/2 double hung sash windows below a flat roof. The side elevation has six course American bond brickwork, five sixteen-light metal hopper/pivot windows on first floor, and 2 paired 2/2 double hung sash windows.

187-5001-0096	1990s	Non-contributing Structure
53 North Main Street	Welcome Center	

Small, frame, 1-story, 1-bay gable roof building.

187-5001-0097	1970s	Non-contributing Building
55 North Main Street	Virginia Bank and Trust	

One-story, brick veneer, flat roof, mansard metal overhang.

187-5001-0098	1920 ca	Contributing Building
61 North Main Street	Masonic Lodge	
	Tuner and Toler Service	

This two story, three bay, brick commercial building has, at the first floor level, two fixed aluminum and plateglass storefront windows flanking a single leaf aluminum and plate glass door with sidelights and transom. There is an aluminum marquee over the length of the store front. There is a tiled entry with the Greek key pattern. In the upper facade there are three 8/8 double hung sash windows with fan lights; there is a concrete keystone over each arch. The windows are separated by brick pilasters with concrete bases and capitals which support a full entablature and bracketed cornice. The roof is a low hip with parapet. There is a narrow, two story, one bay building (the lodge) attached at the side; the double leaf aluminum and plate glass door has a pedimented overhang with brackets. The window at the second story is 6/6 double hung sash. It has a flat roof.

187-5001-0099	1910 ca	Contributing Building
65 North Main Street	Henry Bolanz House	
	Hardcastle, J., House	

This is a one story frame residential building with a hipped roof. It has a one story three bay hipped

United States Department of the Interior
National Park Service

National Register of Historic Places
Continuation Sheet

Chatham Historic District
Chatham, Virginia

Section 7 Page 39

roof porch with spindle work frieze, turned columns with brackets, and a turned balustrade. The central door is flanked by paired 1/1 double hung sash windows. There is a projecting side bay.

187-5001-0100	1915 ca	Contributing Building
69 North Main Street	Bennett, J., House	Non-contributing Building
	Lawrence-Carter House	

This is a one and one half story brick residential building with a hipped roof with dormer and an integral three bay porch supported by brick piers. The dormer has a pair of 6/1 double hung sash windows. The door with fanlight is flanked by 6/1 double hung sash windows. The L-shape frame workshop has an intersecting gable roof. The workshop is located directly behind the dwelling.

187-5001-0101	1910 ca	Contributing Building
73 North Main Street	Wentworth, B., House	Non-contributing Structure
	Coleman Bennett House	Non-contributing Building

This is a two story brick residential building with a hipped roof with dormers. It has a one story frame porch with hipped roof with spindle work frieze supported by turned columns with brackets and has a turned balustrade. The door has a broken transom, 1x2x1, and 2/1 sidelights. There are jack arches over the door and 2/2 double hung sash windows. The metal carport and pre-fabricated shed stand to the rear of the property.

187-5001-0102	1880s	Contributing Building
103 North Main Street	Dr. Pruden House	Contributing Building
	Powell, D., House	

This is a two story frame residential building with an intersecting gable roof with dormers; it has a two story three bay shed roof porch supported on square columns. The central door has a six light transom and 2/1 sidelights. There are two 6/6 double hung sash windows on the first floor and three on the second. The 1-story frame garage is clad in weatherboard. Its shed roof with standing seam metal has exposed rafter ends. A shed-roof extension was added to this garage. The garage stands to the rear of the dwelling and is accessed from Lanier Avenue.

187-5001-0103	1925 ca	Contributing Building
111 North Main Street	House, 111 North Main	Non-contributing Building
	Street	

United States Department of the Interior
National Park Service

National Register of Historic Places
Continuation Sheet

Chatham Historic District
Chatham, Virginia

Section 7 Page 40

This is a two story frame residential building with a hipped roof. There is a central pedimented gable portico supported on paired columns. The door has a broken, 6x6x6, transom and 6/1 sidelights. There are four 6/1 double hung sash windows on the first floor and three on the second. A small frame shed with gable roof stands to the rear of the dwelling.

187-5001-0104	1900 ca	Contributing Building
117 North Main Street	Presbyterian Manse	
	Jones, G., House	

This is a two story frame residential building with an intersecting hipped roof with wide eaves and large brackets. There is a two story projecting bay on the left side of the house. There is a one story three bay porch, with a central pediment, supported on Doric columns. The central door has an arched door surround.

187-5001-0105	1925 ca	Contributing Building
121 North Main Street	Coles-Fitzgerald House	Contributing Building
	White, M., House	Non-contributing Structure

This is a two story brick residential building with a slate hipped roof and dormers. There are modillions and a copper gutter. It has a central door with a broken pediment door surround and a leaded glass broken transom and sidelights. The windows flanking the door are tripartite, 4/4 x 6/1 x 4/4 double hung sash windows. There are three 8/1 double hung sash windows on the second floor and the windows in the dormers are 6/6. There is a one story screened in porch with Chinese Chippendale balustrade on the roof. The frame garage has a hipped roof. The garage stands to the rear of the dwelling.

187-5001-0106	1890s	Contributing Building
127 North Main Street	House, 127 North Main Street	

This two story residential building has a side gable roof with two intersecting gable fronts and a second story oriel window. The central portico has a pedimented gable roof supported on Doric columns. It shelters a single leaf, four panel door with three light sidelights and a broken transom.

187-5001-0107	1870s	Contributing Building
---------------	-------	-----------------------

United States Department of the Interior
National Park Service

National Register of Historic Places
Continuation Sheet

Chatham Historic District
Chatham, Virginia

Section 7 Page 41

131 North Main Street	Bennett House Cashman, J., House William Shepherd House
-----------------------	---

This two story frame residential building has an intersecting gable roof and a one story, three bay open porch with pedimented gable front. There is a corner turret in the side gable and a polygonal bay in the front gable, which also has an exterior chimney. The fenestration is varied - most windows are multi-pane over one. There are scalloped shingles in the gable and balustrade. This is a one story garage with stucco walls and a gambrel roof.

187-5001-0108	1870s	Contributing Building
145 North Main Street	Martin, B. P., House Wright, V., House Hugh Shepherd House	Contributing Building

This is a two story frame residential building with an intersecting gable roof and a one story three bay metal wraparound porch with wrought iron balustrade at the roof. There is a palladian window in both pedimented gable ends. There is a central single leaf door with fanlight and multi-light sidelights. There is also a side door. There is a weatherboard garage with gable roof to the rear of the building.

187-5001-0109	1900 ca	Contributing Building
151 North Main Street	Overbey, R. V., House	Contributing Building

This is a two story frame residential building with an intersecting gable roof and a one story, two bay open porch. The gable front has paired 1/1 double hung sash windows. There is, in the intersecting gable, a gable dormer with four 6-light casement windows. The central single leaf door has a 3-light sidelights and a multi-light transom. There is a weatherboard garage with gable and shed roof with wings to the rear of the building.

187-5001-0110	1950 ca.	Contributing Building
227 North Main Street	Sugg House	

This one story brick residential building has a side gable roof, three bay iron porch and a polygonal bay window.

United States Department of the Interior
National Park Service

National Register of Historic Places
Continuation Sheet

Chatham Historic District
Chatham, Virginia

Section 7 Page 42

187-5001-0111	1910 ca	Contributing Building
235 North Main Street	Gilmer-Terry House	
	Finkner, S., House	

This two story frame residential building has a hipped roof with central pedimented dormer with tripartite sash window. It has a central pedimented portico supported on Doric columns sheltering a double leaf wood door with single light transom. There are five sets of paired 2/2 sash windows on the facade. There is a one story screen porch on the right side of the house.

187-5001-0112	1910 ca	Contributing Building
241 North Main Street	Nat Clemens House	
	Sutten, D., House	

This is a two story frame residential building with a hipped roof, central dormer, and a one story, three bay open porch with hipped roof and projecting entry supported on paired Doric columns. There is one central 2/2 sash window and 4 pairs of 1/1 sash windows. There are two doors, one single leaf with fanlight and four-light sidelights, and one double leaf with a fanlight.

187-5001-0113	1900 ca	Contributing Building
245 North Main Street	Sours Rental Cottage #1	Contributing Building
	Milette, T., House	

This is a one story frame residential building with an intersecting gable roof. In the gable front is a projecting bay. The porch has a pitched roof, turned columns and no balustrade. There is a garage located to the rear of the house.

187-5001-0114	1900 ca	Contributing Building
253 North Main Street	Sours Rental Cottage #2	Contributing Building
	Motley, B., House	

This is a one story frame residential building with an intersecting gable roof. The front gable has bracketed eaves over the bay. The central door has a single light transom. The porch has solid frieze above slender turned columns and a gridded balustrade. There is a frame garage with weatherboard siding and a gable roof.

187-5001-0115	1970s	Non-contributing Building
---------------	-------	---------------------------

United States Department of the Interior
National Park Service

National Register of Historic Places
Continuation Sheet

Chatham Historic District
Chatham, Virginia

Section 7 Page 43

263-267 North Main Street

Super Dollar/Old Dutch

One-story, masonry with flat roof, metal entry porch with metal porch supports.

187-5001-0116

1925 ca

Contributing Building

301 North Main Street

Sours Garage

This is a one story brick commercial building used for automotive repair. The shape of the building is trapezoidal as it sits at the junction of two major roads in Chatham. Its short, front side addresses the intersection and has a gable-roof porte cochere supported on brick piers. There is, at the this end, a pair of wooden garage doors, and two fixed multi-light windows. The rear has a scored concrete wallw with pressed tin intersecting gable roof, one exterior side chimney, 2/2 double hung sash windows, and 2 light hopper windows. It may, at one time, have been a cannery.

187-5001-0117

1870s

Contributing Building

128 Hurt Avenue

C.G. Sours House

Contributing Building

Non-contributing Building

This is a two story frame residential building with intersecting gable roof. The front gable as cornice returns and a polygonal bay in the first floor. The one story porch is enclosed with glass that connects to the polygonal side bay. There is a one story frame smokehouse with weatherboard siding, gable roof and shed wing. It is located beside the house. A non-contributing shed is located behind the house.

187-5001-0118

1832

Contributing Building

215 Gilmer Drive

Hurt, H., House
The Oaks

This is a two story frame residential building with side gable roof and a one story, three bay porch with hipped roof, dentilled cornice and paired columns in the projecting central bay. There is a central door with four light transom. There are three 12/8 double hung sash windows on the second floor and two 12/12 sash windows on the first floor.

187-5001-0119

1930 ca

Contributing Building

211 Gilmer Drive

Thompson, R., House

Contributing Building

Contributing Building

United States Department of the Interior
National Park Service

National Register of Historic Places
Continuation Sheet

Chatham Historic District
Chatham, Virginia

Section 7 Page 44

This is a one story brick residential building with a side gable roof, two dormer windows, and a one story, one bay flat roof porch with awnings. There is a weatherboard shed with shed roof to the rear of the house, at the end of the drive.

187-5001-0120	1910 ca	Contributing Building
201 Gilmer Drive	Watkins House	Non-contributing Building
	Thompson, G., House	

This two story frame residential building has an intersecting hip and gable roof and a one story, three bay open porch with shed roof supported on paired square columns. There is a polygonal side bay in the front pedimented gable end with 2/2 double hung sash windows. There is a 3 bay frame garage with a concrete foundation and a side gable roof to the rear of the house.

187-5001-0121	1910 ca	Contributing Building
18 Lanier Avenue	House, 18 Lanier Avenue	Contributing Building

This is a two story frame residential building with a gable roof. There is a side porch and a front porch. The front porch has a hipped roof and spindle work frieze supported on turned columns with scroll sawn brackets and has a turned balustrade. The side porch has a pedimented gable roof, spindle work frieze, turned columns with brackets and a turned balustrade; the side door has a multi-pane transom. The 1-story garage has a gable roof and is sided with weatherboard. The garage stands to the rear of the property.

187-5001-0122	1920 ca	Contributing Building
22 Lanier Avenue	House, 22 Lanier Avenue	Contributing Building

This is a one story frame residential building with a side gable roof with knee braces in the wide eaves and a central hipped roof dormer with a paired 4/4 double hung sash window. The one story two bay porch has a flat roof supported on metal posts; there is a metal balustrade. The 1-story weatherboard-clad garage has a shed roof. The garage stands to the rear at the end of a driveway facing the street.

187-5001-0123	1910 ca	Contributing Building
26 Lanier Avenue	House, 26 Lanier Avenue	Contributing Building

United States Department of the Interior
National Park Service

National Register of Historic Places
Continuation Sheet

Chatham Historic District
Chatham, Virginia

Section 7 Page 45

This is a two story frame residential building with a side gable roof. It has a central peak with boxed cornice and decorative circular vents in the gable front and ends. There is a one story six bay wraparound porch with a hipped roof supported on square columns. The central door has ten light sidelights. The 1-story frame garage with weatherboard siding has a standing seam metal gable roof with exposed rafter ends. The garage is located at the rear of the dwelling, facing the side yard.

187-5001-0124	1925 ca	Contributing Building
30 Lanier Avenue	House, 30 Lanier Avenue	

This is a one and one half story frame residential building. It has a gable roof and an enclosed porch with louvered glass walls.

187-5001-0125	1910 ca	Contributing Building
34 Lanier Avenue	House, 34 Lanier Avenue	Contributing Building

This is a two story frame residential building with an intersecting gable roof; the gable front and side gable have cornice returns. The one story three bay porch has a hipped roof supported by wood posts on a weather board sided wall. The 1-story frame garage has a gable roof. The garage faces the road and is toward the rear of the dwelling.

187-5001-0126	1945 ca	Contributing Building
38 Lanier Avenue	House, 38 Lanier Avenue	

This is a one story frame residential building with an intersecting gable roof.

187-5001-0127	1910 ca	Contributing Building
42 Lanier Avenue	House, 42 Lanier Avenue	

This is a two story frame residential building with an intersecting gable roof; the gable front has cornice returns. The windows are 6/6; there are two on the second floor and one on the first. The one story three bay porch has spindlework frieze, turned columns and brackets and a turned balustrade.

187-5001-0128	1910 ca	Contributing Building
29 Lanier Avenue	House, 29 Lanier Avenue	Contributing Building
		Contributing Building

United States Department of the Interior
National Park Service

National Register of Historic Places
Continuation Sheet

Chatham Historic District
Chatham, Virginia

Section 7 Page 46

This is a two story frame residential building. The porch spans the front and intersecting gable; it has a metal balustrade. There are five brick steps leading up to the front door. This is a one story weatherboard garage with an asphalt shingle roof and exposed rafters. One story garage with weatherboard siding and asphalt shingle gable roof with exposed rafters. There is also a storage shed.

187-5001-0129
25 Lanier Avenue

1835 ca
Weir, Hugh, House

Contributing Building

This is a two story brick residential building with a side gable roof and two exterior chimney stacks on one the street side. Flanking the stacks are two double hung sash 6/9 windows; between the stacks, in the gable, is a round tracery window. The door is off-center in the three-part facade; it has an arched recessed fanlight. The five windows in the facade are 6/6 double hung sash windows.

187-5001-0130
21 Lanier Avenue

1910 ca
House, 21 Lanier Avenue

Contributing Building

This is a two story frame residential building with intersecting gable roof. In the front gable there are cornice returns and two 4/4 double hung sash windows. The door has a single rectangular transom; there is a 4/4 double hung sash window in the second story above it. The one story porch with pitched roof is supportd on square columns

187-5001-0131
17 Lanier Avenue

1910 ca
House, 17 Lanier Avenue

Contributing Building

This is as two story frame residential building with an intersecting gable roof. There are cornice returns in the front gable and there are two 2/2 double hung sash windows. In the inersecting gable, there is one 2/2 double hung sash windows above the door with rectangular transom. The porch spans the front and has turned columns, balustrade and friezework.

187-5001-0132
11 Lanier Avenue

1938
House, 11 Lanier Avenue

Contributing Building
Non-contributing Building

This is a one story brick residential building with a front gable. There is a round louvered window in the gable above an 8/8 double hung sash window with shutters. The three bay porch is supported on

United States Department of the Interior
National Park Service

National Register of Historic Places
Continuation Sheet

Chatham Historic District
Chatham, Virginia

Section 7 Page 47

metal poles. There is a one story garage with brick veneer and a gable roof. There is a garage/carport with brick veneer and a gable roof.

187-5001-0133	1970s	Non-contributing Building
12 Bank Street	Carrington Thompson-James David Jones, Attorneys	
	Brick Law Office	

This one-story brick law office has a hip roof of asphalt shingles .

187-5001-0134	1970s	Non-contributing Building
3 Payne Street	United Way and American Red Cross	
	Brick Law Office	

This one-story brick law office has a hip roof of asphalt shingles .

187-5001-0135	1970s	Non-contributing Building
9 Payne Street	Jesse W. Reid Jones, III Attorney	
	Brick Law Office	

This one-story brick law office has a hip roof of asphalt shingles .

187-5001-0136	1970s	Non-contributing Building
11-13 Payne Street	Brick Law Office	

This one-story brick law office has a hip roof of asphalt shingles .

187-5001-0137	1970s	Non-contributing Building
15 Payne Street	Crider Law Office	
	Brick Law Office	

This one-story brick law office has a hip roof of asphalt shingles and a large arched window.

187-5001-0138	1945-1950	Contributing Building
19 Pruden Street	Movie Theater, Pruden Street	

This is a one story, one bay concrete enframed block movie theater building. The facade is plain save

United States Department of the Interior
National Park Service

National Register of Historic Places
Continuation Sheet

Chatham Historic District
Chatham, Virginia

Section 7 Page 48

for the curved marquee above the five central doors and the buttresses on either side of the entry. There is a curved concrete retaining wall and stairs.

187-5001-0139	1924	Contributing Building
37 Pruden Street	Chatham High School	Non-contributing Building

This is a multi-story, four bay, brick school building; the central bay is one and one half story with a hipped roof and the flanking bays are one story with flat roof. There is a central recessed arched entry with a double leaf wood door with nine lights and a 15 light transom. In the central bay, there are ten 9/9 double-hung sash wood windows. The basement windows are in-filled on one side of the central bay.

187-5001-0140	1800-1850	Contributing Building
115 Pruden Street	Cottage, Pruden Street	

This is a one and one-half story wood residential building with a side gable roof and German siding. There is a hipped roof porch supported by wood posts on the front. There is a single leaf wood door with 6 light transom and two 2/2 double hung sash windows. There is a single shoulder chimney separated from the house.

187-5001-0141	1930s	Contributing Building
34 Pruden Street	Chatham Animal Clinic	Non-contributing Building

This is a two story concrete block commercial building with a one story side addition. There is a central storefront with two fixed plate glass and aluminum windows flanking a recessed single-leaf aluminum one-light door and transom. In the upper facade there are three wood 1/1 double-hung sash windows; in the lower facade there is a recessed entry between plate glass storefront windows and a projecting sign. This gable-roofed garage is covered with corrugated metal. There are two roll-up garage doors on the main facade.

187-5001-0142	1930 ca	Contributing Building
14 Pruden Street	Building, 14 Pruden Street	

This is a one story, plus attic, brick commercial building with a metal side gable roof. The gable side has a central recessed entry with one single leaf single light wood door and transom. There are two sets of paired 6/6 double hung sash windows; there is a fixed 20 light window with center pivot

United States Department of the Interior
National Park Service

National Register of Historic Places
Continuation Sheet

Chatham Historic District
Chatham, Virginia

Section 7 Page 49

flanked by two 6/6 double hung sash windows; there is a set of small 2/2 casement windows; there is a one multi-pane window with metal grating; there are four 6/6 casement windows. The side has five course American bond brickwork, 14 paired 6 light hopper windows, a central gable dormer, a roll-up metal door and a double leaf wood door.

187-5001-0143
25 Pruden Street

1950 ca
The Beauty Plaza
Canal Forest Resources, Inc.

Contributing Building

This is a two story, three bay, brick commercial building with a poured concrete foundation. The facade is divided by two tones of brick; the first story and the central bay are a darker brick. In the lower facade there are two fixed aluminum and plate glass windows and a single leaf, single light wood door. There are poured concrete stairs leading to the door. In the upper facade there are two sets of three 1/1 double hung sash windows and a central pair of 1/1 double hung sash windows. On the side there are seven paired 1/1 double hung sash windows; four single 1/1 double hung sash windows.

187-5001-0144
102 Reid Street

1910 ca
R.L. Deering House and Photography Studio

Contributing Building

This is a two story, wood frame residential building with a front gable roof and a one story, two bay, flat roof wood porch. The single leaf, single light wood door is off-center. There are three wood, 2/2 double hung sash windows and a set of three single light wood casement windows.

187-5001-0145
104 Reid Street

1880s
Dr. Venable House

Contributing Building

This is a one story wood frame residential building with side gable roof and one story, five bay metal porch. There is a central single leaf door flanked by two wood, 6/6 double hung sash windows.

187-5001-0146
106 Reid Street

1940 ca
Farm Bureau

Contributing Building

This is a two story masonry office building with hipped roof. There is a central single-leaf door with three light, one panel sidelights flanked by two 2/2 horizontal double hung sash windows with applied shutters. There is an overhang with vinyl siding below. The upper facade has four 2/2

United States Department of the Interior
National Park Service

National Register of Historic Places
Continuation Sheet

Chatham Historic District
Chatham, Virginia

Section 7 Page 50

horizontal double hung sash windows.

187-5001-0147	1925 ca	Contributing Building
114 Reid Street	House, 114 Reid Street	

This is a one and one-half story wood frame residential building with a side gable roof and dormers and a one story, three bay porch. The dormer windows are 6/6 double hung sash windows; on the first floor there are three 6/6 double hung sash windows and one single leaf wood door with three lights.

187-5001-0148	1915 ca	Contributing Building
118 Reid Street	House, 118 Reid Street	

This is a two story, three bay wood frame residential building with a gable roof and peak above the central entry. There is a pair of fixed, single light windows in the peak; there are three 1/1 double hung sash windows on the second story and two on the first. The door is single leaf, wood three light, one panel with leaded glass and tracery.

187-5001-0149	1905 ca	Contributing Building
122 Reid Street	House, 122 Reid Street	

This is a two and one half story wood frame residential building with intersecting gable roof and a one story, three bay wood hip roof porch with turned columns in balustrade and spindlework frieze. The front gable has cutaway bays and there is a central paired 1/1 double hung sash windows in both the first and second stories flanked by single 1/1 double hung sash windows in the bays; there is a pair of small fixed windows in the gable.

187-5001-0150	1910 ca	Contributing Building
126 Reid Street	Chatham Christian Church Parsonage	

This is a two story, wood frame residential building with a hipped roof and a one story, five bay porch with hipped roof. There are three 2/2 double hung sash windows at the second story and four paired, 1/1 double hung sash windows at the first story. There are two interior chimneys.

187-5001-0151	1870s	Contributing Building
---------------	-------	-----------------------

United States Department of the Interior
National Park Service

National Register of Historic Places
Continuation Sheet

Chatham Historic District
Chatham, Virginia

Section 7 Page 51

161 Reid Street

Corinth Christian Church ("Colored")
Corinth Christian Church

This brick church building has a front gable roof flanked on either side by a tower. One tower extends above the roofline and the other does not; both towers have a double leaf wood door and the taller one has rectangular louvered vent. The gable front has a central arched stained glass window and a round louvered vent. The church extends four bays back; this is articulated by square stained glass windows.

187-5001-0152
141 Reid Street

1925 ca
Langhorne-Jones Housset

Contributing Building
Non-contributing Building

This is a two story frame residential building with a side gable roof. The three windows on the second story are 6/6 double hung sash windows with shutters and the two on the first story are paired 6/6 double hung sash windows. The central door has no transom or sidelights. There is a one story side addition with a side gable roof and a paired 6/6 double hung sash window. There is a wrought iron fence and a stamped brick sidewalk. A metal shed stands behind the dwelling.

187-5001-0153
135 Reid Street

1850s
Rison-Hairston House

Contributing Building

This is a two story frame residential building with a hipped roof and central pedimented gable portico. The portico is supported on paired Doric columns with cushions. There are three 6/6 double hung sash windows on the second story and two on the first flanking the central double leaf door with four light transom and 2/2 sidelights. There is a wrought iron fence and stamped brick sidewalk.

187-5001-0154
125 Reid Street

1851s
Neal House
Fairytale Cottage

Contributing Building

This one and one half story frame residential building has a side gable roof with three gable dormers. The gable dormers have decorative vergeboards which continue around to the side gable end. Each dormer has a 6/6 peaked double hung sash window with peaked shutters. The porch has a hipped roof with lattice frieze supported on posts with latticework and a square balustrade; the frieze is arched over the central bay. The door has a two light transom and narrow 4/1 sidelights. There is a

United States Department of the Interior
National Park Service

National Register of Historic Places
Continuation Sheet

Chatham Historic District
Chatham, Virginia

Section 7 Page 52

one and one half story attached kitchen with gable roof and stone foundation at the rear.

187-5001-0155	1955 ca	Non-contributing Building
121 Reid Street	Allen House	Non-contributing Building
		Non-contributing Building
		Non-contributing Structure

This is a one story brick building with a side gable roof with dormers; it has a front exterior end chimney. The largest garage is 1 1/2-stories with standing seam metal saltbox roof. Weatherboard clads the frame structure. A cupola accents the roof ridge. This one-story frame garage is covered by a standing seam metal gable roof and board and batten siding. A cupola also accents the roof ridge. The secondary resources, including a tennis court, are located behind the dwelling.

187-5001-0156	1870s	Contributing Building
117 eid Street	Scruggs House	Contributing Building
		Contributing Building

This is a two story frame residential building with a hip and gable roof with tower; there are finials on the roof and the tower and gable front have scalloped shingles. There is a tripartite window in the gable front; the central window has an arched pane over a 6/2 double hung sash flanked by multi-pane sash windows. The square tower has an open second and third story and a pyramidal roof; there is a spindle work frieze supported by turned columns in the second floor porch and turned columns on the third floor porch supporting the pyramidal roof. The tower extends above the central door which has a single light transom. The one story porch has a pedimented central bay over the door and a corner turret; the porch has a hipped roof, dentilled cornice, spindle work frieze, turned columns and a turned balustrade.

The cabin, located immediately at the rear of the dwelling, is one story tall with a standing seam metal roof. One chimney is located on the roof ridge. Weatherboard siding covers the frame structure. A 1-story, 1-bay shed-roof porch and single leaf, 4-panel door accent the front elevation. A garage addition has been added at the rear. A brick pier foundation supports the structure. A one-story frame machine shed is located at the rear of the property. A standing-seam metal gable roof covers the shed and board and batten siding covers the walls.

187-5001-0157	1870s	Contributing Building
---------------	-------	-----------------------

United States Department of the Interior
National Park Service

National Register of Historic Places
Continuation Sheet

Chatham Historic District
Chatham, Virginia

Section 7 Page 53

111 Reid Street

Wilson, Dr. J.W., House

This is a two story frame residential building with a hipped roof. There are three 1/1 double hung sash windows on the second floor and two on the first flanking a central door with single light transom and 4/1 sidelights. There is a central one story three bay porch with hipped roof supported on square columns. The garage and shed stand behind the dwelling at opposite corners from the dwelling.

187-5001-0158
7 Court Place

1782,1832
Tunstall-Hargrave House

Contributing Building

This two story frame residential building has a hipped roof, round-head dormers, and a full-front, double-height porch with Chinese Chippendale balustrade at the roofline. The porch has a bracketed cornice and square columns. The house has a central panelled door with fanlight and sidelights with tracery. The five front windows are 6/6 double hung sash windows and there is a polygonal side bay. There is a stone well at the rear of the property. It may have originally belonged to the house next door. There is a well in the yard of the house next door that may or may not belong to 7 Court Street.

187-5001-0159
12 Court Place

1889
Chatham Baptist Church

Contributing Building
Non-contributing Building

This brick church is rectangular in form with pilastered walls, gabled roof and corner tower with spires. Stone detailing accentuates the buttressing on the pilasters, the pointed-arch window, the doors and the roofline. A 1920s educational wing and modern fellowship hall have been added to the rear. Concrete block building with shed roof, one story five bay porch with standing seam metal roof.

187-5001-0160
16 Court Place

1898
Chatham Clerk's Office
Tredway, James L., House
Chatham Town Office

Contributing Building
Contributing Building
Contributing Building

This 1-story, 5-bay clerk's office is ell shaped and covered by an intersecting gable roof of wood shingles. The walls and foundation are laid in Flemish bond brick. Dogtooth corbelling accents the eave. Three single-leaf wood doors lead into the structure and 2 9/9 windows give light. Two chimneys are located on the ridge, one centrally placed and the other at the eastern edge. Two-story

United States Department of the Interior
National Park Service

National Register of Historic Places
Continuation Sheet

Chatham Historic District
Chatham, Virginia

Section 7 Page 54

Italianate brick dwelling with intersecting hip and gable roof of standing seam metal. Decorative vergeboard accents the gables with pendant accents at gable ends. Arched windows feature brick hood molds. Three interior chimneys are located on various roof slopes. The wraparound brick pier porch has brick baluster. The foundation is composed of brick laid in 5-course American bond. Frame one-story gable roof shed covered with weatherboard. The Tredway dwelling is located to the front of the clerk's office and the shed is located to the north of the office.

187-5001-0161
22 Whittle Street

1890s
Christian House

Contributing Building
Non-contributing Structure

This two story frame residential building has a side gable roof with cornice returns, front corner turret, and seven bay wraparound hipped roof porch with pedimented entry bay. The porch has a square columns, scrolled brackets, a spindle-work frieze, and a turned balustrade. The windows are 6/6 double hung sash windows and the off-center door is single leaf, four panel/eight light with single light transom. There is a carport.

187-5001-0162
26 Whittle Street

1890s
House, 22 Whittle Street

Contributing Building

This one story frame residential building has an intersecting gable roof and three bay open porch with square columns, scrolled brackets, and scalloped wood detail at the frieze. It has a central single leaf, 15-light door with a two-light transom.

187-5001-0163
27 Whittle Street

1925 ca
Bess Tredway House

Contributing Building

This is a one-story brick residence with intersecting gable roof and polygonal corner bay. It has a three bay open porch. There is a pair of 6/6 double hung sash windows in the gable front, 4/4 double hung sash windows in the polygonal bay, and 6/6 double hung sash windows in the intersecting gable. There is also wood siding in the gable front. This is a frame garage with a metal gable roof and a double leaf wooden garage door oriented toward the street. There is a frame car garage with a metal roof.

United States Department of the Interior
National Park Service

National Register of Historic Places
Continuation Sheet

Chatham Historic District
Chatham, Virginia

Section 8 Page 55

8. Statement of Significance

The Town of Chatham has served as the county seat for Pittsylvania County since 1777 and as the commercial center for the surrounding rural region of tobacco-rich Southside Virginia. The Chatham Historic District includes approximately 95 acres in a linear area along Main Street, which served as an early 19th century stagecoach road. The district includes the 1853 National Historic Landmark **Pittsylvania County Courthouse** at its center as well as the site of the earlier 1782 courthouse and the surviving 1813 **Clerk's Office**. The commercial section, which dates from the late 19th to mid-20th century, flanks the courthouse to the north and south along Main Street with residential neighborhoods extending to either end of the district. Resources include five governmental buildings, 67 commercial structures, five churches, two cemeteries, two schools, one theater, and 57 dwellings. These buildings date from the late 18th century to the mid-20th century and represent a wide range of styles that reflect the prosperity of the town. Chatham continues to serve today as the county seat and to provide a center for regional and local trade. The Chatham Historic District is eligible for listing on the National Register under Criteria A for representing the broad pattern of development of a courthouse town in Southside Virginia; and, under Criteria C for the wide range of building types dating the late 18th to the mid-20th century in a variety of architectural styles. The Chatham Historic District is eligible for listing on the local level with significance in the areas of architecture, commerce, and politics/government for the period 1807 to 1950. The district includes a large number of high-style residences, two large and well-designed schools, six churches, a thriving commercial district with a hotel and three banks, as well as the courthouse and other government buildings. The number and quality of these buildings reflects the prosperity of Chatham as the county seat of the largest county in Virginia. Pittsylvania County was rich in tobacco and other agricultural products and was favored with a trunk railroad line connecting it to the two major markets of Danville and Lynchburg. For this reason, Chatham developed on a larger and grander scale than many of the other county seats in the area. Moderate growth since the second quarter of the 20th century has helped to maintain its role as county seat and to preserve the historic character of the district.

Historical Background

Colony to Nation (1750-1789)

Pittsylvania County was first formed from Halifax County in 1767 and encompassed the areas of present-day Henry, Patrick, and Pittsylvania counties. As was customary, the county seat was located at the geographic center of the county, and the first court of Pittsylvania County was held at

United States Department of the Interior
National Park Service

National Register of Historic Places
Continuation Sheet

Chatham Historic District
Chatham, Virginia

Section 8 Page 56

Callands, which was then known as Chatham, named for William Pitt, Earl of Chatham (Clement 1957:210). After the creation of Henry County from Pittsylvania County in 1777, the county's boundaries changed and the county seat was relocated to the new center near the Cherrystone Bottom Meeting House Spring in present-day Chatham, which was then referred to as simply Pittsylvania Courthouse. In 1782, plans were made for the construction of the first courthouse on land donated by Jeremiah Worsham along Cherrystone Bottom Creek. Instead, the courthouse was built on two acres donated by Richard Johnson on a hill overlooking the Cherrystone Spring on the site of the **Judge Tredway House (187-5001-0160)**. Constructed by David Hunt at a cost of 4,000 pounds of tobacco, the courthouse was a red brick structure with white columns (Clement 1929:207). Across the road from the site of the courthouse stands the **Tunstall-Hargrave House, 7 Court Street (187-5001-0158)**, built in 1782 by the county clerk William H. Tunstall. It stands today as evidence of the early development around this first courthouse.

Early National Period (1789-1830)

After 25 years, property owners along Cherrystone Bottom, who had anticipated the business generated by the court, challenged the legality of the courthouse's location in a petition to the General Assembly. To settle this dispute, the legislature issued an Act in 1807 that confirmed the present courthouse location as legal and directed that eight acres to the south and east be laid off into twelve lots of "½ acre each, with such streets and alleys as ... convenient, and be established a town by the name of Competition." The name Competition, which was changed in 1852 to Chatham, referred to the debate over the courthouse location. The survey laid out a grid system with six lots on either side of present-day Main Street. The two-acre courthouse lot was located adjacent to the grid at the northwest corner (Pittsylvania County Circuit Court Survey Book 2: front cover). The **Clerk's Office (187-5001-0160)**, constructed in 1813 on the courthouse lot, stands today as evidence of the first courthouse grounds. The town of Competition quickly began to grow with seven owners of the 12 town lots listed in the 1816 Land Books and rents for these properties ranging from twelve to one hundred dollars. By 1823, the Land Books recorded 11 of the 12 lots contained buildings with an average value of \$450 (Kern 1999:4).

Antebellum Period (1830-1860)

The period before the Civil War was a time of great growth and prosperity for the town of Competition. As the county seat, roadways were established to connect it to other county seats and businesses were established around the courthouse to serve the many travelers on court days. The Pittsylvania, Franklin and Botetourt Turnpike was chartered in 1824 and completed in 1841, followed immediately by the Pittsylvania-Lynchburg Turnpike in 1842, which connected Danville and Lynchburg with the stage road running along Main Street in Chatham. Plans were underway as

United States Department of the Interior
National Park Service

National Register of Historic Places
Continuation Sheet

Chatham Historic District
Chatham, Virginia

Section 8 Page 57

early as 1835 for a railroad through Pittsylvania County as Delegate Whitmell Tunstall of Chatham lead the efforts to complete the Richmond and Danville Railway in 1856. Pittsylvania County, still the largest county in Virginia in geographic area, ranked second in population in 1840 with 26,398 (including 11,558 slaves) and first in tobacco cultivation with 6,439,000 pounds grown annually (Melton 1993:29).

In addition to those traveling to Competition for court days, a permanent population began to settle the town as well. By 1836, Joseph Martin reported in his gazetteer that the town of Competition had a population of approximately 200 that included three attorneys, two physicians, a watchmaker, a silversmith, a tailor, a shoemaker, two blacksmiths, a wheelwright, and two tanners. In addition to the 125 dwellings noted, there were three stores, three taverns, a Methodist church, and two common schools (Martin 1836:261). By 1837, all twelve of the original town lots were occupied by buildings with an average value of \$1,000 (Kern 1999:4). The first bank, the Cash and Savings Bank, was established in 1850. In 1852, the General Assembly passed an act changing the name of the town to Chatham, in honor of William Pitt, Earl of Chatham, and authorizing the survey of additional lots to the north (Virginia General Assembly Legislative Session 1855: 271-271). The Greek-Revival style **Pittsylvania County Courthouse, 1 North Main Street (187-5001-0092)** was constructed the following year and helped spur development of the town in this new area. As evidence of the growth of the town, a number of churches were established during this period, including the Methodist Church (1830s), the Episcopal Church (1844), the Presbyterian Church (1846) and the Baptist Church (1857). Many of these early congregations built their first churches along North Main Street, where they continue to worship in newer buildings. By 1860, the population of Chatham had increased approximately 40% from 200 in 1840 to 320 (including 49 free blacks), and building values had increased to an average of \$1,400 per lot, including two hotels and a bank (Kern 1999:5).

Although none of the commercial buildings or taverns from this early period survives today, the original pattern of development centering along Main Street to either side of the courthouse, as an expansion of the 1807 survey, still exists.

Several of the early domestic structures of this period are still standing. These large antebellum houses tended to be rural in character as they occupied large tracts of land surrounding the early town and originally included many outbuildings. **The Oaks, 215 Gilmer Street (187-5001-0118)** at the northern end of town was constructed ca. 1832 by Dr. Robert Coles, son of Colonel Isaac Coles. This property was sold in 1845 to Judge George Gilmer, who served as judge of the Circuit Court from 1853 to 1860 and for whom the street is named. Directly across Main Street stands the 1840s **Dr. Richard White House, 216 North Main Street (187-5001-0011)** and the **Dr. Richard White House Kitchen, 228 North Main Street (187-5001-0010)**. **Morea, 42 Franklin Place (187-5001-**

United States Department of the Interior
National Park Service

National Register of Historic Places
Continuation Sheet

Chatham Historic District
Chatham, Virginia

Section 8 Page 58

0061), at the southern end of town, was built in 1837 as Oak Hall by the architect and merchant John Poindexter. This Federal-style dwelling is surrounded by several early outbuildings, including a school that was later used as an office. The brick, Federal-style **Hugh Weir House, 25 Lanier Street (187-5001-0129)** is different as it located closer to the center of town. Situated sideways to Lanier Street, it originally fronted Main Street with gardens extending to the street.

The Civil War (1861-1865)

Although military action did not directly affect Chatham during the Civil War, the citizens fully participated, with a number of local men surving in Pickett's Charge at Gettysburg. The Bilharz-Hull gun factory operated from 1862 to 1864 just southeast of the **Masonic Lodge, 61 North Main**. The emancipation that followed the close of the war caused significant social and economic upheaval throughout the county with its tobacco-based economy. The most tangible damage to the Town of Chatham occurred with the destruction of the Richmond and Danville Railway by Union troops during the war.

Reconstruction and New Growth (1865-1917)

Chatham recovered after the war and adjusted to the new social and economic order resulting from the Civil War. The **Pittsylvania County Courthouse** played a direct role in this adjustment to new order when the landmark cases of *Ex Parte Virginia* and *J.D. Coles* and *Virginia vs. Rives* were handed down in March 1880 to establish jury discrimination in constitutional law. The courthouse was designated a National Historic Landmark in 1986 for its role in these landmark decisions.

In 1874, the Town of Chatham was incorporated by the General Assembly and its boundaries were extended by one-quarter mile in all directions from the courthouse to encompass a total of one-and-one-half square miles. As Pittsylvania County continued to rank first in tobacco production, the railroad lines were quickly repaired and expanded in the area to provide shipping for this and other valuable crops. The Virginia Midland Railroad, later to become the Great Southern Railway, reached Chatham during the first decade after the war. By 1880, the Land Books recorded 74 developed lots in town with buildings averaging \$900 per lot in value (Kern 1999:6). The economic recovery and growth of the town was reflected in the establishment of two banks -- the Chatham Savings Bank in 1872 with Dr. Richard White as president and the Planters Bank in 1878. The General Assembly extended the town limits again in 1882 to the west to include the railroad. The 1882 boundaries remain approximately unchanged today. By 1900, the number of developed lots in town had almost doubled since 1880, with whites owning 116 lots with buildings and blacks owning 21 lots with buildings (Kern 1999:6). In addition to the two banks, the town boasted of three tobacco manufacturers, three saloons, two hotels, two liverys, and twelve attorneys (Virginia State Business

United States Department of the Interior
National Park Service

National Register of Historic Places
Continuation Sheet

Chatham Historic District
Chatham, Virginia

Section 8 Page 59

Directory 1897).

The population nearly doubled from 320 in 1860 to 600 in 1900. As the population increased, congregations outgrew their original churches and a number of new church buildings were built in the county seat within the district boundaries, often on the same site as the original. Along North Main Street, the **Chatham Presbyterian Church, 128 North Main Street (187-5001-0016)** was constructed in 1886, **Emmanuel Episcopal Church, 66 North Main Street (187-5001-0022)** replaced its structure in 1881, and Watson United Methodist Church built new structures in 1874 and 1896. The Episcopal Church furthered their presence in town with the establishment of Chatham Hall for Girls in 1894 by Dr. Chiswell Dabney, minister of the Episcopal Church. In 1895, the school began to rent the home and property of John Gilmer, known as Chatham Hall, that stands just to the east of town and the district. **Chatham Baptist Church, 12 Court Street (187-5001)** was constructed in 1889 with money from the Hargrave family, who also supported the establishment of the Chatham Training School (Hargrave Military Academy) in 1909, located just to the west of town and the district. Although these two private schools lie outside the district boundaries, they were founded by local residents and leading citizens of Chatham and were supported by the churches and town residents of the present historic district. The schools provided education as well as employment to many of these residents and have continued to the present day as an integral part of the town. The founding of Chatham **Christian Church, 135 South Main Street (187-5001-0076)** at the south end of town reflected to expansion of the town in that direction. Two cemeteries, the **Chatham Burial Park (187-5001-0058)** and the **Colored Cemetery (187-5001-0062)** were also established at the south end of town during the late 19th century. The **Masonic Lodge, 61 North Main Street (187-5001-0098)**, constructed at the turn of the century, gives evidence of the of Chatham's sense of community and civic involvement.

The residential neighborhoods of North and South Main Street also developed during this period. The pattern of development shifted from the antebellum homes on large tracts of land to more regular lot sizes and somewhat uniform setbacks from the street. Nearly 75% of the houses in this area date to the late 19th and early 20th century with the Queen-Anne style dominating the designs. Prominent citizens of Chatham, who were active in the local and state governments, the local commerce, the churches, and the two private schools, resided in the numerous dwellings that survive today.

World War I and World War II (1917-1945)

With the exception of the years of the Great Depression, Chatham experienced another population boom in the period between the two World Wars. By 1920, the population had increased by 100%

United States Department of the Interior
National Park Service

National Register of Historic Places
Continuation Sheet

Chatham Historic District
Chatham, Virginia

Section 8 Page 60

from 600 inhabitants in 1900 to 1200 and the number of developed lots in town nearly doubled with an average in value of \$1,7500 per lot (Kern 1999:6). The infrastructure of the town improved greatly during this period. By 1917, it was serviced by the Chatham Light and Power Company, being one of the earliest Virginia towns to have gas lights, as well as the Chesapeake & Potomac Telephone Company of Virginia (Virginia Business Directory and Gazetteer 1917). A new water plant was established in 1924 and the water tank was constructed in 1934 in the northwest section of town as a P.W.A. project (Town of Chatham, Virginia 1936:5). The 1930s **United States Post Office, 31 South Main Street (187-5001-0083)** gave the post office a permanent home and the 1938 **Moses Building, 11 North Main Street (187-5001-0093)**, located just north of the courthouse, provided expanded space for town and county offices. The increasing population necessitated the building of new schools as well with the **Chatham High School, Pruden Street (187-5001-0139)** constructed in 1924 followed by the **Chatham Elementary School and Library, 319-323 South Main Street (187-5001-0065)** in 1925.

Described as a “banking town,” the commercial district of Chatham thrived during the prosperous years of the 1920s and the 1940s. The town and surrounding county supported four local banks, including the **Planters Bank and Trust, 2-4 North Main Street (187-5001-0033)**, the **Chatham Savings Bank, 1-9 South Main Street (187-5001-0091)**, and the **First National Bank, 25 South Main Street (187-5001-0085)**. The financial success of these banks, which had been established in the late 19th century, is reflected in their impressive Neoclassical facades of the 1920s. Over half of the commercial buildings in the district date to this period. In addition to the traditional offices and businesses that cater to the court activities or the surrounding rural community, new businesses such as automobile dealers and service stations, movie theaters, and streetcar diners, expanded the town’s commerce. The 1936 town directory lists five automobile dealers, one automobile storage business, and eleven gasoline stations. Located at the north and south entrances town, three service in the district survive from this period, including the ca. 1940 **Harris Service Station, 300 North Main Street (187-5001-0001)**, the 1920s **Standard Oil Company Service Station, 153 South Main Street (187-5001-0074)**, and the **Sours Service Company, 301 North Main Street (187-5001-0116)**. In addition to the ca. 1945 **Movie Theater, Pruden Street (187-5001-0138)**, the Chatham Recreation Parlor, which featured billiards, and the Chatham Sport Shoppe advertised “amusements” in 1936. Perhaps the most notable new business in Chatham was the introduction of two streetcar diners, **Bill’s Diner, 1 Depot Street (187-5007-0044)** and **Burnett’s Diner, 19 South Main Street (187-5001-0087)**. These diners, located in discarded streetcars, reflect the resourcefulness of the Depression era as well as the popularity of the “lunch-cart” business.

The residential areas of North and South Main Street continued to develop during the second quarter

United States Department of the Interior
National Park Service

National Register of Historic Places
Continuation Sheet

Chatham Historic District
Chatham, Virginia

Section 8 Page 61

of the 20th century. As the population increased, the larger tracts of the earlier homes continued to be subdivided to provide more building lots. Main Street continued to be the “premier address” with large homes constructed by leading citizens in a variety of styles, including Queen Anne, Colonial Revival, and Craftsman.

The New Dominion (1945 to present)

Chatham has remained relatively unchanged since the end of World War II. The town boundaries follow basically the same lines determined by the General Assembly in 1882 and the population has not changed significantly, with the present population totaling 1,400 (Kern 1999:6). The area of the district was almost entirely developed by the 1950s and property values have remained relatively constant. While a few buildings have been replaced with newer construction along Main Street, the blocks remain relatively intact. The largest new building constructed is the 1954 **Armory Building, 326, South Main Street (187-5001-0059)** on the site of an earlier school. The one block of Payne Street, located one block off of South Main Street southeast of the courthouse, includes several identical duplex buildings constructed in the late 1960s and used for law offices. The largest concentration of new construction that is non-contributing to the district is located near the intersection of South Main and Depot streets where a service stations and automobile dealerships were located. Chatham continues to serve today as the governmental center for Pittsylvania County and the commercial center for the rural region surrounding it.

United States Department of the Interior
National Park Service

National Register of Historic Places
Continuation Sheet

Chatham Historic District
Chatham, Virginia

Section 9 Page 62

Bibliography

Beckett, Anne Stuart and John R. Kern, "Preliminary Information Form: Chatham Historic District," 1999.

Boyd's Virginia State Business Directory, 1871-1872.

Chadwick-Healey Inc. *The Sanborn Fire Insurance Maps: Chatham, Virginia.* 1886-1926.

Chataigne, J.H. *Chataigne's Virginia Business Directory and Gazetteer, 1880.* Richmond, Virginia: Boughman Brothers, 1880.

Chataigne's Virginia Business Directory and Gazetteer, 1884-1885. Richmond, Virginia: Boughman Brothers, 1885.

Chataigne's Virginia Business Directory and Gazetteer, 1893-1894. Richmond, Virginia: Boughman Brothers, 1894.

Clement, Maud Carter. *The Early Homes of Chatham: An Old Virginia Courthouse Town.* Chatham, Virginia: The Maud Clement Garden Club, 1957.

The History of Pittsylvania County. Lynchburg, Virginia: The J.P. Bell Company, Inc., 1929.

Writings of Maud Carter Clement. Chatham, Virginia: Pittsylvania Historical Society, 1982.

Gray's New Map of Chatham, Pittsylvania County, Virginia. Philadelphia: D.W.Gray & Son, 1878.

Hurt, Frances Hallam. *Eighteenth Century Landmarks of Pittsylvania County, Virginia.* Lynchburg, Virginia: Pittsylvania Bicentennial Celebration, 1967.

Martin, Joseph. *A New and Comprehensive Gazetteer of Virginia.* Charlottesville, Virginia: Mosely & Tompkins, Printers, 1836.

Melton, Herman. *Picks, Tracks, and Bataeux: Industry in Pittsylvania County 1750-1950.* Lynchburg, Virginia: H.W. Howare, 1993.

Pittsylvania County Circuit Court, Old Surveys, vol 1. pp. 244; vol. 2, front of book.

United States Department of the Interior
National Park Service

National Register of Historic Places
Continuation Sheet

Chatham Historic District
Chatham, Virginia

Section 9 Page 63

“Town of Chatham, Virginia.” Publisher unknown, 1936. Partial copy of directory given to the author by the town clerk’s office.

Tredway, Page. *Chatham Baptist Church, Chatham, Virginia: A Child’s Recollections. What our churches have contributed in material ways to our town.* Danville, Virginia: J.P. Thomas Printing Company, no date.

Virginia General Assembly Legislative Session, 1855.

Virginia State Directory and Gazetteer 1917. Richmond, Virginia: Hill Directory Company, 1917.

Virginia Department of Historic Resources Survey Files (various). Richmond, Virginia.

United States Department of the Interior
National Park Service

National Register of Historic Places
Continuation Sheet

Chatham Historic District
Chatham, Virginia

Section 10 Page 64

GEOGRAPHIC DATA

Verbal Boundary Description

The boundaries of the Chatham Historic District are indicated by the heavy dashed line on the enclosed sketch map of the property, derived from the town tax map and drawn at a scale of 1" = 200'.

Boundary Justification

The boundaries of the Chatham Historic District encompass all those contiguous areas of the historic commercial, governmental, and residential core of Chatham that reflect its historic character as established during the period of significance and that retain sufficient integrity of form and materials. The district includes the original gridded town plan, dating from 1807, as well as the majority of the area encompassed by the 1882 town boundaries. Areas that project from the otherwise regular and linear form centering along Main Street include: the area bordered by Lanier and Pruden streets directly behind the courthouse to the east, including the 1924 Chatham High School complex; the diagonal street of Reid Street, located one block east of South Main Street to include a significant mid- to late 19th century residential development; and Court Place and Whittle Street one block to the west of North Main Street to include the original courthouse site and the surviving 1813 Clerk's Office. The area along Depot and Ridge streets west to the railroad, Whittle Street west of Main Street, and Hargrave Street and Hargrave Military Academy may be surveyed to determine their potential for inclusion in an expanded district.

United States Department of the Interior
National Park Service

National Register of Historic Places
Continuation Sheet

Chatham Historic District
Chatham, Virginia

Section Photographs Page 65

All photographs are of:

Property: Chatham Historic District
Location: Chatham, Virginia
VDHR File#: 187-5001
Photographer: Alison Blanton
Negatives Filed: Virginia State Library and Archives

PHOTO 1

View: 1 North Main Street, looking east
Pittsylvania Courthouse
Date: December 1999
Neg #: 18175-8A

PHOTO 2

View: 2-38 North Main Street, west side, looking northwest
Planters Bank & Trust
Date: July 2000
Neg #: 18576-28A

PHOTO 3

View: 17-31 South Main Street, east side, looking southeast
Burnett's Diner, Elliott's Hardware, 1st National Bank, Collie Hotel, US Post
Office
Date: July 2000
Neg #: 18576-29A

PHOTO 4

View: 100 block South Main Street, west side, looking northwest
Bill's Diner, Hunt's Motor Company
Date: July 2000
Neg #: 18576-30A

PHOTO 5

View: 115-131 South Main Street, east side, looking southeast
Gammon Motor Company, Chatham Knitting Mill, Grubb Auto Parts (NC)
Date: July 2000
Neg #: 18576-31A

United States Department of the Interior
National Park Service

National Register of Historic Places
Continuation Sheet

Chatham Historic District
Chatham, Virginia

Section Photographs Page 66

PHOTO 6

View: 11-37 North Main, east side, looking southeast
Chatham Cleaners, Millner Building, Moses Building
Date: July 2000
Neg #: 18576-26A

PHOTO 7

View: 65-55 North Main Street, west side, looking southeast
J. Hardcastle House, Masonic Lodge, Virginia Bank & Trust (NC)
Date: July 2000
Neg #: 18576-6A

PHOTO 8

View: 12-16 Court Place, looking east
Chatham Baptist Church, Judge Tredway House/Chatham Town Hall
Date: July 2000
Neg #: 18576-11A

PHOTO 9

View: 128-136 North Main Street, west side, looking northwest
Chatham Presbyterian Church, Watson Memorial United Methodist Church (NC)
Date: July 2000
Neg #: 18576-8A

PHOTO 10

View: 117 Reid Street, looking northeast
Scruggs House
Date: July 2000
Neg #: 18576-13A

PHOTO 11

View: 25-21 Lanier Street, south side, looking southeast
Hugh Weir House
Date: July 2000
Neg #: 18576-7A

United States Department of the Interior
National Park Service

National Register of Historic Places
Continuation Sheet

Chatham Historic District
Chatham, Virginia

Section Property Owners Page 67

PROPERTY OWNERS

ADDRESS	OCCUPANT	OWNER	ADDRESS	CITY	STATE	ZIP
2 S MAIN	AMERICAN GENERAL FIN.	DOHERTY, ANDREW	P. O. BOX 70	CHATHAM	VA	24531
4 S MAIN	WOODFINS	DOHERTY, ANDREW	P. O. BOX 70	CHATHAM	VA	24531
6 S MAIN	DR. RANDOLPH	KAREN RANDOLPH	P. O. BOX 430	CHATHAM	VA	24531
10 S MAIN	HENRY DAVIS	HENRY DAVIS	P. O. BOX 827	CHATHAM	VA	24531
12 S MAIN	E. G COLES IN	JOHN HUNT	108 MILITARY DR	CHATHAM	VA	24531
14 S MAIN	PINO'S	JOHN HUNT	108 MILITARY DR	CHATHAM	VA	24531
16 S MAIN	KIM'S SCHOOL	JOHN HUNT	108 MILITARY DR	CHATHAM	VA	24531
18 S MAIN	PCCA	PITTS. CO	P. O. BOX 426	CHATHAM	VA	24531
22 S MAIN	ART BARBER	CHARLES WINDLEY	P. O. BOX 147	CHATHAM	VA	24531
24 S MAIN	GOODWILL	CAROL NEAL, HENRY HURT	P. O. BOX 994	CHATHAM	VA	24531
26 S MAIN	VACANT	DHNM JOINT VENTURE	P. O. BOX 994	CHATHAM	VA	24531
28 S MAIN	CHATHAM FURN	J W THOMASSON	6712 MOUNT CROSS RD	DANVILLE	VA	24540
30 S MAIN	HAMPCO	TOWN OF CHATHAM	P. O. BOX 370	CHATHAM	VA	24531
1 DEPOT ST	STREETCAR	WALTER WHITTLE	280 HODNETT'S MILL RD	CHATHAM	VA	24531
108 S MAIN	CHATHAM OIL	ELIZABETH DAVENPORT	P. O. BOX 879	CHATHAM	VA	24531
116 S MAIN	CHATHAM OIL WAREHOUSE	ELIZABETH DAVENPORT	P. O. BOX 879	CHATHAM	VA	24531
118 S MAIN	EXPRESS MART OFFICE	ELIZABETH DAVENPORT	P. O. BOX 879	CHATHAM	VA	24531
120 S MAIN	HARRIS, HARVEY & NEAL	ELIZABETH DAVENPORT	P. O. BOX 879	CHATHAM	VA	24531
128 S MAIN	DOLLAR GENERAL	PEOPLE'S NATIONAL BANK	P. O. BOX 1658	DANVILLE	VA	24543
140 S MAIN	PEOPLE'S BANK	PEOPLE'S NATIONAL BANK	P. O. BOX 1658	DANVILLE	VA	24543
146 S MAIN	R POOLE	FRED TURNER	P. O. BOX 1022	CHATHAM	VA	24531
152 S MAIN	MICHEAL BROOMELL	MICHEAL BROOMELL	P. O. BOX 816	CHATHAM	VA	24531
158 S MAIN	ROBERT PLASZCZ	ROBERT PLASZCZ	P. O. BOX 887	CHATHAM	VA	24531
162 S MAIN	MARYLN McCRUDDEN	MARYLN McCRUDDEN	P. O. BOX 25	CHATHAM	VA	24531
204 S MAIN	CARL WILLIS	CARL WILLIS	P. O. BOX 1193	CHATHAM	VA	24531
214 S MAIN	THE COLUMNS	FRED TURNER	P. O. BOX 1022	CHATHAM	VA	24531
220 S MAIN	VACANT	FAY GROOME	2510 CHERRYSTONE LANE	RICHMOND	VA	23235
236 S MAIN	VACANT	WALLACE DAWSON	P. O. BOX 404	CHATHAM	VA	24531
326 S MAIN	NATION GUARD ARMORY	PITTS CO	P. O. BOX 426	CHATHAM	VA	24531
348 S MAIN	VACANT	HUGH WILLIS	P. O. BOX 530	CHATHAM	VA	24531
5 FRANKLIN	TERRY WRIGHT	TERRY WRIGHT	5 FRANKLIN PLACE	CHATHAM	VA	24531
13 FRANKLIN	STUART DODSON	STUART DODSON	P. O. BOX 860	CHATHAM	VA	24531
19 FRANKLIN	CYNTHIA LOVELACE	CYNTHIA LOVELACE	P. O. BOX 981	CHATHAM	VA	24531
27 FRANKLIN	ROBERT ADAMS	ROBERT ADAMS	27 FRANKLIN PLACE	CHATHAM	VA	24531
35 FRANKLIN	VICTOR MILLNER	VICTOR MILLNER	P. O. BOX 110	CHATHAM	VA	24531
42 FRANKLIN	RICHARD AREY	RICHARD AREY	42 FRANKLIN PLACE	CHATHAM	VA	24531
1 TO 9 S MAIN	FIRST CITIZENS	FIRST CITIZENS	112 E HICKS ST	LAWRENCEVILLE	VA	23868
11 S MAIN	CHATHAM OIL	ELIZABETH DAVENPORT	P. O. BOX 1069	CHATHAM	VA	24531
15 S MAIN	MERRIWEATHER	HARGRAVE MIL AC.	200 MILITARY DRIVE	CHATHAM	VA	24531
17 S MAIN	EASLEY INS	SUTERRAE, INC	P. O. BOX 898	CHATHAM	VA	24531

United States Department of the Interior
National Park Service

National Register of Historic Places
Continuation Sheet

Chatham Historic District
Chatham, Virginia

Section Property Owners Page 68

19 S MAIN ST	STREET CAR	SUTERRAE, INC	P. O. BOX 898	CHATHAM	VA	24531
21 S MAIN	21 MEETING STREET	CAMDEN WHITEHEAD	P. O. BOX 310	CHATHAM	VA	24531
25 S MAIN	PAT'S PLACE	PATRICIA NEWBY	P. O. BOX 1094	CHATHAM	VA	24531
27 S MAIN	W'M PITT HOTEL	MICHAEL ALBRIGHT	302 HAMPTON DR	DANVILLE	VA	24540
31 S MAIN	US POST OFFICE	U S GOVERNMENT	P. O. BOX 9999	CHATHAM	VA	24531
35 S MAIN	WORSHAM APP	EARL HEDRICK	124 HEDRICK DR	CHATHAM	VA	24531
37 S MAIN	EARL HEDRICK	EARL HEDRICK	124 HEDRICK DR	CHATHAM	VA	24531
41 S MAIN	COUNTRY CLIPPERS	EVA R MOTLEY	624 S MAIN ST	CHATHAM	VA	24531
115 S MAIN	B&B MOTORS	HENRY BURNETT	P. O. BOX 911	CHATHAM	VA	24531
119 S MAIN	CHATHAM KNITTING MILL	MATTHEW J HARRIS	2833 FINCH DR	DANVILLE	VA	24540
131 S MAIN	GRUBB AUTO	JOHN GRUBB	P. O. BOX 222	CHATHAM	VA	24531
135 S MAIN	CHATHAM CHRISTIAN CH	% JUDE CRADDOCK	P. O. BOX 969	CHATHAM	VA	24531
147 S MAIN	SCOTT FUNERAL HOME	SCOTT FUNERAL HOME	P. O. BOX 313	CHATHAM	VA	24531
153 S MAIN	FAS MART	ABERCROMBIE CORP	200 RIVER ST	DANVILLE	VA	24540
205 S MAIN	RICHARD WATSON	RICHARD WATSON	P. O. BOX 1075	CHATHAM	VA	24531
209 S MAIN	DAVID LYLE	DAVID LYLE	P. O. BOX 1194	CHATHAM	VA	24531
219 S MAIN	JOSEPH BLOOMER	JOSEPH BLOOMER	P. O. BOX 405	CHATHAM	VA	24531
225 S MAIN	VACANT	GIRARD THOMPSON, JR	P. O. BOX 570	CHATHAM	VA	24531
231 S MAIN	ELSIE ALLEN	ELSIE ALLEN	P. O. BOX 455	CHATHAM	VA	24531
237 S MAIN	EDWIN COOPER	EDWIN COOPER	P. O. BOX 1034	CHATHAM	VA	24531
301 S MAIN	MARY CATHERINE PLASTER	MARY CATHERINE PLASTER	P. O. BOX 888	CHATHAM	VA	24531
309 S MAIN	LELAND MOSCHLER	LELAND MOSCHLER	P. O. BOX 995	CHATHAM	VA	24531
319 S MAIN	CHATHAM ELEM SCHOOL	PITTS CO SCHOOL BOARD	P. O. BOX 232	CHATHAM	VA	24531
323 S MAIN	SCHOOL ANNEX	PITTS CO SCHOOL BOARD	P. O. BOX 232	CHATHAM	VA	24531
335 S MAIN	VACANT	CHATHAM HALL	800 CHATHAM HALL CIRCLE	CHATHAM	VA	24531
343 S MAIN	C B CUNDIFF	C B CUNDIFF	343 S MAIN	CHATHAM	VA	24531
401 S MAIN	PATRICIA EASLEY	CHARLES WILLIAMS	P. O. BOX 966	CHATHAM	VA	24531
411 S MAIN	AMY REYNOLDS	AMY REYNOLDS	P. O. BOX 164	CHATHAM	VA	24531
415 S MAIN	DEAN CAMBURIDES	DEAN CAMBURIDES	P. O. BOX 1041	CHATHAM	VA	24531
421 S MAIN	HARTWELL MOTLEY	HARTWELL MOTLEY	P. O. BOX 674	CHATHAM	VA	24531
425 S MAIN	HILDA BROOKS	HILDA BROOKS	P. O. BOX 261	CHATHAM	VA	24531
431 S MAIN	RON JONES	RON JONES	P. O. BOX 1123	CHATHAM	VA	24531
7 COURT PLACE	VIRGINIA OSWALT	VIRGINIA OSWALT	P. O. BOX 704	CHATHAM	VA	24531
12 COURT PLACE	CHATHAM BAPTIST CHURCH	CHATHAM BAPTIST CHURCH	P. O. BOX 104	CHATHAM	VA	24531
16 COURT PLACE	CHATHAM TOWN HALL	CHATHAM TOWN HALL	P. O. BOX 370	CHATHAM	VA	24531
22 WHITTLE ST	VACANT	HOWELL WATSON, JR	2701 RIVER OAKS DR	MIDLOTHIAN	VA	23113
26 WHITTLE ST	DECOURNEY LUCAS	DECOURSEY LUCAS	P. O. BOX 975	CHATHAM	VA	24531
38 WHITTLE ST	LOIS LOGAN	LOIS LOGAN	38 WHITTLE ST	CHATHAM	VA	24531
44 WHITTLE	RENTER	MARY ELLEN MORMANN	97 TIMBER RIDGE DR	WESTMINSTER	MD	21157
27 WHITTLE ST	RUTH BURSCHER	VIRGINIA OSWALT	P. O. BOX 704	CHATHAM	VA	24531
39 WHITTLE ST	RICHARD DIXON	RICHARD DIXON	1200 N QUAKER LANE	ALEXANDERIA	VA	22302
45 WHITTLE ST	MICHEAL MACON	CHATHAM BAPTIST CH	P. O. BOX 104	CHATHAM	VA	24531
2 N MAIN ST	WACHOVIA	WACHOVIA	P. O. BOX 700	CHATHAM	VA	24531

(8-86)

**United States Department of the Interior
National Park Service**

**National Register of Historic Places
Continuation Sheet**

**Chatham Historic District
Chatham, Virginia**

Section Property Owners **Page** 69

4 N MAIN ST	OVERBEY LAW OFF	WACHOVIA	P. O. BOX 700	CHATHAM	VA	24531
6 N MAIN ST	BOPPA	THOMAS LIPOLI	2770 HEUTTE DR	NORFOLK	VA	23518
10 N MAIN ST	VACANT	RICHARD DIXON	1200 N QUAKER LANE	ALEXANDERIA	VA	22302
12 N MAIN ST	RUDOLPH SHUPIK	THOMAS COX	519 MAIN ST	DANVILLE	VA	24541
14 N MAIN ST	BARGAIN SHOP	ANDREW WALL	719 S MAIN ST	CHATHAM	VA	24531
16 N MAIN ST	BARGAIN SHOP	ANDREW WALL	719 S MAIN ST	CHATHAM	VA	24531
20 N MAIN ST	M & W FLOWERS	JERRY MOSCHLER & CHARLES WILLIAMS	P. O. BOX 966	CHATHAM	VA	24531
28 N MAIN ST	CHATHAM CHIROP.	L. ELTON PRUITT	P. O. BOX 1028	CHATHAM	VA	24531
30 N MAIN ST	STAR TRIBUNE	CHARLES WOMACK	419 MAPLE LANE	DANVILLE	VA	24541
32 N MAIN ST	DR. LAWRENCE	LLOYD LAWRENCE	P. O. BOX 1051	CHATHAM	VA	24531
36 N MAIN ST	PEDO	BILLIE REYNOLDS	P. O. BOX 304	CHATHAM	VA	24531
60 N MAIN ST	DR. THOMPSON	GIRARD V THOMPSON, SR	P. O. BOX 570	CHATHAM	VA	24531
66 N MAIN ST	EMMANUEL EPISCOPAL CH	EMMANUEL EPISCOPAL CH	P. O. BOX 1143	CHATHAM	VA	24531
102 N MAIN ST	TODD SEASE	TODD SEASE	P. O. BOX 912	CHATHAM	VA	24531
106 N MAIN ST	CLAUDE WHITEHEAD	CLAUDE WHITEHEAD	P. O. BOX 437	CHATHAM	VA	24531
112 N MAIN ST	PAUL HAROLD	PAUL HAROLD	P. O. BOX 943	CHATHAM	VA	24531
118 N MAIN ST	JAMES D JONES	JAMES D JONES	P. O BOX 95	CHATHAM	VA	24531
124 N MAIN ST	VACANT	CHARLES HODGIN	202 RUSKIN RD	PEACHTREE	GA	30269
128 N MAIN ST	CHATHAM PRESBY. CH	CHATHAM PRESBY. CH	11 LANIER AVE	CHATHAM	VA	24531
132 N MAIN ST	CHARLES WICKHAM	METHODIST PARSONAGE	P. O. BOX 569	CHATHAM	VA	24531
136 N MAIN ST	WATSON MEM U M CH	WATSON MEM U M CH	P. O. BOX 339	CHATHAM	VA	24531
144 N MAIN ST	CATHERINE OVERBEY	CATHERINE OVERBEY	P. O. BOX 374	CHATHAM	VA	24531
202 N MAIN ST	VACANT	RICHARD MEYERS, JR	123 ROSE VALLEY RD	WALLINGFORD	PA	19086
216 N MAIN ST	ROBERT HURT	ROBERT HURT	P. O. BOX 30	CHATHAM	VA	24531
228 N MAIN ST	MARK THOMAS	MARK THOMAS	228 N MAIN ST	CHATHAM	VA	24531
232 N MAIN ST	GREG VICKREY	GREG VICKREY	232 N MAIN ST	CHATHAM	VA	24531
238 N MAIN ST	JEANETT PRICE	JEANETT PRICE	P. O. BOX 146	CHATHAM	VA	24531
242 N MAIN ST	JAMES McDOLLE	JAMES McDOLLE	242 N MAIN ST	CHATHAM	VA	24531
246 N MAIN ST	GEORGE HALEY	GEORGE HALEY	P. O. BOX 904	CHATHAM	VA	24531
252 N MAIN ST	TERESA FULLER	TERESA FULLER	P. O. BOX 1137	CHATHAM	VA	24531
256 N MAIN ST	TERRY CREWS	TERRY CREWS	P. O. BOX 782	CHATHAM	VA	24531
262 N MAIN ST	LAURA ADCOCK	LAURA ADCOCK	262 N MAIN ST	CHATHAM	VA	24531
270 N MAIN ST	HERMAN MELTON	HERMAN MELTON	270 N MAIN ST	CHATHAM	VA	24531
1 N MAIN ST	PITTS CO	PITTS CO	P. O. BOX 426	CHATHAM	VA	24531
11 N MAIN ST	MOSES BUILD	PITTS CO	P. O. BOX 426	CHATHAM	VA	24531
31 N MAIN ST	MILLNER BUILD.	VICTOR MILLNER	P. O. BOX 110	CHATHAM	VA	24531
33 N MAIN ST	COUNTRY LIVING		P. O. BOX 110	CHATHAM	VA	24531
37 N MAIN ST	CHATHAM CLEANERS	JOSEPH DEHART	2668 HODNETTS MILL RD	CHATHAM	VA	24531
53 N MAIN ST	911 BUILDING	PITTS CO	P. O. BOX 426	CHATHAM	VA	24531
55 N MAIN ST	VA BANK & TRUST	ELTON J TOLER	P. O. BOX 151	CHATHAM	VA	24531
61 N MAIN ST	TUNE & TOLER		P. O. BOX 151	CHATHAM	VA	24531
65 N MAIN ST	JOHN HARDCASTLE	JOHN HARDCASTLE	P. O. BOX 878	CHATHAM	VA	24531
69 N MAIN ST	JULIA BENNETT	JULIA BENNETT	P. O. BOX 287	CHATHAM	VA	24531

United States Department of the Interior
National Park Service

National Register of Historic Places
Continuation Sheet

Chatham Historic District
Chatham, Virginia

Section Property Owners Page 70

73 N MAIN ST	BRYON WENTWORTH	BRYON WENTWORTH	73 N MAIN ST	CHATHAM	VA	24531
103 N MAIN ST	DALE POWELL	DALE POWELL	103 N MAIN ST	CHATHAM	VA	24531
111 N MAIN ST	JOHN BORLEY	EPISCOPAL RECTORY	P. O. BOX 1143	CHATHAM	VA	24531
117 N MAIN ST	GEORGE JONES	GEORGE JONES	P. O. BOX 775	CHATHAM	VA	24531
121 N MAIN ST	MARY WHITE	MARY WHITE	P. O. BOX 908	CHATHAM	VA	24531
127 N MAIN ST	VACANT	WANDA COCKE	P. O. BOX 1026	CHATHAM	VA	24531
131 N MAIN ST	JOHN CASHMAN	JOHN CASHMAN	P. O. BOX 1051	CHATHAM	VA	24531
145 N MAIN ST	VADEN WRIGHT	VADEN WRIGHT	P. O. BOX 1157	CHATHAM	VA	24531
151 N MAIN ST	R V OVERBEY	R V OVERBEY	P. O. BOX 460	CHATHAM	VA	24531
201 GILMER DR	GIRARD THOMPSON, SR	GIRARD THOMPSON, SR	P. O. BOX 570	CHATHAM	VA	24531
211 GILMER DR	ROBERT THOMPSON	ROBERT THOMPSON	P. O. BOX 231	CHATHAM	VA	24531
215 GILMER DR	HENRY HURT, JR	HENRY HURT, JR	P. O. BOX 994	CHATHAM	VA	24531
227 N MAIN ST	SUGG	HENRY HURT, JR	P. O. BOX 994	CHATHAM	VA	24531
235 N MAIN ST	STEVE FINKNER	STEVE FINKNER	P. O. BOX 84	CHATHAM	VA	24531
241 N MAIN ST	DONALD SUTTON	DONALD SUTTON	P. O. BOX 1003	CHATHAM	VA	24531
245 N MAIN ST	THOMAS MILETTE	THOMAS MILETTE	245 N MAIN ST	CHATHAM	VA	24531
253 N MAIN ST	BRET MOTLEY	BRET MOTLEY	253 N MAIN ST	CHATHAM	VA	24531
263 N MAIN ST	SUPER DOLLAR #29	ALICE WYNNE	P. O. BOX 1120	HALIFAX	VA	24558
267 N MAIN ST	OLD DUTCH	ALICE WYNNE	P. O. BOX 1120	HALIFAX	VA	24558
128 HURT ST	JESSE SOURS	JESSE SOURS	301 NORTH MAIN ST	CHATHAM	VA	24531
201 GILMER DR	GIRARD THOMPSON, SR	GIRARD THOMPSON, SR	P O BOX 571	CHATHAM	VA	24531
211 GILMER DR	ROBERT THOMPSON	ROBERT THOMPSON	P O BOX 231	CHATHAM	VA	24531
215 GILMER DR	HENRY HURT, JR	HENRY HURT, JR	P O BOX 994	CHATHAM	VA	24531
11 LANIER AVE	CLAUDE EMERSON	CLAUDE EMERSON	11 LANIER AVE	CHATHAM	VA	24531
17 LANIER AVE	M QUINBY MOTLEY	M QUINBY MOTLEY	P O BOX 675	CHATHAM	VA	24531
21 LANIER AVE	FRANCIS WHARTON	FRANCIS WHARTON	21 LANIER AVE	CHATHAM	VA	24531
25 LANIER AVE	HUGH WILLIS	HUGH WILLIS	P O BOX 256	CHATHAM	VA	24531
29 LANIER AVE	JANE REYNOLDS	JANE REYNOLDS	P O BOX 815	CHATHAM	VA	24531
27 LANIER AVE	CARRIE TATE AYLER	CARRIE TATE AYLER	P O BOX 16	CHATHAM	VA	24531
41 LANIER AVE	JAMES BARKER	JAMES BARKER	P O BOX 923	CHATHAM	VA	24531
45 LANIER AVE	TERRY ANDREWS	TERRY ANDREWS	P O BOX 148	CHATHAM	VA	24531
53 LANIER AVE	ERIC ROBERTS	ERIC ROBERTS	53 LANIER STREET	CHATHAM	VA	24531
59 LANIER AVE	FAYE FRANCES	FAYE FRANCES	59 LANIER AVE	CHATHAM	VA	24531
18 LANIER AVE	CLINTON RICHARDS	CLINTON RICHARDS	18 LANIER AVE	CHATHAM	VA	24531
22 LANIER AVE	BOBBY TANKSLEY	BOBBY TANKSLEY	22 LANIER AVE	CHATHAM	VA	24531
26 LANIER AVE	SUE HOLLOWAY	SUE HOLLOWAY	3414 WARNER RD	RICHMOND	VA	23225
30 LANIER AVE	JIM TUNG	JIM TUNG	30 LANIER AVE	CHATHAM	VA	24531
34 LANIER AVE	ALAN CASPER	ALAN CASPER	34 LANIER AVE	CHATHAM	VA	24531
38 LANIER AVE	JERRY HASTING	JERRY HASTING	P O BOX 641	CHATHAM	VA	24531
42 LANIER AVE	GARY BARKER, JR	GARY BARKER, JR	42 LANIER AVE	CHATHAM	VA	24531
3 PAYNE ST	RED CROSS		3 PAYNE ST	CHATHAM	VA	24531
7 PAYNE ST						
11 PAYNE ST	FRED SHANKS	FRED SHANKS	132 SOUTHLAND CT	DANVILLE	VA	?
13 PAYNE ST	FRED SHANKS	FRED SHANKS	"	"	"	?

United States Department of the Interior
National Park Service

National Register of Historic Places
Continuation Sheet

Chatham Historic District
Chatham, Virginia

Section Property Owners Page 71

15 PAYNE ST	HENRY CRIDER	HENRY CRIDER	P O BOX 8	CHATHAM	VA	24531
19 PRUDEN ST	VACANT THEATER	PITTS CO	P O BOX 426	CHATHAM	VA	24531
37 PRUDEN ST	CHATHAM HIGH SCHOOL	PITTS CO	P O BOX 426	CHATHAM	VA	24531
115 PRUDEN ST	VACANT COTTAGE					
4 PRUDEN ST	AUBREY JOHNSON	AUBREY JOHNSON	P O BOX 637	CHATHAM	VA	24531
6 PRUDEN ST	AUBREY JOHNSON	AUBREY JOHNSON	"	"	"	"
8 PRUDEN ST	AUBREY JOHNSON	AUBREY JOHNSON	"	"	"	"
14 PRUDEN ST						
32 PRUDEN ST	CHATHAM ANIMAL	BRUCE BURKETTE	P O BOX 1113	CHATHAM	VA	24531
34 PRUDEN ST	CHATHAM ANIMAL	BRUCE BURKETTE	"	"	"	"
40 PRUDEN ST						
102 PRUDEN ST	CALVIN YOUNGER		P O BOX 779	CHATHAM	VA	24531
104 PRUDEN ST	GEARLDINE WILSON		P O BOX 965	CHATHAM	VA	24531
108 PRUDEN ST						
114 PRUDEN ST						
120 PRUDEN ST	ICE PLANT					
25 REID ST	W C WHITEHEAD		P O BOX 310	CHATHAM	VA	24531
101 REID ST	C DEV CORP		3744 HIGHWAY 29 N	DANVILLE	VA	?
107 REID ST	JEAN REYNOLDS		P O BOX 304	CHATHAM	VA	24531
111 REID ST	DANNY BARKER		P O BOX 822	CHATHAM	VA	24531
117 REID ST	T BRUNING		P O BOX 905	CHATHAM	VA	24531
121 REID ST	B DAVENPORT		P O BOX 879	CHATHAM	VA	24531
125 REID ST						
135 REID ST	SAM HAIRSTON		P O BOX 694	CHATHAM	VA	24531
141 REID ST	STEVE ADKINS		141 REID ST	CHATHAM	VA	24531
161 REID ST	CORINTH CHRISTIAN CH		161 REID ST	CHATHAM	VA	24531
102 REID ST		DAVENPORT RENTALS	P O BOX 1069	CHATHAM	VA	24531
104 REID ST	MAY EARLS	L ELTON PRUITT	P O BOX 1028	CHATHAM	VA	24531
106 REID ST		PITTS. CO FARM BUREAU	P O BOX 1009	CHATHAM	VA	24531
108 REID ST						
114 REID ST		BEN DAVENPORT	P O BOX 879	CHATHAM	VA	24531
118 REID ST		DANNY MILLS	118 REID ST	CHATHAM	VA	24531
122 REID ST		FRANK ANDREWS	122 REID ST	CHATHAM	VA	24531

United States Department of the Interior
National Park Service

National Register of Historic Places
Continuation Sheet

Chatham Historic District
Chatham, Virginia

Section Adjacent Property Owners Page 72

ADJACENT PROPERTY OWNERS

FRANCIS C. TAYLOR	312 MILITARY DR	CHATHAM	VA	24531
HARGROVE MILITARY ACAD	200 MILITARY DR	CHATHAM	VA	24531
CLIFTON J. SANDERS	PO BOX 796	CHATHAM	VA	24531
ANN M. REYNOLDS	16 HARGRAVE BLVD	CHATHAM	VA	24531
PATTIE ROGERS MOTLEY	PO BOX 163	CHATHAM	VA	24531
LEO STEVEN CREASY	PO BOX 143	CHATHAM	VA	24531
EUNICE G. FULCHER	PO BOX 21	CHATHAM	VA	24531
MELVIN L. EMERSON	PO BOX 181	CHATHAM	VA	24531
FRANCES DAWN PYRTLE	106 HUNT ST	CHATHAM	VA	24531
JOHN B & LILA J GRUBB	PO BOX 222	CHATHAM	VA	24531
CORDIE L PITTMON TERRY	103 HUNT ST	CHATHAM	VA	24531
LAWRENCE D/MARY JESSIE	PO BOX 1044	CHATHAM	VA	24531
PITTSYLVANIA COUNTY	PO BOX 426	CHATHAM	VA	24531
KENYON SCOTT	115 WHITTLE ST	CHATHAM	VA	24531
MARY E LOGAN	38 WHITTLE ST	CHATHAM	VA	24531
ELIZABETH LYNN CRIDER KNIGHTON	PO DRAWER H	CHATHAM	VA	24531
ALVIN RHAE CRIDER				
JOHN HAYWOOD CRIDER				
JOSEPH L/BUNNY DAMERON	114 WHITTLE	CHATHAM	VA	24531
CHATHAM'S SQUARE INC	PO BOX 1069	CHATHAM	VA	24531
CHRISTINE W MAACK	3522 ALEXANDER AVE	ANCHORAGE	AK	99508
MARY WILMA WORLEY ABBOTT	169 TAMWORTH DR	DANVILLE	VA	24540
CORINTH CHRISTIAN CHURCH	PO BOX 1074	CHATHAM	VA	24531
DAVID E HUTCHERSON	2424 AFTON RD	DANVILLE	VA	24540
LANGHORNE JONES JR	PPO BOX 1086	CHATHAM	VA	24531
CHATHAM HALL	800 CHATHAM HALL	CHATHAM	VA	24531
COUNTY SCHOOL BOARD	PO BOX 232	CHATHAM	VA	24531
OF PITTSYLVANIA COUNTY				
AUBREY G JOHNSON	PO BOX 637	CHATHAM	VA	24531
JERRY WYATT	PO BOX 645	CHATHAM	VA	24531
ELTON J TOLER	PO BOX 112	CHATHAM	VA	24531
MARY BRYANT TOLER				
DOROTHY H. BENNETT	PO BOX 687	CHATHAM	VA	24531
EARL ALLEN HEDRICK	124 HEDRICK DR	CHATHAM	VA	24531
BRILEY ANN HEDRICK				
MARTHA S SCEARCE	170 HURT ST	CHATHAM	VA	24531
ROBERT L/SANDRA GILBERT	PO BOX 431	CHATHAM	VA	24531
JOHN P/ALLENE O HUNT III	108 MILITARY RD	CHATHAM	VA	24531
SUDIE JONES	PO BOX 95	CHATHAM	VA	24531
C/O JAMES D. JONES				
JAMES I WOMACK	292 HALIFAX RD	CHATHAM	VA	24531
LOIS R DAVENPORT	PO BOX 879	CHATHAM	VA	24531

United States Department of the Interior
National Park Service

National Register of Historic Places
Continuation Sheet

Chatham Historic District
Chatham, Virginia

Section Adjacent Property Owners Page 73

KENNETH LEE GEYER	232 HILL'S DALE FARM RD	CHATHAM	VA	24531
KATHRYN E GEYER				
WILLIAM HENRY LEE JR	329 HICKORY RD	CHATHAM	VA	24531
LILLIE R LEE				
ELIZABETH N DAVENPORT	PO BOX 1069	CHATHAM	VA	24531
HANSFORD CHATTIN	PO BOX 644	CHATHAM	VA	24531
KATHERINE CHATTIN				
CHARLIE / SARAH CHATTIN	PO BOX 644	CHATHAM	VA	24531
CHARLIE / VIVIAN CHATTIN JR	PO BOX 644	CHATHAM	VA	24531
HETTIE R JAMERSON	PO BOX 644	CHATHAM	VA	24531
DOUGLAS JAMERSON				
RICHARD / NANSY WATSON	PO BOX 1075	CHATHAM	VA	24531
THOMAS JONES	15 CHESNUT PL	MT VERNON	NY	10550
JAMES DAVID JONES JR	PO BOX 95	CHATHAM	VA	24531
NANCY MARSTON HAYES				
W CARRINGTON THOMPSON	501 S MAIN ST	CHATHAM	VA	24531
MARSH MONTAGUE MARSHALL	PO BOX 1211 CHA	CHATHAM	VA	24531
HENRY G/TONYA CRIDER	PO BOX 8	CHATHAM	VA	24531
ERIC WILSON ROBERTS	53 LANIER AVE	CHATHAM	VA	24531
REBECCA READ BURK				
TERRY H ANDREWS	PO BOX 148	CHATHAM	VA	24531
LENA T BARKER	BOX 51	CHATHAM	VA	24531
RUFUS RAMSEY TOLER	PO BOX 701	CHATHAM	VA	24531
ETTA S TOLER				
ELIZABETH W WHITEHEAD	PO BOX 1213	CHATHAM	VA	24531
DANIEL H SHELHORSE	PO BOX 433	CHATHAM	VA	24531
BETTY M SHELHORSE				
EDDIES SUPER MARKET INC	PO BOX 30	CHATHAM	VA	24531
VIRGINIA M JOHNSON	PO COX 97	CHATHAM	VA	24531

CHATHAM QUADRANGLE
VIRGINIA - PITTSYLVANIA CO.
7.5 MINUTE SERIES (TOPOGRAPHIC)

5157 IV NE
(GRETN)

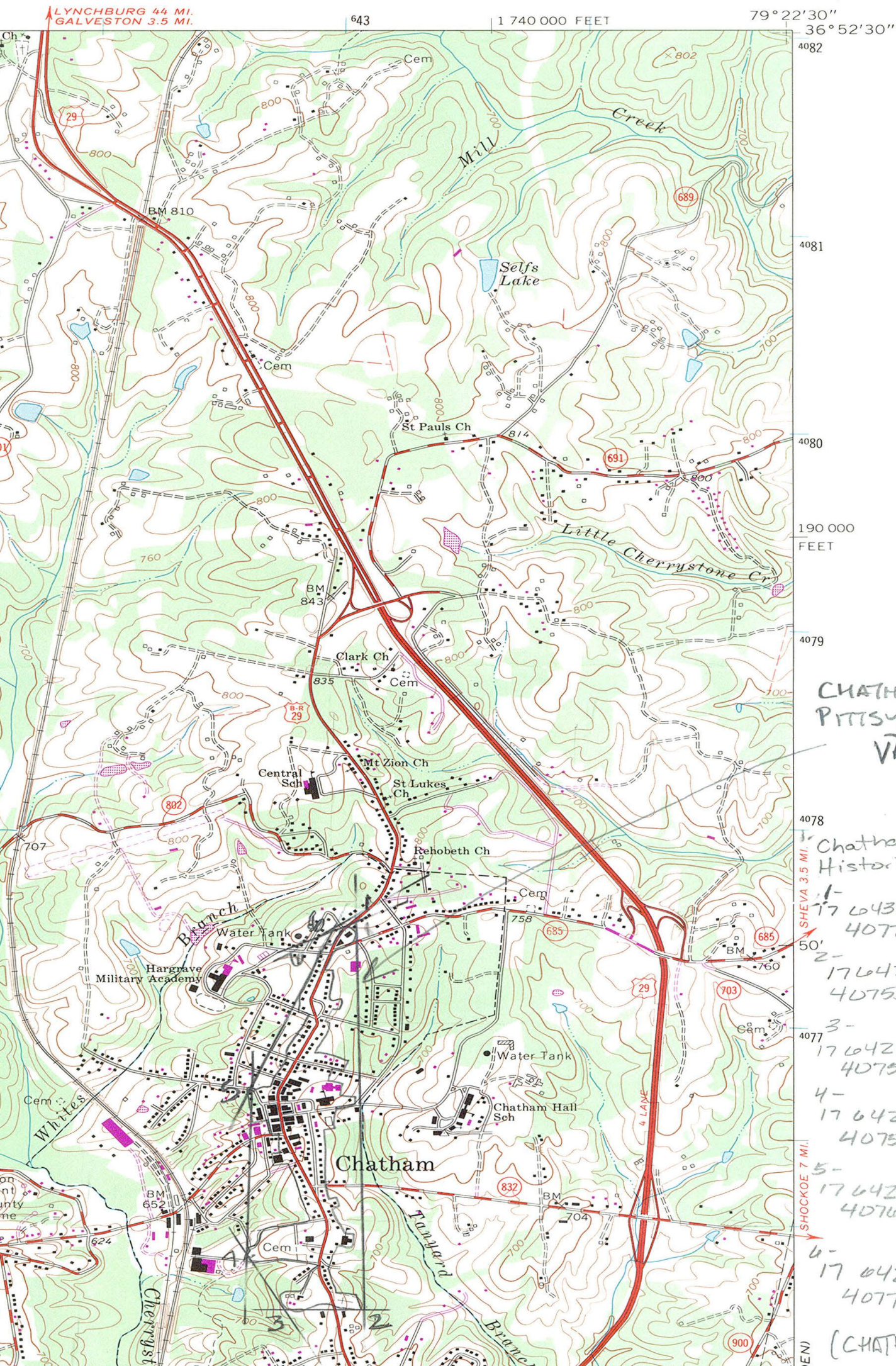

CHATHAM
PITTSYLVANIA CO.
VA

Chatham
Historic District

1-
17 643110
4077540

2-
17 643170
4075540

3-
17 642850
4075340

4-
17 642680
4075800

5-
17 642660
4076660

6-
17 642960
4077420

7-
17 642960
4077420

8-
17 642960
4077420

(CHATHAM QUAD)

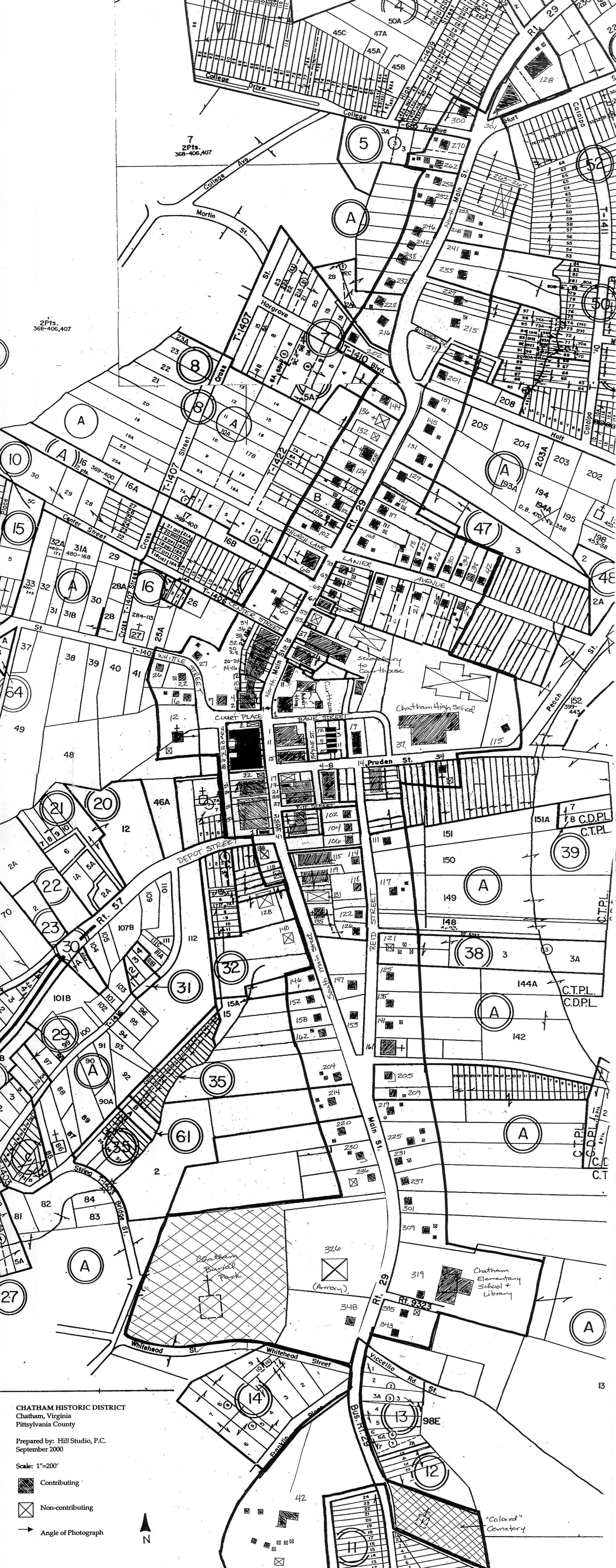

CHATHAM HISTORIC DISTRICT
Chatham, Virginia
Pittsylvania County

Prepared by: Hill Studio, P.C.
September 2000

Scale: 1"=200'

- Contributing
- Non-contributing
- Angle of Photograph

